

Sea-Dog Aluminum Vertical Switch Panel #422010-1 Installation Instructions

12 VOLT 10 Amps Maximum Per Circuit 30 Amps Maximum Per Panel 4 ILLUMINATING SWITCHES O.D.: 4-7/8" x 4-1/2"

1. Connect the positive terminal of the battery (12V only) to the bar identified with a "+" tag.
2. Connect the negative terminal of the battery (or ground) to the bar identified with a "-" tag.
3. Connect the positive wire of each individual circuit to the #2 spade on the corresponding rocker switch on the panel.
4. Connect the remaining wire or negative wire of each circuit to the common ground of the boat, if so equipped, or directly to the negative terminal of the battery or the negative bar of the panel. **NOTE:** Do not attach any additional wires to the remaining terminal on the fuse holder.
5. Your Sea-Dog switch panel is supplied with 8 fuses: (2) 3A, (4) 5A and (2) 10A. (**WARNING:** Do not use fuse rated over 10A).
6. To remove the fuse holder cap, see [fig. 2](#) below.

FIG. 1

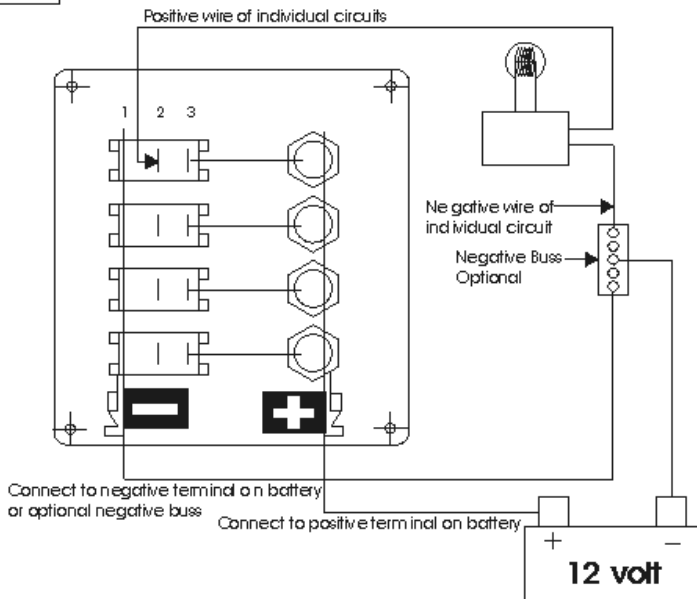
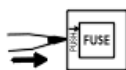

FIG. 2



"PUSH" indicates slot in the fuse holder body



Insert a ball point pen or small screwdriver in the slot. Press toward fuse holder. CAUTION: FUSE POPS UP. Cover fuse cap with hand or finger. NOTE: Do not pry up fuse holder. You will break the fuse holder bracket.



Cap pops out. Insert or remove fuse, then snap cap back to position.

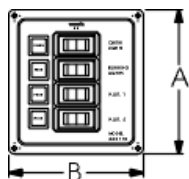

A - 4-7/8"
B - 4-1/2"

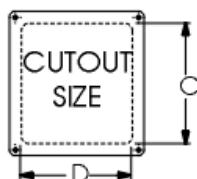

C - 3-15/16"
D - 3-1/2"