

SEADOG[®] LINE

QUALITY MARINE GEAR



2025 SUPPLEMENT

Sea-Dog does not sell to the general public – we only sell to boat builders and wholesalers. For information on how to purchase our products, visit the "Where to Buy" page on our website.

Back Cover Explained

Why did we choose the Port of Everett to feature on our back cover? For 100 years, Sea-Dog Line has been located in Snohomish County, Washington State, with over 60 years in Everett, WA. Established as a main hub for logging and industry, the addition of the Northern Railroad Line solidified Everett's standing as a major commercial hub. Everett is home to Boeing's Paine Field Plant, the largest building in the world by volume. The Port of Everett is the largest public marina on the west coast of the United States and the waterfront is also home to Naval Station Everett, homeport for the US Navy Carrier Strike Group.

From humble beginnings in Eldon's basement to the current 120,000+ sq/ft campus, Everett has played an important role in the evolution of Sea-Dog Line and the Nysether family. Eldon raised his two sons, Mark and Brad, in the business and while growing up, they worked right alongside their father. After finishing college, both Mark and Brad returned to the family business to continue the legacy.

One of the benefits of legacy is continuity, but it also fosters innovation. Jasper Nysether, Mark's oldest son, has been at the helm of our ship since 2022. You can expect Sea-Dog to continue to be an industry leader in quality and reliability while growing and expanding our product offerings in new and exciting ways readily visible throughout this supplement. With the ongoing support from you, our valued customers, and having third- and fourth-generation family active, Sea-Dog line is looking forward to a great future.



-1s, -3s, & -9s

Items available in retail display packaging are identified with a -1, -3, and -9 after the Sea-Dog part number. More specifically:

- 1 Hanging card, bagged with header card, or in a clamshell
- 3 Full color box
- 9 Kit which includes hardware

Why are Proposition 65 warnings in our Sea-Dog catalog?

We at Sea-Dog strive to do the right thing as a responsible manufacturer. No changes have been made to our products that have been in our catalog for years. Even though the Prop 65 label is a California only requirement, Sea-Dog Line, out of an abundance of caution, is labeling all Prop 65 items regardless of their intended destination. As part of California's Right to Know, you will see Prop 65 warnings on some of our product packaging, in our catalog, and on our web site.

Prop 65 was enacted in 1986 for California only. Its intent was to protect drinking water sources from being contaminated with chemicals known to cause cancer, birth defects, or other reproductive harm. Since its inception, it has grown to include approximately 1000 chemicals, many of which are found in common household items.

Labeled products for Sea-Dog predominantly fall into three categories as pertains to Prop 65: Those containing brass, those with a galvanized finish, or those containing PVC. All brass contains lead, as does galvanizing solution. PVC, commonly used in wiring products, contains vinyl chloride and phthalates. All of these substances are listed as chemicals known to the state of California to cause cancer or reproductive toxicity.

For additional information on Prop 65 visit: www.P65Warnings.ca.gov

We're moving cleat technology forward



Introducing the
Linear Folding Cleat

Snaps flush with
a satisfying click



Unique hardware slot
accommodates any length
of carriage bolt and holds
it for easy installation

SEADOG[®]LINE
QUALITY MARINE GEAR

LINEAR FOLDING CLEAT

The new Linear Folding Cleat is our sleekest cleat yet, but we've still packed it with features.

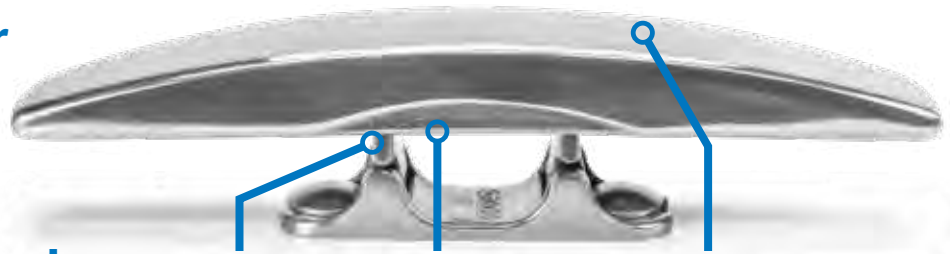

Spring lock
Snaps open and closed

Self-draining
No need for drain holes, unlike Pull-Up Cleat

Slim design
Minimalist design is less than 1" high when folded

Carriage bolt holder & lock

Unique bolt holder allows you to choose the mounting hardware that best suits your needs. It then locks in place.

Bi-directional installation

Easily handles linear loads by installing with folding mechanism to fore or aft.



LINEAR FOLDING CLEAT

Investment Cast 316 Stainless Steel

PATENT PENDING

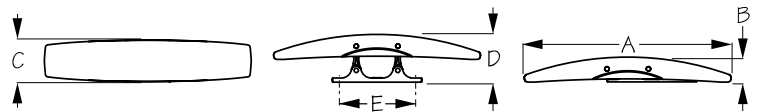

Bulk	Display	A	B	C	D	E	Fastener	Finish	Wt.(lb.)	Std. Pack
041171	n/a	7-1/2"	7/8"	1-1/2"	1-3/4"	2-3/8"	5/16" Carriage Bolt	Mirror Polished	.95	10 ea

The Linear Folding Cleat features an innovative design incorporating removable carriage bolts vs. welded studs, making bolt length choices easy for the customer. The streamlined appearance is both sleek and functional. There is no need for a large custom cut out installation hole. Drill 2 - 5/16" fastener holes, place chosen length carriage bolts into end slots, then close the cleat to hold fastener in rigging position for installation. Water and debris pass through, reducing corrosion and wear to cleat. Incorporates a positive snap locking feature, simply pull-up to open and press down to close. Accommodates up to 1/2" line. Low profile ergonomic design makes for smooth, sleek appearance when closed limiting trip hazards. Constructed of corrosion resistant investment cast 316 stainless steel. Patent Pending.



RECESSED ANCHOR POINT / HORIZONTAL

Investment Cast 316 Stainless Steel

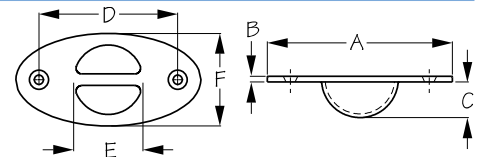

Bulk	Display	A	B	C	D	E	F	Fastener	Wt.(lb.)	Std. Pack
076102	076102-1	4"	1/8"	3/4"	3"	1-1/2"	2"	#10 FH	.23	5 ea

This Horizontal Recessed Anchor Point is designed to conveniently secure loads or attach tie-downs, cargo netting, twine, or rope. Good for light equipment use. Bolts securely and lays flush to the surface. Constructed of corrosion resistant investment cast 316 stainless steel. Installs with two #10 FH fasteners (not included).





Introducing **DAMPENING HINGES**

We're expanding our popular hinge lineup with a range featuring an all-new patent-pending slow-close mechanism to provide an extra-premium feel. Available in a wide variety of styles and sizes for both interior and exterior applications.

NEW
**Ultra-smooth
soft-close action**
with patent-pending
Teflon-coated pin

Durable
Corrosion-resistant
304 stainless steel



Anti-rattle
Precise, low-friction movement
for minimal rattle



DAMPENING BUTT HINGE

Stamped 304 Stainless Steel

PATENT PENDING

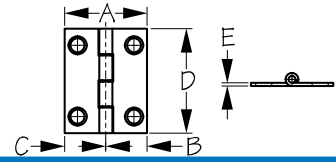

Bulk	Display	A	B	C	D	E	Fastener	Wt.(lb.)	Std. Pack
203070	203070-1	1-1/4"	5/8"	5/8"	1-1/2"	1/16"	#8 FH	.03 / .06	10 ea / 10 pr
203071	203071-1	1-1/2"	3/4"	3/4"	2"	1/16"	#8 FH	.06 / .12	10 ea / 10 pr
203072	203072-1	2"	1"	1"	2"	1/16"	#8 FH	.07 / .14	10 ea / 10 pr

These Dampening Butt Hinges consist of two rectangular leaves with a Teflon coated pin that produces a very precise, low friction movement for a very high end feel with anti-rattle properties. Designed to attach to abutting surfaces of a door and door jamb or to be mortised for a flush installation. Constructed of corrosion resistant stamped 304 stainless steel. Installs with four #8 FH fasteners (not included). Patent Pending.

⚠️WARNING: Cancer and Reproductive Harm - www.P65Warnings.ca.gov



DAMPENING BUTT HINGE

Stamped 304 Stainless Steel

PATENT PENDING

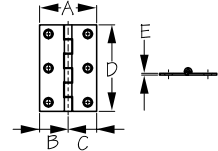

Bulk	Display	A	B	C	D	E	Fastener	Wt.(lb.)	Std. Pack
203080	203080-1	2"	1"	1"	3"	1/16"	#8 FH	.11 / .22	10 ea / 10 pr
203081	203081-1	3"	1-1/2"	1-1/2"	3"	1/16"	#8 FH	.16 / .32	10 ea / 10 pr

These Dampening Butt Hinges consist of two rectangular leaves with a Teflon coated pin that produces a very precise, low friction movement for a very high end feel with anti-rattle properties. Designed to attach to abutting surfaces of a door and door jamb or to be mortised for a flush installation. Constructed of corrosion resistant stamped 304 stainless steel. Installs with six #8 FH fasteners (not included). Patent Pending.

⚠️WARNING: Cancer and Reproductive Harm - www.P65Warnings.ca.gov



DAMPENING SHORT SIDE DOOR HINGE

Stamped 304 Stainless Steel

PATENT PENDING

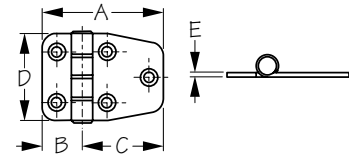

Bulk	Display	A	B	C	D	E	Fastener	Wt.(lb.)	Std. Pack
203510	203510-1	2-1/8"	11/16"	1-7/16"	1-1/2"	1/16"	#8 FH	.09 / .18	10 ea / 10 pr

These Dampening Short Side Door Hinges consist of two leaves with a Teflon coated pin that produces a very precise, low friction movement for a very high end feel with anti-rattle properties, great for interior and exterior applications such as cabinets, hatches, folding tables, or seats where mounting space is tight. Constructed of corrosion resistant stamped 304 stainless steel. Installs with five #8 FH fasteners (not included). Patent Pending.

⚠️WARNING: Cancer and Reproductive Harm - www.P65Warnings.ca.gov



DAMPENING OFFSET SHORT SIDE DOOR HINGE

Stamped 304 Stainless Steel

PATENT PENDING

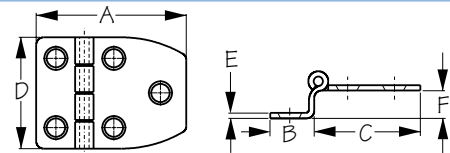

Bulk	Display	A	B	C	D	E	F	Fastener	Wt.(lb.)	Std. Pack
203512	203512-1	2-1/8"	5/8"	1-3/8"	1-1/2"	1/16"	3/8"	#8 FH	.10 / .20	10 ea / 10 pr

These Dampening Offset Short Side Door Hinges consist of two leaves with a Teflon coated pin that produces a very precise, low friction movement for a very high end feel with anti-rattle properties, great for interior and exterior applications such as cabinets, hatches, folding tables, or seats where mounting space is tight. Constructed of corrosion resistant stamped 304 stainless steel. Installs with five #8 FH fasteners (not included). Patent Pending.

⚠️WARNING: Cancer and Reproductive Harm - www.P65Warnings.ca.gov

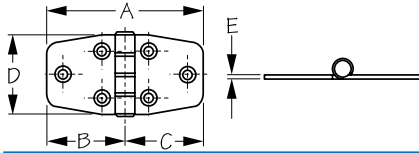

DAMPENING DOOR HINGE

Stamped 304 Stainless Steel

PATENT PENDING



Bulk	Display	A	B	C	D	E	Fastener	Wt.(lb.)	Std. Pack
203530	203530-1	2-7/8"	1-7/16"	1-7/16"	1-1/2"	1/16"	#8 FH	.11 / .22	10 ea / 10 pr

These Dampening Door Hinges consist of two leaves with a Teflon coated pin that produces a very precise, low friction movement for a very high end feel with anti-rattle properties, great for interior and exterior applications such as cabinets, hatches, folding tables, or seats where mounting space is tight. Constructed of corrosion resistant stamped 304 stainless steel. Installs with six #8 FH fasteners (not included). Patent Pending.

▲WARNING: Cancer and Reproductive Harm - www.P65Warnings.ca.gov

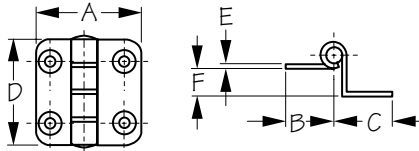

DAMPENING OFFSET BUTT HINGE

Stamped 304 Stainless Steel

PATENT PENDING



Bulk	Display	A	B	C	D	E	F	Fastener	Wt.(lb.)	Std. Pack
203590	203590-1	1-1/2"	3/4"	3/4"	1-1/2"	1/16"	3/8"	#8 FH	.09 / .18	10 ea / 10 pr

These Dampening Offset Butt Hinges consist of two leaves with a Teflon coated pin that produces a very precise, low friction movement for a very high end feel with anti-rattle properties, designed to be mounted on the front surface of a raised door with a 3/8" offset on one side. Constructed of corrosion resistant stamped 304 stainless steel. Installs with four #8 FH fasteners (not included). Patent Pending.

▲WARNING: Cancer and Reproductive Harm - www.P65Warnings.ca.gov

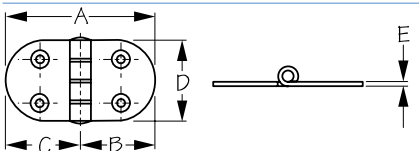

DAMPENING ROUND SIDE DOOR HINGE - SHORT

Stamped 304 Stainless Steel

PATENT PENDING



Bulk	Display	A	B	C	D	E	Fastener	Wt.(lb.)	Std. Pack
203700	203700-1	2-13/16"	1-7/16"	1-7/16"	1-1/2"	1/16"	#8 FH	.12 / .24	10 ea / 10 pr

These Dampening Short Round Side Door Hinges consist of two leaves with a Teflon coated pin that produces a very precise, low friction movement for a very high end feel with anti-rattle properties, great for interior and exterior applications such as cabinets, hatches, folding tables, or seats where mounting space is tight. Constructed of corrosion resistant stamped 304 stainless steel. Installs with four #8 FH fasteners (not included). Patent Pending.

▲WARNING: Cancer and Reproductive Harm - www.P65Warnings.ca.gov

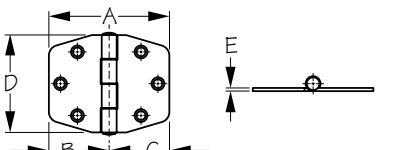

DAMPENING HEAVY DUTY HINGE

Stamped 304 Stainless Steel

PATENT PENDING



Bulk	Display	A	B	C	D	E	Fastener	Wt.(lb.)	Std. Pack
203801	203801-1	2-7/8"	1-7/16"	1-7/16"	2-15/16"	1/16"	#8 FH	.22 / .44	10 ea / 10 pr

These Dampening Heavy Duty Hinges consist of two leaves with a Teflon coated pin that produces a very precise, low friction movement for a very high end feel with anti-rattle properties, great for interior and exterior applications such as cabinets, hatches, folding tables, or seats where mounting space is tight. Constructed of corrosion resistant stamped 304 stainless steel. Installs with six #8 FH fasteners (not included). Patent Pending.

▲WARNING: Cancer and Reproductive Harm - www.P65Warnings.ca.gov

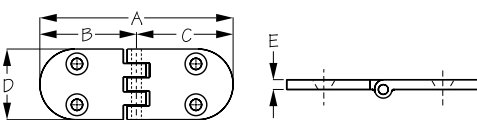

FLUSH ROUND DOOR HINGE

Investment Cast 316 Stainless Steel



Bulk	Display	A	B	C	D	E	Fastener	Wt.(lb.)	Std. Pack
205461	205461-1	3-1/4"	1-5/8"	1-5/8"	1-3/16"	3/16"	#10 FH	.16 / .32	10 ea / 10 pr

This Flush Door Hinge features a knuckle that sits below the mounting surface, creating a smooth, flat design perfect for deck surfaces or where lines might snag. In door applications, they fit flush with the frame and are completely invisible in the closed position giving cabinet fronts a sleek, clean look. 100° degrees of motion. Ideal for recessed deck hatches or lids. Constructed of corrosion resistant investment cast 316 stainless steel. Installs with four #10 FH fasteners (not included).

STUD MOUNT HANDRAIL

Formed 304 Stainless Steel

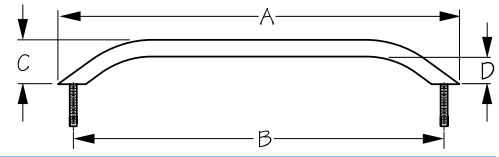

Bulk	Display	A	B	C	D	Finish	Tube O.D.	Fastener	Wt.(lb.)	Std. Pack
254601	254601-1	8-3/4"	7-1/2"	1-3/4"	1-1/4"	Stainless	3/4"	5/16"-18 Nut	.33	5 ea
254603	254603-1	12"	10-3/4"	2"	1-1/4"	Stainless	3/4"	5/16"-18 Nut	.46	5 ea
254607	254607-1	18-1/2"	16-3/4"	2"	1-1/4"	Stainless	3/4"	5/16"-18 Nut	.64	5 ea
254609	254609-1	24"	22-1/2"	2"	1-1/4"	Stainless	3/4"	5/16"-18 Nut	.80	5 ea
254611	254611-1	8-3/4"	7-1/2"	1-3/4"	1-1/4"	Black Matte	3/4"	5/16"-18 Nut	.33	5 ea
254613	254613-1	12"	10-3/4"	2"	1-1/4"	Black Matte	3/4"	5/16"-18 Nut	.46	5 ea
254617	254617-1	18-1/2"	16-3/4"	2"	1-1/4"	Black Matte	3/4"	5/16"-18 Nut	.64	5 ea
254619	254619-1	24"	22-1/2"	2"	1-1/4"	Black Matte	3/4"	5/16"-18 Nut	.80	5 ea

These Stud Mounted Handrails are designed to provide a sleek, smooth handrail transition to the mounting surface of your boat. Functional and attractive, with no visible mounting hardware. Features integral 5/16"-18 x 1-15/16" threaded studs. Constructed of corrosion resistant formed 304 stainless steel also available in black matte finish. Installs with two 5/16"-18 nuts (included).

STUD MOUNT FLANGED HANDRAIL

Formed 304 Stainless Steel

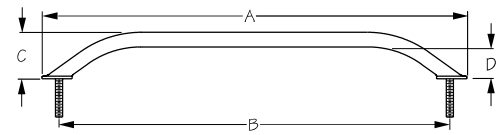

Bulk	Display	A	B	C	D	Finish	Tube O.D.	Fastener	Wt.(lb.)	Std. Pack
254620	254620-1	10"	8-3/4"	2-1/4"	1-1/2"	Stainless	7/8"	5/16"-18 Nut	.44	5 ea
254622	254622-1	13-1/2"	12"	2-1/4"	1-1/2"	Stainless	7/8"	5/16"-18 Nut	.53	5 ea
254626	254626-1	19-3/8"	18"	2-1/4"	1-1/2"	Stainless	7/8"	5/16"-18 Nut	.70	5 ea
254628	254628-1	25-1/4"	24-1/4"	2-1/4"	1-1/2"	Stainless	7/8"	5/16"-18 Nut	.76	5 ea
254630	254630-1	10"	8-3/4"	2-1/4"	1-1/2"	Black Matte	7/8"	5/16"-18 Nut	.44	5 ea
254632	254632-1	13-1/2"	12"	2-1/4"	1-1/2"	Black Matte	7/8"	5/16"-18 Nut	.53	5 ea
254636	254636-1	19-3/8"	18"	2-1/4"	1-1/2"	Black Matte	7/8"	5/16"-18 Nut	.70	5 ea
254638	254638-1	25-1/4"	24-1/4"	2-1/4"	1-1/2"	Black Matte	7/8"	5/16"-18 Nut	.76	5 ea

These Stud Mounted Flanged Handrails provide a larger mounting surface for greater stability. Functional and attractive, with no visible mounting hardware. Features integral 5/16"-18 x 1-5/8" threaded studs. Constructed of corrosion resistant formed 304 stainless steel also available in black matte finish. Installs with two 5/16"-18 nuts (included).



ELONGATED DECK HINGE

Injection Molded Nylon

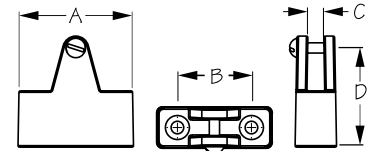

Bulk	Display	A	B	C	D	Pin Size	Pin/Screw Part #	Fastener	Wt.(lb.)	Std. Pack
273202	n/a	2-7/16"	1-9/16"	5/16"	2-1/8"	3/16"	0P27301	#10 FH	.08	10 ea

The Elongated Deck Hinge base is raised 1" higher than typical deck hinges for custom applications.



LOW PROFILE POP-OUT DECK PLATE

Injection Molded Polypropylene

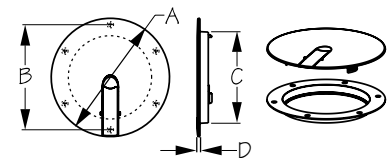

Bulk	Display	A	B	C	D	Color	Fastener	Wt.(lb.)	Std. Pack
336410	336410-1	6"	5-1/4"	4-1/8"	3/16"	White	#8 FH	.28	10 ea
336411	336411-1	6"	5-1/4"	4-1/8"	3/16"	Black	#8 FH	.28	10 ea
336412	336412-1	8"	7-1/4"	6-1/4"	3/16"	White	#8 FH	.58	10 ea
336413	336413-1	8"	7-1/4"	6-1/4"	3/16"	Black	#8 FH	.58	10 ea

The Low Profile Pop-Out Deck Plate features an integrated, pop-up lever to make opening and closing a snap. The concealed fasteners give a smooth look with a very low profile (.1875"), this deck plate is great for tight places and high traffic areas. Rubber O-ring provides a watertight seal and three tab snap provides a secure fit. Constructed of UV resistant injection molded Polypropylene for its structural strength, as well as weather and corrosion resistance. Installs with six #8 FH fasteners (not included). Available in black or white.



⚠WARNING: Cancer and Reproductive Harm - www.P65Warnings.ca.gov



LED UNDER CABINET LIGHT

Injection Molded Nylon/Aluminum



Bulk	Display	A	B	C	Lumens	LED Color	Fastener	Wt.(lb.)	Std. Pack
n/a	400600-3	1"	6-1/2"	9/16"	180	Warm White/3000K	#8 RH	.17	5 ea
n/a	400603-3	1"	14-1/2"	9/16"	540	Warm White/3000K	#8 RH	.24	5 ea
n/a	400604-3	1"	22-1/2"	9/16"	900	Warm White/3000K	#8 RH	.36	5 ea

The LED Under Cabinet Light can be mounted on any cabinet, locker, or other location where lighting is needed. Features warm white LEDs. Installs with two #8 Fasteners included.

⚠WARNING: Cancer and Reproductive Harm - www.P65Warnings.ca.gov

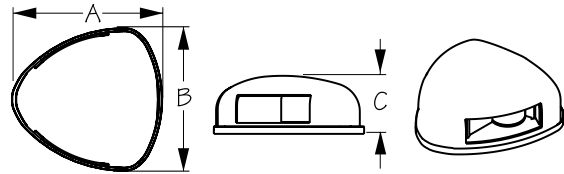

LED COMBINATION BOW LIGHT

Stamped 304 Stainless/Injection Molded ABS



Bulk	Display	A	B	C	Volts	ABYC C-5/A-16	Finish	Fastener	Wt.(lb.)	Std. Pack
401080	n/a	2-3/16"	2"	1"	12	Yes	Stainless	#8 RH	.25	1 ea
401081	n/a	2-3/16"	2"	1"	12	Yes	Black	#8 RH	.25	1 ea

LED Combination Bow lights available with Stainless or Black covers, Installs with three #8 RH fasteners (not included). IP67 waterproof rating. 2 NM, ABYC C-5/A-16 Compliant.

• Custom cover colors available on large volume orders

⚠WARNING: Cancer and Reproductive Harm - www.P65Warnings.ca.gov

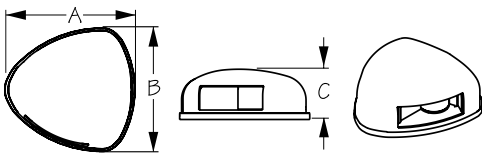

LED TOP MOUNT SIDE LIGHT

Stamped 304 Stainless/Injection Molded ABS



Bulk	Display	A	B	C	Volts	ABYC C-5/A-16	Finish	Fastener	Wt.(lb.)	Std. Pack
401087	n/a	2-3/16"	2"	1"	12	Yes	Stainless	#8 RH	.50	1 pr
401088	n/a	2-3/16"	2"	1"	12	Yes	Black	#8 RH	.50	1 pr

LED Top Mount Side lights available with Stainless or Black covers, Installs with two #8 RH fasteners (not included). IP67 waterproof rating. 2 NM, ABYC C-5/A-16 Compliant.

• Custom cover colors available on large volume orders

⚠WARNING: Cancer and Reproductive Harm - www.P65Warnings.ca.gov

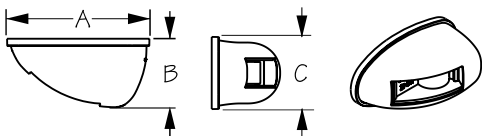

LED SIDE MOUNT SIDE LIGHT

Stamped 304 Stainless/Injection Molded ABS



Bulk	Display	A	B	C	Volts	ABYC C-5/A-16	Finish	Fastener	Wt.(lb.)	Std. Pack
401091	n/a	2-3/16"	1"	1"	12	Yes	Stainless	#8 RH	.50	1 pr
401092	n/a	2-3/16"	1"	1"	12	Yes	Black	#8 RH	.50	1 pr

LED Side Mount Lights available with Stainless or Black covers, Installs with two #8 RH fasteners (not included). IP67 waterproof rating. 2 NM, ABYC C-5/A-16 Compliant.

• Custom cover colors available on large volume orders

⚠WARNING: Cancer and Reproductive Harm - www.P65Warnings.ca.gov



HI-AMP SURFACE-MOUNT RESETTABLE CIRCUIT BREAKER

Stainless Steel Studs and Washers/Thermoset Plastic

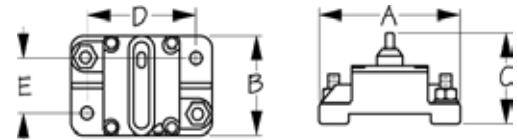

Bulk	Display	Amps	A	B	C	D	E	Volts	Wt.(lb.)	Std. Pack
420870	420870-1	25	2-7/8"	1-7/8"	1-3/4"	2-3/16"	1-1/16"	48	.23	10 ea
420871	420871-1	30	2-7/8"	1-7/8"	1-3/4"	2-3/16"	1-1/16"	48	.23	10 ea
420872	420872-1	40	2-7/8"	1-7/8"	1-3/4"	2-3/16"	1-1/16"	48	.23	10 ea
420873	420873-1	50	2-7/8"	1-7/8"	1-3/4"	2-3/16"	1-1/16"	48	.23	10 ea
420874	420874-1	60	2-7/8"	1-7/8"	1-3/4"	2-3/16"	1-1/16"	48	.23	10 ea
420875	420875-1	70	2-7/8"	1-7/8"	1-3/4"	2-3/16"	1-1/16"	48	.23	10 ea
420876	420876-1	80	2-7/8"	1-7/8"	1-3/4"	2-3/16"	1-1/16"	48	.23	10 ea
420877	420877-1	100	2-7/8"	1-7/8"	1-3/4"	2-3/16"	1-1/16"	48	.23	10 ea
420878	420878-1	120	2-7/8"	1-7/8"	1-3/4"	2-3/16"	1-1/16"	48	.23	10 ea
420879	420879-1	150	2-7/8"	1-7/8"	1-3/4"	2-3/16"	1-1/16"	48	.23	10 ea

These Hi-Amp Resettable Circuit Breakers provide a visible indication of tripped condition. Single pole thermal type breaker they have a voltage rating of 48VDC and an interrupt level of 3000 amperes. Surface mounted, a mounting panel is not required. Water resistant and sealed for engine compartment and bilge area applications. Constructed of Thermoset plastic with stainless steel studs and washers. CE certified.

⚠WARNING: Cancer and Reproductive Harm - www.P65Warnings.ca.gov

HI-AMP PANEL-MOUNT RESETTABLE CIRCUIT BREAKER

Stainless Steel Studs & Washers/Thermoset Plastic

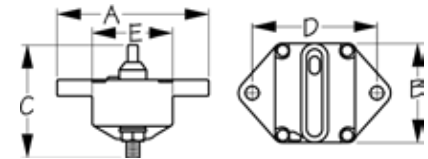

Bulk	Display	Amps	A	B	C	D	E	Volts	Wt.(lb.)	Std. Pack	
420880	420880-1	25	2-15/16"	1-15/16"	2-1/8"	2-7/16"	1-9/16"	48	.18	10 ea	
420881	420881-1	30	2-15/16"	1-15/16"	2-1/8"	2-7/16"	1-9/16"	48	.18	10 ea	
420882	420882-1	40	2-15/16"	1-15/16"	2-1/8"	2-7/16"	1-9/16"	48	.18	10 ea	
420883	420883-1	50	2-15/16"	1-15/16"	2-1/8"	2-7/16"	1-9/16"	48	.18	10 ea	
420884	420884-1	60	2-15/16"	1-15/16"	2-1/8"	2-7/16"	1-9/16"	48	.18	10 ea	
420885	420885-1	70	2-15/16"	1-15/16"	2-1/8"	2-7/16"	1-9/16"	48	.18	10 ea	
420886	420886-1	80	2-15/16"	1-15/16"	2-1/8"	2-7/16"	1-9/16"	48	.18	10 ea	
420887	420887-1	100	2-15/16"	1-15/16"	2-1/8"	2-7/16"	1-9/16"	48	.18	10 ea	
420888	420888-1	120	2-15/16"	1-15/16"	2-1/8"	2-7/16"	1-9/16"	48	.18	10 ea	
420889	420889-1	150	2-15/16"	1-15/16"	2-1/8"	2-7/16"	1-9/16"	48	.18	10 ea	
420860	n/a	Panel-Mount Gasket Only								.01	10 ea

These Hi-Amp Resettable Circuit Breakers provide a visible indication of tripped condition. Single pole thermal type breaker they have a voltage rating of 48VDC and an interrupt level of 3000 amperes. Panel mounted, water resistant and sealed for engine compartment and bilge area applications. Constructed of Thermoset plastic with stainless steel studs and washers. CE certified.

⚠WARNING: Cancer and Reproductive Harm - www.P65Warnings.ca.gov

MINI BATTERY SWITCH WITH PUSH TO RESET BREAKER

Machined Brass/Injection Molded Nylon

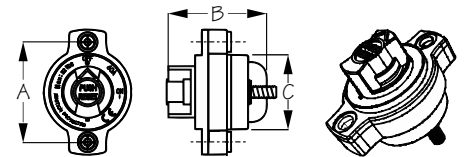

Bulk	Display	A	B	C	Function	Volts	Amps	Stud Diameter	Wt.(lb.)	Std. Pack
422753	422753-1	2"	2"	1-1/2"	On/Off	32	30	1/4"	.09 / .09	10 ea / 5 ea
422757	422757-1	2"	2"	1-1/2"	On/Off	32	70	1/4"	.14 / .14	10 ea / 5 ea

These Mini Battery Switches with Push to Reset Breaker feature a small footprint which makes them ideal for close quarters. The 422753-1 is rated at 30A continuous and 150A cranking amps and the 422757-1 is rated at 70A continuous and 300A cranking amps. Installation is as easy as drilling a 1-1/2" hole, inserting the socket body, installing the fasteners and connecting the wires. Constructed of machined brass and injection molded nylon.

⚠WARNING: Cancer and Reproductive Harm - www.P65Warnings.ca.gov

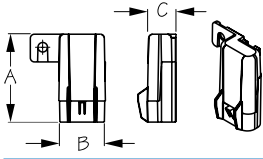

WATER RESISTANT CLEAR FUSE COVER

Polycarbonate



Bulk	Display	A	B	C	Wt.(lb.)	Std. Pack
425390	425390-1	2-1/18"	9/16"	3/8"	.06	10 ea

- Fits Glosco E39 (T3) manual reset circuit breaker fuse ATC/ATO
- Mounting tab
- Clear Polycarbonate for easy visibility of circuit breaker status

▲WARNING: Cancer and Reproductive Harm - www.P65Warnings.ca.gov

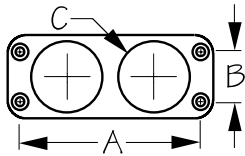

FRONT MOUNT SOCKET PANEL

Injection Molded Nylon



Bulk	Display	A	B	C	Color	Holes	Fastener	Wt.(lb.)	Std. Pack
426021	n/a	1-7/8"	n/a	1-1/8"	Black	1	#8 FH	.02	10 ea
426022	n/a	3-1/2"	1"	1-1/8"	Black	2	#8 FH	.05	10 ea
426023	n/a	5-3/16"	1"	1-1/8"	Black	3	#8 FH	.07	10 ea

Front Load Power Socket Panels accommodate USB/Meters and standard power sockets that are 1-1/8" diameter. Constructed of injection molded nylon. Power sockets not included.



Additional components not included

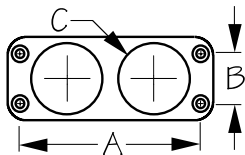

BACK MOUNT SOCKET PANEL

Injection Molded Nylon



Bulk	Display	A	B	C	Color	Holes	Fastener	Wt.(lb.)	Std. Pack
426031	n/a	1-7/8"	n/a	1-1/8"	Black	1	#8 FH	.02	10 ea
426032	n/a	3-1/2"	1"	1-1/8"	Black	2	#8 FH	.05	10 ea
426033	n/a	5-3/16"	1"	1-1/8"	Black	3	#8 FH	.07	10 ea

Back Mount Socket Panels accommodate USB/Meters and standard power sockets that are 1-1/8" diameter. Constructed of injection molded nylon. Power sockets not included.



Additional components not included



TENT MOUNT SOCKET PANEL

Injection Molded ABS



Bulk	Display	A	B	C	D	Holes	Fastener	Wt.(lb.)	Std. Pack
426027	426027-1	2-3/16"	3-3/16"	1-15/16"	1-1/8"	1	#6 FH	.05	10 ea
426028	426028-1	3-7/8"	3"	1-15/16"	1-1/8"	2	#6 FH	.10	10 ea
426029	426029-1	6"	3"	1-15/16"	1-1/8"	3	#6 FH	.15	10 ea

The Tent Mount Socket panel is used for under and top mount dash mounting when drilling a hole in the dash is neither practical or possible. Fits all Sea-Dog® round power sockets, gauges, and meters. Constructed of UV stabilized injection molded ABS. Installs with two #6 FH fasteners (not included). 1, 2 and 3 hole shells available.

▲WARNING: Cancer and Reproductive Harm - www.P65Warnings.ca.gov





USB 3.0 & USB-C POWER SOCKET WITH VOLTMETER

Injection Molded Nylon

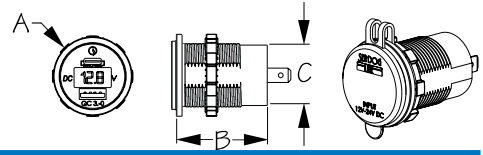

Bulk	Display	A	B	C	Volts	Total Output	USB-C Watts	USB 3.0 Watts	Wt.(lb.)	Std. Pack
426511	426511-1	1-7/16"	1-1/2"	1-1/8"	8-32	5V/6A	60W@24V	36W@12V	.08	5 ea

This USB 3.0 & USB-C Power Socket with Voltmeter charges two devices simultaneously while the LED screen displays voltage status. The total output 6A load is split 3A per side as needed. USB 3.0 features Quick Charging (QC) for supported devices, giving enough power to charge phones, pads, and tablets quickly and efficiently. USB-C features Power Delivery (PD) for faster and more flexible charging. Protective dust cap extends the life of the charger. LED volt meter reads voltage up to 14.6 volts. Constructed of injection molded nylon. Installation is as easy as drilling a 1-1/8" hole, inserting the socket body, tightening the locking nut, and connecting the wires. Also fits Sea-Dog® Power Socket Shell (426100) and Mounting Bracket (426105). Output DC: 5V/6A. Input: 8-32VDC. USB-C Watts: 60W@24V. USB 3.0 Watts: 36W@12V. Blue LED display. IP65 rating. RoHS compliant.



⚠WARNING: Cancer and Reproductive Harm - www.P65Warnings.ca.gov



USB 3.0 & USB-C POWER SOCKET WITH FIXED COVER

Injection Molded Nylon

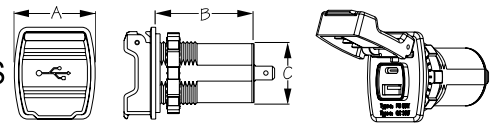

Bulk	Display	A	B	C	Volts	Total Output	USB-C Watts	USB 3.0 Watts	Wt.(lb.)	Std. Pack
426541	426541-1	1-7/16"	1-3/4"	1-1/8"	6-32	5V/6A	60W@24V	36W@12V	.07	5 ea

This USB 3.0 & USB-C Power Socket with Fixed Cover charges two devices simultaneously. The total output 6A load is split 3A per side as needed. USB 3.0 features Quick Charging (QC) for supported devices, giving enough power to charge phones, pads, and tablets quickly and efficiently. USB-C features Power Delivery (PD) for faster and more flexible charging. Protective cover extends the life of the charger. Constructed of injection molded nylon. Installation is as easy as drilling a 1-1/8" hole, inserting the socket body, tightening the locking nut, and connecting the wires. Also fits Sea-Dog® Power Socket Shell (426100) and Mounting Bracket (426105). Output DC: 5V/6A. Input: 8-32VDC. USB-C Watts: 60W@24V. USB 3.0 Watts: 36W@12V. Blue LED display. IP65 rating. RoHS compliant.



⚠WARNING: Cancer and Reproductive Harm - www.P65Warnings.ca.gov



USB 3.0 & USB-C ROCKER STYLE POWER SOCKET WITH DUAL FIXED COVER

Injection Molded Nylon

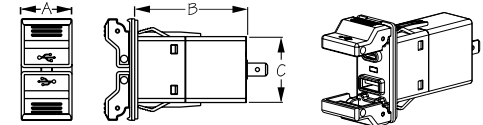

Bulk	Display	A	B	C	Volts	Total Output	USB-C Watts	USB 3.0 Watts	Wt.(lb.)	Std. Pack
426545	426545-1	1"	2-1/8"	1-7/16"	6-32	5V/6A	60W@24V	36W@12V	.09	5 ea

This USB 3.0 & USB-C Rocker Style Power Socket with Dual Fixed Covers charges two devices simultaneously. The total output 6A load is split 3A per side as needed. USB 3.0 features Quick Charging (QC) for supported devices, giving enough power to charge phones, pads, and tablets quickly and efficiently. USB-C features Power Delivery (PD) for faster and more flexible charging. Dual protective covers extends the life of the charger. Constructed of injection molded nylon. Fits into any 13/16" x 1-7/16" rocker switch hole. Output DC: 5V/6A. Input: 8-32VDC. USB-C Watts: 60W@24V. USB 3.0 Watts: 36W@12V. Blue LED display. IP65 rating. RoHS compliant.



⚠WARNING: Cancer and Reproductive Harm - www.P65Warnings.ca.gov



ATO/ATC/ATM DUAL FUSE BLOCK WITH NEGATIVE BLOCK

Nickel Plated Copper/Stainless Steel/Injection Molded ABS

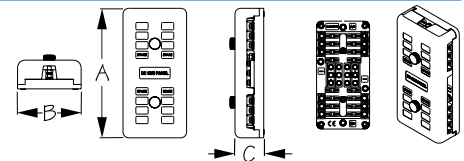

Bulk	Display	Terminals	A	B	C	Fastener	Wt.(lb.)	Std. Pack
445179	445179-1	16	8-1/8"	3.-1/4"	1-1/2"	#8 FH	.53	4 ea

- Dual Main line terminal rating is 100A each block (200A total) 32VDC max, with M5 metric threaded studs
- Includes two fuse removal tools, semi-transparent cover with removable retaining knobs and 71 labels
- Uses ATO/ATC & ATM fuses 1A-30A
- Common negative buss
- Single line terminal rating is 30A 32VDC max, with M4 metric threaded studs
- Terminals are nickel plated copper with stainless steel screws
- Installs with four #8 FH fasteners (not included)



⚠WARNING: Cancer and Reproductive Harm - www.P65Warnings.ca.gov

NOT TO TOOT OUR OWN HORN

**BUT WE THINK
YOU'LL LOVE OURS**



MAXBLAST
Single Trumpet Horn
431510-1, 431530-1

MAXBLAST
Single Mini Compact Horn
431115-1

MAXBLAST
Twin Mini Compact Horn
431125-1

MAXBLAST
Dual Trumpet Horn
431520-1, 431540-1



Drop-in Hidden Horn V.1 w/ Grills
431210-1

Drop-in Hidden Horn V.2 w/ Grills
431230-1

Drop-in Hidden Horn V.3 w/ Grills
431250-1



Single Mini Compact Horn
431110-1

Twin Mini Compact Horn
431120-1

Mini Compact Horn w/ Bracket
431430-1



Now also
available as
a Low-Tone
Horn!
431431-1



MINI COMPACT LOW-TONE HORN W/ BRACKET

Powder Coated Steel/304 Stainless Steel

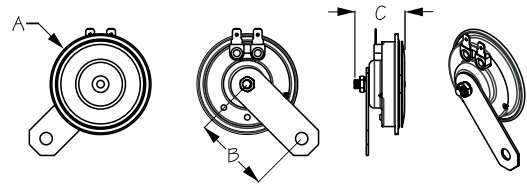

Bulk	Display	Amps	dB	Frequency (Hz)	A	B	C	Wt.(lb.)	Std. Pack
431431	431431-1	4	111	330±20	2-13/16"	2-3/16"	1-7/16"	.35	12 ea / 6 ea

At 111 decibels and a frequency (Hz) of 330±20A, this Mini Compact Low-Tone Horn meets US Coast Guard's COLREGS and ABYC standard A-23 for use on vessels under 12m (39'). Constructed of powder coated steel with corrosion resistant 304 stainless steel bracket for easy mounting. Recommended for freshwater use. NMMA Type Accepted #2601746. 12VDC.

⚠WARNING: Cancer and Reproductive Harm - www.P65Warnings.ca.gov



POP-UP SINK STOPPER

Injection Molded Nylon

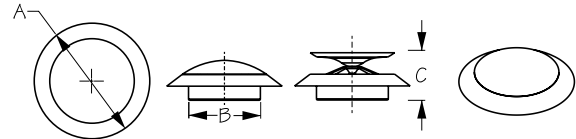

Bulk	Display	A	B (Drain)	C	Size	Wt.(lb.)	Std. Pack
n/a	517395-1	1-15/16"	1-1/4"	3/4"	Small	.01	10 ea
n/a	517397-1	2-7/16"	1-1/2"	1"	Large	.02	10 ea

Unique design offers plug and drain in one product, simply install stopper to plug drain and press top to instantly activate drain without ever removing plug. Great for Boats, RVs or any 1-1/4" to 1-1/2" drains. Available in Small or Large diameters.



THRU-HULL WITH STAINLESS CAP

Injection Molded Polypropylene/Stamped 304 Stainless

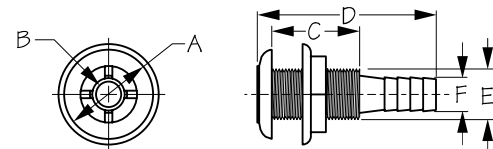

Bulk	Display	A	B	C	D	E	F	Finish	Wt.(lb.)	Std. Pack
520820	n/a	1-7/8"	7/8"	1-3/4"	3-3/8"	1-3/16"	5/8"	Stainless	.07	10 ea
520821	n/a	1-7/8"	7/8"	1-3/4"	3-3/8"	1-3/16"	3/4"	Stainless	.07	10 ea
520822	n/a	1-7/8"	7/8"	1-3/4"	3-3/8"	1-3/16"	1"	Stainless	.10	10 ea
520823	n/a	1-7/8"	7/8"	1-3/4"	3-3/8"	1-3/16"	1-1/8"	Stainless	.12	10 ea
520825	n/a	2-3/8"	1-1/8"	1-7/8"	4"	1-9/16"	1-1/2"	Stainless	.23	10 ea

Thru-Hulls feature Polypropylene bodies with 304 stainless caps. Designed to allow water to pass in or out of a vessel. For use with hose for drainage above the water line. Constructed of injection molded polypropylene and 304 stamped stainless. Great in conjunction with our Dripper Guards® (520850).

⚠WARNING: Cancer and Reproductive Harm - www.P65Warnings.ca.gov



90° THRU-HULL WITH STAINLESS CAP

Injection Molded Polypropylene/Stamped 304 Stainless

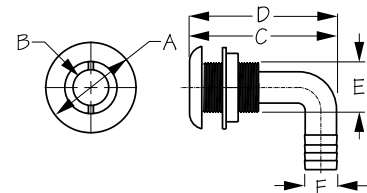

Bulk	Display	A	B	C	D	E	F	Finish	Wt.(lb.)	Std. Pack
520830	n/a	1-7/8"	7/8"	1-13/16"	3-7/16"	1-15/16"	5/8"	Stainless	.07	10 ea
520831	n/a	1-7/8"	7/8"	1-13/16"	3-7/16"	1-15/16"	3/4"	Stainless	.08	10 ea
520832	n/a	1-7/8"	7/8"	1-13/16"	3-3/4"	1-15/16"	1"	Stainless	.10	10 ea
520833	n/a	1-7/8"	7/8"	1-13/16"	3-3/4"	1-15/16"	1-1/8"	Stainless	.12	10 ea
520835	n/a	2-3/8"	1-1/8"	1-13/16"	4-5/16"	1-9/16"	1-1/2"	Stainless	.23	10 ea

90° Thru-Hulls feature Polypropylene bodies with 304 stainless caps. Designed to allow water to pass in or out of a vessel. For use with hose for drainage above the water line. Constructed of injection molded polypropylene and 304 stamped stainless. Great in conjunction with our Dripper Guards® (520850).

⚠WARNING: Cancer and Reproductive Harm - www.P65Warnings.ca.gov

Introducing Dripper Guard™

Sea-Dog is proud to announce a brand-new innovation and partnership with Dripper Guard™.

Dripper Guard™ prevents boat hull stains caused by water dripping from thru-hull drains. It's perfect for any component on your boat that has a thru-hull! Ideal for preventing stains from air conditioner, sink, generator, shower, bilge pump, baitwell, and sump pump thru-hulls.

Forget the boat hull cleaner and make your boat maintenance a breeze with Dripper Guard™!



DRIPPER GUARD® 3M® BY SEA-DOG® ADHESIVE STAIN GUARD

Nitrile-Buna Rubber

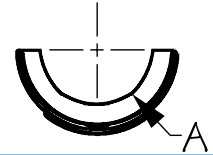

Bulk	Display	A	Pack Qty.	Color	Wt.(lb.)	Std. Pack
520840	520840-1	Up To 1-7/8"	1	White	.02	10 ea
520841	520841-1	Up To 1-7/8"	1	Black	.02	10 ea
520842	520842-1	Up To 2-5/8"	1	White	.02	10 ea
520843	520843-1	Up To 2-5/8"	1	Black	.02	10 ea
n/a	520846-1	Up To 1-7/8"	3	White	.02	10 set
n/a	520847-1	Up To 1-7/8"	3	Black	.06	10 set
n/a	520848-1	Up To 2-5/8"	3	White	.06	10 set
n/a	520849-1	Up To 2-5/8"	3	Black	.06	10 set

Dripper Guard® 3M® by Sea-Dog® Adhesive Stain Guard stops ugly black streaks from staining the side of your boat. Easy do-it yourself installation, simple prep-peel backing and press along the bottom edge of your thru-hull. Patented channel design redirects water out and away from the hull preventing drips down the side and eliminates stains and water sediment build up.



⚠WARNING: Cancer and Reproductive Harm - www.P65Warnings.ca.gov

DRIPPER GUARD® PRO BY SEA-DOG®

Nitrile-Buna Rubber

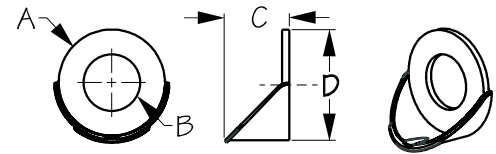

Bulk	Display	A	B	C	Color	Wt.(lb.)	Std. Pack
520850	520850-1	1-7/8"	1"	1-15/16"	Black	.02	10 ea
520851	520851-1	1-7/8"	3/4"	1-15/16"	White	.02	10 ea
520852	520852-1	1-7/8"	3/4"	1-15/16"	Black	.02	10 ea
520853	520853-1	1-7/8"	1-1/8"	1-15/16"	White	.02	10 ea
520854	520854-1	1-7/8"	1-1/8"	1-15/16"	Black	.02	10 ea

- The Dripper Guard® PRO attaches directly to your thru-hull for quick and easy installation
- The Dripper Guard® PRO keeps your boat looking beautiful by protecting it from unsightly stains
- The Dripper Guard® PRO is composed of a soft and durable rubber compound for continued grip and protection – even in the worst weather
- The Dripper Guard® PRO fits a wide variety of thru-hulls including Attwood®, Groco®, Perko®, and more



⚠WARNING: Cancer and Reproductive Harm - www.P65Warnings.ca.gov

DRIPPER GUARD® BY SEA-DOG® THRU-HULL WITH STAINLESS CAP

Injection Molded Polypropylene/316 Stainless

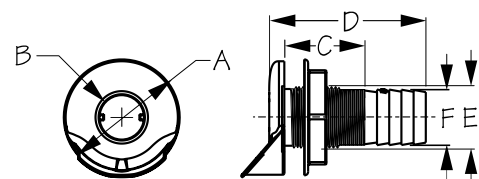

Bulk	Display	A	B	C	D	E	F	Finish	Wt.(lb.)	Std. Pack
520860	n/a	1-7/8"	7/8"	1-3/4"	3-3/8"	1-3/16"	5/8"	Mirror Polished Cap/Black Body	.10	10 ea
520861	n/a	1-7/8"	7/8"	1-3/4"	3-3/8"	1-3/16"	3/4"	Mirror Polished Cap/Black Body	.10	10 ea
520862	n/a	1-7/8"	7/8"	1-3/4"	3-3/8"	1-3/16"	1"	Mirror Polished Cap/Black Body	.13	10 ea
520863	n/a	1-7/8"	7/8"	1-3/4"	3-3/8"	1-3/16"	1-1/8"	Mirror Polished Cap/Black Body	.15	10 ea
520865	n/a	2-3/8"	1-1/8"	1-7/8"	4"	1-9/16"	1-1/2"	Mirror Polished Cap/Black Body	.26	10 ea

Dripper Guard® by Sea-Dog® Thru-Hull with Stainless Cap features a Polypropylene body with a investment cast 316 stainless cap for a high-end appearance. Designed to keep your boat looking beautiful by protecting it from unsightly water stains. Available in various common hose sizes. For drainage above the water line.

⚠WARNING: Cancer and Reproductive Harm - www.P65Warnings.ca.gov

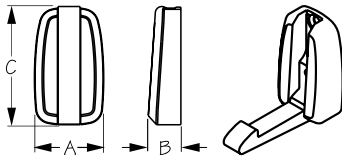

FOLDING COAT HOOK

Investment Cast 316 Stainless Steel



Bulk	Display	A	B	C	Fastener	Wt.(lb.)	Std. Pack
671497	671497-1	1-3/16"	9/16"	2"	#8 FH	.18	10 ea

Folds flat when not in use. Constructed of corrosion resistant investment cast 316 stainless steel with rubber gasket. Installs with two #8 FH fasteners (not included).

⚠WARNING: Cancer and Reproductive Harm - www.P65Warnings.ca.gov



NMEA 2000 MARINE CONNECTORS, CABLES & ACCESSORIES

Injection Molded Nylon



Bulk	Display	Description	Wt.(lb.)	Std. Pack
820000	820000-1	T-Connector 0.3m	.05	5 ea
820003	820003-1	Front Mount Cable	.03	5 ea
820005	820005-1	Rear Mount Cable	.03	5 ea
820007	820007-1	Female Terminator	.01	5 ea
820009	820009-1	Male Terminator	.01	5 ea
820010	820010-1	Power Isolator	.03	5 ea
820014	820014-1	Blanking Cap, Female	.01	5 ea
820015	820015-1	Blanking Cap, Male	.01	5 ea
820016	820016-1	Through Bulkhead Adaptor	.02	5 ea
820019	820019-1	T-Connector-2 Way Cable	.08	5 ea
820020	820020-1	90° Elbow Connector	.02	5 ea
820021	820021-1	T-Connector-Single	.05	5 ea
820022	820022-1	T-Connector-2 Way	.07	5 ea
820023	820023-1	T-Connector-3 Way	.10	5 ea
820024	820024-1	T-Connector-4 Way	.13	1 ea
820025	820025-1	T-Connector-5 Way	.15	1 ea
820026	820026-1	T-Connector-6 Way	.18	1 ea
820031	820031-1	Backbone Cable, .5m (1.6')	.09	5 ea
820035	820035-1	Backbone Cable, 2m (6.5')	.70	5 ea
820037	820037-1	Backbone Cable, 5m (16')	.90	1 ea
820038	820038-1	Backbone Cable, 10m (32')	1.35	1 ea
820041	820041-1	Drop Cable, .5m (1.6')	.09	5 ea
820043	820043-1	Drop Cable, 1m (3.3')	.18	5 ea
820045	820045-1	Drop Cable, 2m (6.5')	.26	5 ea
820047	820047-1	Drop Cable, 5m (16')	.75	5 ea

NMEA 2000 Marine Connectors, Cables & Accessories, T and Elbow connectors from 1 to 6 ports. Backbone cables 1-1/2' to 32'; Drop Cables 1-1/2' to 16'; Rear Mount Cable, T Connector Cables, Power Isolator, various caps and Bulkhead adapters.

⚠WARNING: Cancer and Reproductive Harm - www.P65Warnings.ca.gov





2024 SUPPLEMENT

EXPERIENCE THE SEA-DOG DIFFERENCE



OVAL FOLDING CLEAT W/HIDDEN HEX BOLTS

Investment Cast Stainless 316

PATENT PENDING

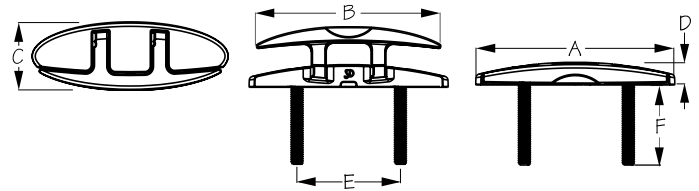

Bulk	Display	A	B	C	D	E	F	Fastener	Finish	Wt.(lb.)	Std. Pack
041115	041115-1	5"	4-5/8"	1-11/16"	1/2"	2-11/16"	1/4"-20 x 2"	Hex Bolts	Polished	.29	10 ea
041115B	041115B-1	5"	4-5/8"	1-11/16"	1/2"	2-11/16"	1/4"-20 x 2"	Hex Bolts	Black	.29	10 ea

This Oval Folding Cleat with Hidden Hex Bolts feature an innovative design incorporating removable hex bolts vs. welded studs making bolt length choices easy for the customer. Incorporates a positive locking feature with audible click into the open/closed positions for easy rigging. Accommodates up to 1/2" line. Low profile ergonomic design makes for smooth, sleek appearance when closed, limiting trip hazards. Constructed of corrosion resistant investment cast 316 stainless steel. Bulk cleats do not include fasteners. Display packaged cleats (-1) include 2 hex bolts, 2 washers, and 2 nuts per cleat. Available in a highly polished or black powder coated finish. Patent Pending.



OVAL FOLDING CLEAT

Investment Cast Stainless 316

PATENT PENDING

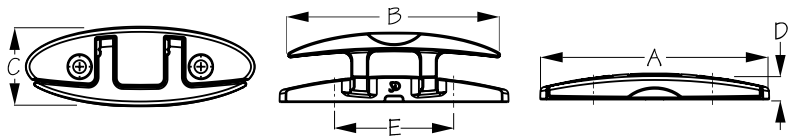

Bulk	Display	A	B	C	D	E	Fastener	Finish	Wt.(lb.)	Std. Pack
041125	041125-1	5"	4-5/8"	1-11/16"	1/2"	2-11/16"	1/4" FH	Polished	.29	10 ea
041125B	041125B-1	5"	4-5/8"	1-11/16"	1/2"	2-11/16"	1/4" FH	Black	.29	10 ea

This Oval Folding Cleat incorporates a positive locking feature with audible click into the open/closed positions for easy rigging. Accommodates up to 1/2" line. Low profile ergonomic design makes for smooth, sleek appearance when closed, limiting trip hazards. Constructed of corrosion resistant investment cast 316 stainless steel. Surface mounted: no cut-outs or hole saws required. Installs with two 1/4"-20 through bolts (not included). Available in a highly polished or black powder coated finish. Patent Pending.



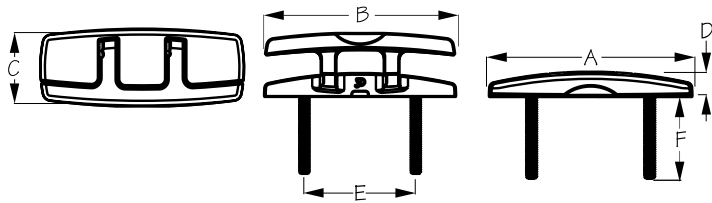

**RECTANGULAR FOLDING CLEAT
W/HIDDEN HEX BOLTS**

Investment Cast Stainless 316

PATENT PENDING



Bulk	Display	A	B	C	D	E	F	Finish	Wt.(lb.)	Std. Pack
041135	041135-1	4-9/16"	4-1/2"	1-11/16"	9/16"	2-11/16"	1/4"-20 x 2" Hex Bolts	Polished	.29	10 ea
041135B	041135B-1	4-9/16"	4-1/2"	1-11/16"	9/16"	2-11/16"	1/4"-20 x 2" Hex Bolts	Black	.29	10 ea
041136	041136-1	6-1/16"	6"	2-3/16"	11/16"	3-1/2"	5/16"-18 x 2" Hex Bolts	Polished	.59	10 ea

This Rectangular Folding Cleat with Hidden Hex Bolts features an innovative design incorporating removable hex bolts vs. welded studs making bolt length choices easy for the customer. Drain opening allows water and debris to pass through, reducing corrosion and wear to cleat. Incorporates a positive locking feature with audible click into the open/closed positions for easy rigging. Accommodates up to 1/2" line (4-1/2" cleat) or 5/8" line (6" cleat). Low profile ergonomic design makes for smooth, sleek appearance when closed, limiting trip hazards. Constructed of corrosion resistant investment cast 316 stainless steel. Bulk cleats do not include fasteners. Display packaged cleats (-1) include 2 hex bolts, 2 washers, and 2 nuts per cleat. Available in a highly polished or black powder coated finish. Patent Pending.

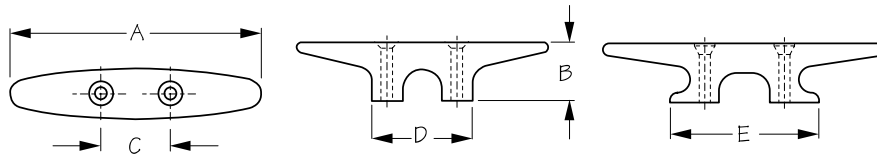

HEAVY DUTY CLEAT

Injection Molded Nylon



Bulk	Display	Color	A	B	C	D	E	Fastener	Wt.(lb.)	Std. Pack
043342	043342-1	Flat Dark Earth	4-1/4"	1"	1-1/4"	1-3/4"	n/a	#10 FH	.06 / .12	10 ea / 10 pr
043362	043362-1	Flat Dark Earth	6-1/16"	1-1/4"	1-9/16"	2-1/4"	n/a	1/4" FH	.13 / .26	10 ea / 10 pr
043382	043382-1	Flat Dark Earth	8-1/16"	1-3/4"	2-1/4"	n/a	4-3/16"	5/16" FH	.29	10 ea

These tie-down Heavy Duty Cleats are durable and easy to install. Larger cleats feature flared post for added strength and stability. Proudly constructed in the USA of corrosion and UV resistant injected molded nylon. Installs with two flat head fasteners (not included).

- Special Order Requirements May Apply
- Custom Colors Available with Large Order

▲WARNING: Cancer and Reproductive Harm - www.P65Warnings.ca.gov

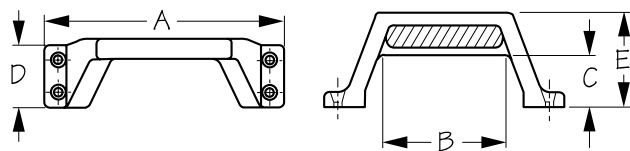

STEP HANDLE

Injection Molded Nylon



Bulk	Display	A	B	C	D	E	Color	Fastener	Wt.(lb.)	Std. Pack
227262	227262-1	6-3/8"	3-1/4"	1-3/8"	1-5/8"	2-1/2"	Flat Dark Earth	1/4" RH	.22	10 ea

These Step Handles are designed for use as a lift handle on small boat transoms. Molded with a contoured handle grip, the textured upper surface also allows these handles to be used as a step. Proudly constructed in the USA of UV resistant injection molded nylon. Installs with four 1/4" RH fasteners (not included).

- Special Order Requirements May Apply
- Custom Colors Available with Large Order

▲WARNING: Cancer and Reproductive Harm - www.P65Warnings.ca.gov



TRIPLE THREAT™ THREE POLE ROD HOLDER

Injection Molded Polypropylene



PATENT PENDING

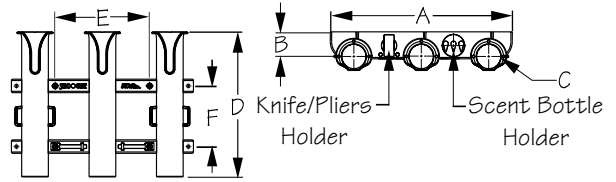

Bulk	Display	A	B	C	D	E	F	Color	Wt.(lb.)	Std. Pack
325032	325032-1	13-1/2"	1-7/8"	1-3/4"	10-3/4"	7"	4-1/2"	White	.87 / .95	10 ea
325033	325033-1	13-1/2"	1-7/8"	1-3/4"	10-3/4"	7"	4-1/2"	Black	.87 / .95	10 ea
325034	325034-1	13-1/2"	1-7/8"	1-3/4"	10-3/4"	7"	4-1/2"	Flat Dark Earth	.87 / .95	10 ea

Our Triple Threat™ Three Pole Rod Holder is proudly made in the USA with recycled materials. Features the ability to hold bait, cast, and fly fishing rods/reels. These three-pole, side-mount rod holders come equipped with a built-in knife and plier storage with holders that can accommodate up to 16 different fishing lures. Several key features unique to our patent pending design include: Accessory Track Mounting System™, scent bottle storage, as well as four leash and two bungee cord attachment points. Accommodates rods up to 1-3/4" in diameter. Constructed of one-piece injection molded, UV stabilized polypropylene. No assembly required. Installs with four #8 fasteners (included in display packed product). Available in Black, White, or FDE (Flat Dark Earth). This is a fisherman's dream and is a must have for any boat, kayak, or dock!

⚠WARNING: Cancer and Reproductive Harm - www.P65Warnings.ca.gov



SIDE MOUNT ROD HOLDER

Injection Molded Polypropylene

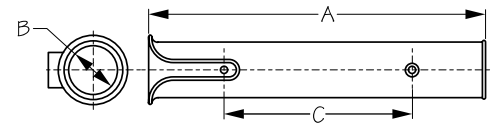

Bulk	Display	A	B	C	Color	Fastener	Wt.(lb.)	Std. Pack
325123	325123-1	11-11/16"	1-3/4"	6-1/4"	Flat Dark Earth	#10 RH	.22	8 ea

These Side Mount Rod Holders feature an integral, molded-in standoff located on the back of the rod holder. This standoff allows direct mounting to any flat surface. Accommodates rods up to 1-3/4" in diameter. Proudly constructed in the USA of injection molded polypropylene. Installs with two #10 RH fasteners (not included).

- Custom colors available on large volume orders

⚠WARNING: Cancer and Reproductive Harm - www.P65Warnings.ca.gov



FLUSH MOUNT ROD HOLDER

Injection Molded ABS

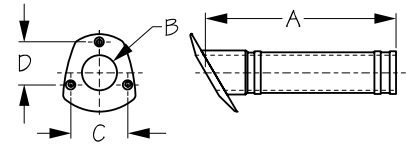

Bulk	Display	A	B	C	D	Color	Cap	Fastener	Wt.(lb.)	Std. Pack
325166	325166-1	9-3/16"	1-5/8"	2-1/2"	2-5/8"	Flat Dark Earth	No	1/4" FH	.40	8 ea

These Flush Mount Rod Holders can accommodate rods up to 1-5/8" in diameter. Features a 30° angle. Proudly constructed in the USA of UV resistant injection molded ABS. Installs with three 1/4" FH fasteners (not included).

- Custom colors available on large volume orders

⚠WARNING: Cancer and Reproductive Harm - www.P65Warnings.ca.gov



POWER BOX - BATTERY SWITCH

Injection Molded Nylon

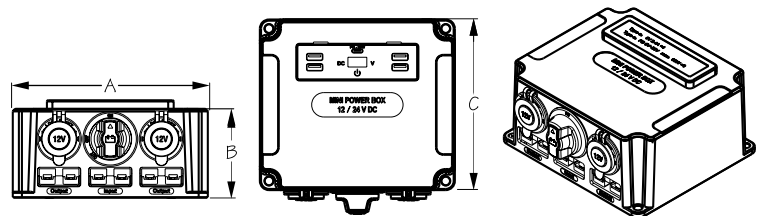

Bulk	Display	A	B	C	Volts	Total Output	Wt.(lb.)	Std. Pack
n/a	422737-3	6-1/4"	3-1/8"	5-9/16"	12-24	50A	1.70	1 ea

The Power Box is controlled with a 50A battery switch with removable knob for extra security and is monitored with an LED voltmeter. Includes two power sockets, two Anderson outputs, four USB-A and one USB-C. Onboard internal fuse block. Great for John Boats & kayaks. Anderson battery plug included. 12-24V. 50A.

⚠WARNING: Cancer and Reproductive Harm - www.P65Warnings.ca.gov

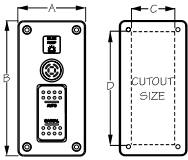

BILGE PUMP WATER ALARM PANEL WITH SWITCH

Injection Molded ABS



Bulk	Display	A	B	C	D	Volts	Wt.(lb.)	Std. Pack
n/a	423037-1	2-3/8"	4-11/16"	1-1/2"	3-7/8"	12	.33	10 ea

The Bilge Pump Water Alarm Panel with Switch provides both an audible and visual means of warning that the water level in your bilge is above your bilge pump float switch level. There is no need for a separate bilge pump switch, as the control switch selects between the automatic and manual (momentary on) function of the bilge pump. 20A fuse holder. Constructed of injection molded ABS. Installs with gasket and four RH fasteners (included).

⚠WARNING: Cancer and Reproductive Harm - www.P65Warnings.ca.gov

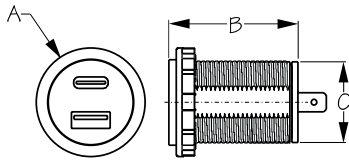

USB 3.0 & USB-C POWER SOCKET W/O LIGHT

Injection Molded Nylon



Bulk	Display	A	B	C	Volts	Total Output	USB-C	USB-A	Wt.(lb.)	Std. Pack
426510	426510-1	1-7/16"	1-1/2"	1-1/8"	8-32	5V/6A	60W@24V	36W@12V	.08	10 ea

USB 3.0 & USB-C Power Socket charges two devices simultaneously. When split, the total 6A output is 3A per side. USB 3.0 features Quick Charging (QC) for supported devices, giving enough power to charge phones, pads, and tablets quickly and efficiently. USB-C features Power Delivery (PD) for faster and more flexible charging. Protective dust cap extends the life of the charger. Constructed of injection molded nylon. Installation is as easy as drilling a 1-1/8" hole, inserting the socket body, tightening the locking nut, and connecting the wires. Also fits Sea-Dog® Power Socket Shell (426100) and Mounting Bracket (426105). Output DC: 5V/6A. Input: 8-32VDC. USB-C Watts: 60W@24V. USB 3.0 Watts: 36W@12V. Non-illuminating. IP65 rating. CE, RoHS compliant.

⚠WARNING: Cancer and Reproductive Harm - www.P65Warnings.ca.gov

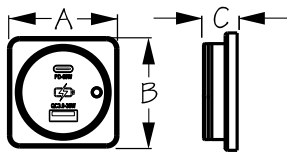

SURFACE MOUNT - SQUARE USB 3.0 & USB-C POWER SOCKET

Injection Molded Nylon



Bulk	Display	A	B	C	Volts	Total Output	USB-C	USB-A	Wt.(lb.)	Std. Pack
426531	426531-1	1-15/16"	1-15/16"	3/4"	8-32	5V/6A	60W@24V	36W@12V	.07	10 ea

This Square Surface Mount USB 3.0 & USB-C Power Socket charges two devices simultaneously. When split, the total 6A output is 3A per side. USB 3.0 features Quick Charging (QC) for supported devices, giving enough power to charge phones, pads, and tablets quickly and efficiently. USB-C features Power Delivery (PD) for faster and more flexible charging. Protective dust cap extends the life of the charger. Constructed of injection molded nylon. Installation is as easy as drilling a 3/16" hole for the wire connection, secure to surface with two #6 screws (not included) and snapping concealed fastener cover in place. Output DC: 5V/6A. Input: 8-32VDC. USB-C Watts: 60W@24V. USB 3.0 Watts: 36W@12V. Blue LED illumination. IP65 rating. CE, RoHS compliant.

⚠WARNING: Cancer and Reproductive Harm - www.P65Warnings.ca.gov

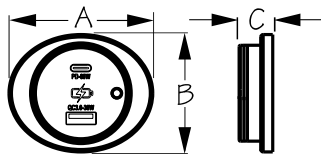

SURFACE MOUNT - OVAL USB 3.0 & USB-C POWER SOCKET

Injection Molded Nylon



Bulk	Display	A	B	C	Volts	Total Output	USB-C	USB-A	Wt.(lb.)	Std. Pack
426535	426535-1	2-3/8"	1-15/16"	3/4"	8-32	5V/6A	60W@24V	36W@12V	.07	10 ea

This Oval Surface Mount USB 3.0 & USB-C Power Socket charges two devices simultaneously. When split, the total 6A output is 3A per side. USB 3.0 features Quick Charging (QC) for supported devices, giving enough power to charge phones, pads, and tablets quickly and efficiently. USB-C features Power Delivery (PD) for faster and more flexible charging. Protective dust cap extends the life of the charger. Constructed of injection molded nylon. Installation is as easy as drilling a 3/16" hole for the wire connection, secure to surface with two #6 screws (not included) and snapping concealed fastener cover in place. Output DC: 5V/6A. Input: 8-32VDC. USB-C Watts: 60W@24V. USB 3.0 Watts: 36W@12V. Blue LED illumination. IP65 rating. CE, RoHS compliant.

⚠WARNING: Cancer and Reproductive Harm - www.P65Warnings.ca.gov



BUSS BAR WITH COVER

Tin Plated Copper/ABS/Polycarbonate

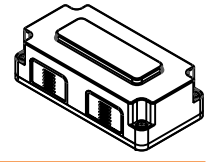
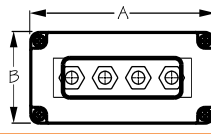

Bulk	Display	Terminals	A	B	C	Max. Amps	Fastener	Wt.(lb.)	Std. Pack
n/a	426691-3	4	5-1/2"	2-3/4"	1-11/16"	300	#8 FH	.59	1 ea

This Bus Bar is designed for positive or negative DC distribution or collection of AC neutral or safety ground circuits. Constructed of corrosion resistant tin-plated copper and ABS with a polycarbonate cover. Includes four 5/16"-18 stainless steel stud terminals. Installs with four #8 FH fasteners (not included). Maximum: 48VDC, 300A; 300VAC, 300A. CE, RoHS compliant.

⚠️WARNING: Cancer and Reproductive Harm - www.P65Warnings.ca.gov



BUSS BAR WITH COVER

Tin Plated Copper/ABS/Polycarbonate

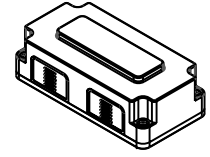
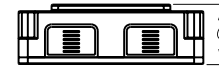
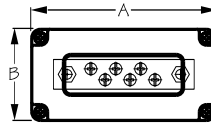

Bulk	Display	Terminals	A	B	C	Max. Amps	Fastener	Wt.(lb.)	Std. Pack
n/a	426692-3	6	5-1/2"	2-3/4"	1-11/16"	300	#8 FH	.68	1 ea

This Bus Bar is designed for positive or negative DC distribution or collection of AC neutral or safety ground circuits. Constructed of corrosion resistant tin-plated copper and ABS with a polycarbonate cover. Includes two 5/16"-18 stainless steel stud terminals and six #10-32 stainless steel terminal screws. Installs with four #8 FH fasteners (not included). Maximum: 48VDC, 300A; 300VAC, 300A. CE, RoHS compliant.

⚠️WARNING: Cancer and Reproductive Harm - www.P65Warnings.ca.gov



DUAL BUSS BAR WITH COVER

Tin Plated Copper/ABS/Polycarbonate

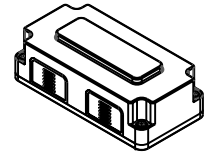
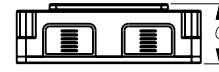
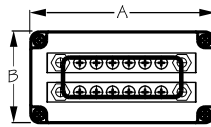

Bulk	Display	Terminals	A	B	C	Max. Amps	Fastener	Wt.(lb.)	Std. Pack
n/a	426693-3	12	5-1/2"	2-3/4"	1-11/16"	150	#8 FH	.59	1 ea

This Dual Bus Bar is designed for DC positive or negative distribution on one block or AC neutral and safety ground collection on one block. Constructed of corrosion resistant tin-plated copper and ABS with a polycarbonate cover. Includes two 1/4"-20 stainless steel terminal studs and six #8-32 stainless steel terminal screws per bus. Installs with four #8 FH fasteners (not included). Maximum: 48VDC, 150A per buss; 300VAC, 150A per buss. CE, RoHS compliant.

⚠️WARNING: Cancer and Reproductive Harm - www.P65Warnings.ca.gov



FENDER HOOK

Investment Cast 316 Stainless Steel

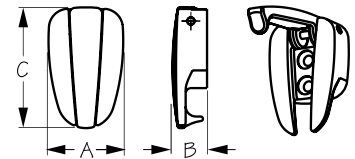

Bulk	Display	A	B	C	Line Size	Fastener	Wt.(lb.)	Std. Pack
672560	672560-1	1-1/4"	5/8"	2-1/16"	1/4"-3/8"	#8 FH	.24	10 ea

This Fender Hook can be used for quick and easy placement of fenders. Designed to be installed on the gunwale for use with up to 3/8" line. Spring loaded hook keeps line captive against surface. Constructed of corrosion resistant investment cast 316 stainless steel with rubber gasket. Installs with two #8 FH fasteners (not included).

⚠️WARNING: Cancer and Reproductive Harm - www.P65Warnings.ca.gov



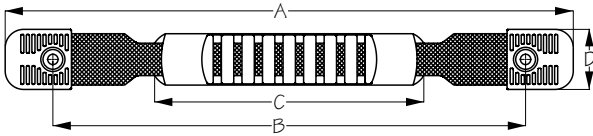

WEBBING HANDLE W/ CAPS KIT

Injection Molded Nylon/Webbing



Bulk	Display	A	B	C	D	Fastener	Wt.(lb.)	Std. Pack
n/a	227462-9	11-1/2"	10"	5"	1"	#10 PH	.19	10 kits

This Webbing Lift Handle is easy to hold even when wet. Ideal for replacement of worn or torn handles or to add another handle to make it easier to carry your kayak, paddle board, or canoe. Works for both end and side carry handles. Includes nylon end caps. Kit includes: Webbing handle (1), End caps (2), 10-32 X 1" PH machine screws (2), 10-32 Nyloc nuts (2), and #10 Fender washers (2). Constructed of nylon webbing with an injection molded nylon handle. Installs with two #10 RH fasteners (not included) or on an inflatable boat with use of the proper adhesive.

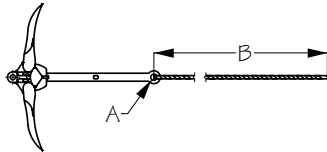

FOLDING ANCHOR KIT - ECONOMY

Hot Dipped Galvanized Iron/Forged Flukes



Bulk	Display	A	B	Boat Length	Line / Length	Wt.(lb.)	Std. Pack
n/a	318003K1-1	1/2"	20'	5' - 12'	3/16" / 20'	3.5	1 ea

Our Economy Folding Anchor Kit includes everything you need to get started. It comes complete with our popular 3.5 lb. folding anchor, 20' of 3/16" line and a handy mesh bag. Constructed of hot dipped galvanized iron with forged flukes.

⚠WARNING: Cancer and Reproductive Harm - www.P65Warnings.ca.gov



PERFORMANCE ANCHOR TROLLEY KIT

Injection Molded Nylon/Stainless Steel/Polyester



Bulk	Display	Description	Fasteners Included	Wt.(lb.)	Std. Pack
n/a	318110-9	Performance Anchor Trolley Kit	Yes	.80	5 kits

Our Performance Anchor Trolley Kit is an essential tool for the Pro Angler. It features a zig cleat for easy, one-handed adjustability. The durable, one-piece cheek blocks operate silently so you won't scare fish in the water below. When the need arises to wade through the water, easily unclip the custom designed ring and use the system as a leash. Kit includes: 30' of 3/16" polypro deck line (1), zig cleat (1), ring clip (1), cheek blocks (2), nylon pad eyes (6), 10-32 X 3/4" PH machine screws (10), 10-32 Nyloc nuts (10), #10 flat washers (10), and well nuts (10). Proudly constructed in the USA of injection molded nylon, stainless steel, and polyester.

⚠WARNING: Cancer and Reproductive Harm - www.P65Warnings.ca.gov

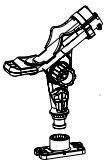

TRIPLE THREAT™ ROD HOLDER - SURFACE MOUNT

Injection Molded Glass Filled Nylon



Bulk	Display	Base	Fastener	Wt.(lb.)	Std. Pack
n/a	325412-1	Surface Mount	1/4" FH	1.08	5 ea
n/a	325430-1	Track Mount Base Only		.10	10 ea
n/a	325472-1	Surface Mount Base Only		.10	10 ea

The Triple Threat™ Rod Holder is your one stop for all your reel styles. Spin, bait cast, or fly reel; this rod holder can handle it all! The quarter turn knob allows for easy adjusting of the angle of the rod with a quick twist. The rear bail facilitates vertical storage of rods while moving from one location to another. Attachment points on the base give you a solid clip point for leashing your rod and reel while paddling in rough conditions. Proudly constructed in the USA of injection molded glass filled nylon.

⚠WARNING: Cancer and Reproductive Harm - www.P65Warnings.ca.gov



TRIPLE THREAT™ ROD HOLDER - TRACK MOUNT

Injection Molded Glass Filled Nylon

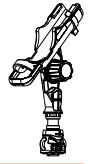

Bulk	Display	Base	Wt.(lb.)	Std. Pack
n/a	325416-1	Track Mount	1.07	5 ea
n/a	325430-1	Track Mount Base Only	.10	10 ea
n/a	325472-1	Surface Mount Base Only	.10	10 ea

The Triple Threat™ Rod Holder is your one stop for all your reel styles. Spin, bait cast, or fly reel; this rod holder can handle it all! The quarter turn knob allows for easy adjusting of the angle of the rod with a quick twist. The rear bail facilitates vertical storage of rods while moving from one location to another. Attachment points on the base give you a solid clip point for leashing your rod and reel while paddling in rough conditions. Proudly constructed in the USA of injection molded glass filled nylon.

⚠WARNING: Cancer and Reproductive Harm - www.P65Warnings.ca.gov

TRIPLE THREAT™ ROD HOLDER - TRACK MOUNT WITH EXTENSION

Injection Molded Glass Filled Nylon

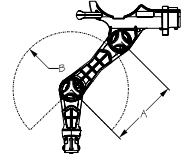

Bulk	Display	A	B	Wt.(lb.)	Std. Pack
n/a	325425-1	6"	245°	1.25	5 ea
n/a	325430-1	Track Mount Base Only		.10	10 ea
n/a	325472-1	Surface Mount Base Only		.10	10 ea

The Triple Threat™ Rod Holder is your one stop for all your reel styles. Spin, bait cast, or fly reel; this rod holder can handle it all! The quarter turn knob allows for easy adjusting of the angle of the rod with a quick twist. The rear bail facilitates vertical storage of rods while moving from one location to another. Attachment points on the base give you a solid clip point for leashing your rod and reel while paddling in rough conditions. Proudly constructed in the USA of injection molded glass filled nylon.

⚠WARNING: Cancer and Reproductive Harm - www.P65Warnings.ca.gov

QUARTER-TURN DECK PLATE WITH INTERNAL COLLAR

Injection Molded ABS

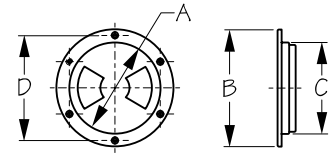

Bulk	Display	A	B	C	D	Color	Lid Texture	Fastener	Wt.(lb.)	Std. Pack
336345	336345-1	4-1/2"	6-1/8"	4-1/2"	5-3/8"	Black	Smooth	#8 FH	.28	10 ea
336355	336355-1	5-1/2"	6-3/4"	5-3/8"	6-1/8"	Black	Smooth	#8 FH	.32	10 ea
336365	336365-1	6-1/2"	8-1/8"	6-1/2"	7-3/8"	Black	Smooth	#8 FH	.41	10 ea
336385	336385-1	8-5/16"	9-7/8"	8-1/4"	8-15/16"	Black	Smooth	#8 FH	.55	10 ea

These Quarter-Turn Deck Plates feature a new locking system that prevents over tightening, jamming, or cross threading. An internal, molded-in collar on the bottom holds deck plate bags or other round containers. When installing, use silicone sealant on hull or deck surface. Keep threads clean with hot, soapy water. Lubricate with Vaseline or Teflon grease. Avoid contact with acetone or strong solvents. Proudly constructed in the USA of UV resistant injection molded ABS. Installs with six #8 FH fasteners (not included).

⚠WARNING: Cancer and Reproductive Harm - www.P65Warnings.ca.gov

TRIPLE LATCH RECTANGULAR MARINE HATCH

Injection Molded Polypropylene

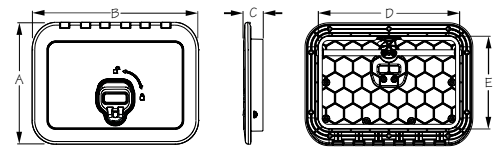

Bulk	Display	A	B	C	D	E	Color	Fastener	Wt.(lb.)	Std. Pack
336520	336520-3	10-1/4"	14"	1-11/16"	11-13/16"	7-3/4"	White	#10 FH	1.92	1 ea
336525	336525-3	10-1/4"	14"	1-11/16"	11-13/16"	7-3/4"	Black	#10 FH	1.92	1 ea

This Triple Latch Marine Deck Hatch features 3 locking points which when engaged cause the camming surface to pull the lid into the gasket creating a water tight seal. Proudly constructed in the USA of injection molded polypropylene with a structural honeycomb lid for superior rigidity and strength. Non-slip textured surface. Can be mounted horizontally or vertically. Full length piano hinge for added strength and security. Interior opening is 11-1/8" X 7" and will accept group 24 series size batteries. Installs with ten #10 FH fasteners (not included). Available in black or white.

⚠WARNING: Cancer and Reproductive Harm - www.P65Warnings.ca.gov

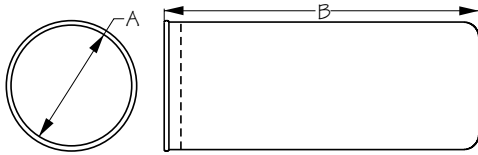

DECK PLATE BAG

Nylon/Stainless Steel Ring



Bulk	Display	A	B	Wt.(lb.)	Std. Pack
n/a	337149R-1	4"	10"	.12	10 ea
n/a	337159R-1	5"	10"	.14	10 ea
n/a	337169R-1	6"	10"	.16	10 ea
n/a	337189R-1	8"	12"	.18	10 ea

Great for keeping your valuables dry while paddling. Fits all Sea-Dog® Deck Plates with Internal Collar. High visibility red color.



SAE POWER CABLE

Injection Molded PVC



Bulk	Display	A (Length)	Volts	Max Amps	Wire Gauge	Wt.(lb.)	Std. Pack
n/a	426901-1	12"	12-24	20A @ 12V	14 AWM	.11	10 ea
n/a	426903-1	36"	12-24	20A @ 12V	14 AWM	.17	10 ea
n/a	426906-1	72"	12-24	20A @ 12V	14 AWM	.26	5 ea
n/a	426912-1	144"	12-24	20A @ 12V	14 AWM	.44	5 ea

SAE type Polarized Electrical Connector is a two-prong plug and socket connector set. 14-gauge duplex wire. Maximum: 20A @ 12VDC.

⚠WARNING: Cancer and Reproductive Harm - www.P65Warnings.ca.gov

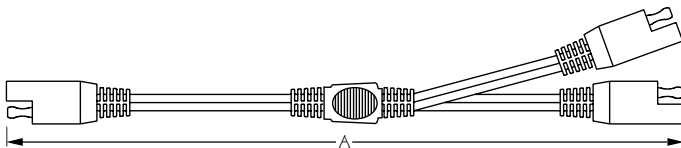

SAE POWER CABLE Y-SPLITTER

Injection Molded PVC



Bulk	Display	A (Length)	Volts	Max Amps	Wire Gauge	Wt.(lb.)	Std. Pack
n/a	426920-1	12"	12-24	20A @ 12V	14 AWM	.15	10 ea

SAE type Polarized Electrical Connector is a two-prong plug and socket Y-splitter connector set. 14-gauge duplex wire. Maximum: 20A @ 12VDC.

⚠WARNING: Cancer and Reproductive Harm - www.P65Warnings.ca.gov

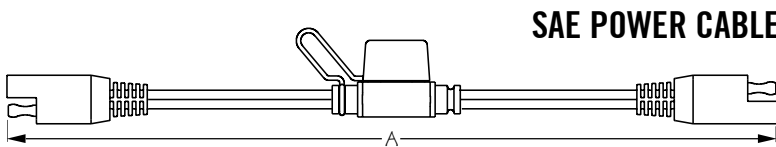

SAE POWER CABLE ATO/ATC INLINE FUSE HOLDER

Injection Molded PVC



Bulk	Display	A (Length)	Volts	Max Amps	Wire Gauge	Wt.(lb.)	Std. Pack
n/a	426925-1	12"	12-24	20A @ 12V	14 AWM	.15	10 ea

SAE type Polarized Electrical Connector is a two-prong plug and socket connector set. Features an ATO/ATC inline fuse holder (fuse not included). 14-gauge duplex wire. Maximum: 20A @ 12VDC.

⚠WARNING: Cancer and Reproductive Harm - www.P65Warnings.ca.gov

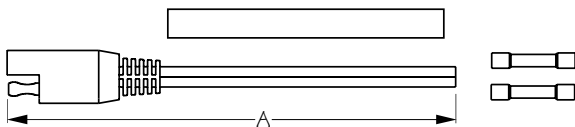

SAE POWER CABLE POWER PLUG KIT

Injection Molded PVC



Bulk	Display	A (Length)	Volts	Max Amps	Wire Gauge	Wt.(lb.)	Std. Pack
n/a	426930-1	6"	12-24	20A @ 12V	14 AWM	.08	10 ea

SAE type Polarized Electrical Plug Kit is a two-prong plug and socket connector set. 14-gauge lead wire with bullet-type contact pins. Includes two plugs, four heat shrink tubes, and four butt connectors allowing you to customize your set per application. Maximum: 20A @ 12VDC.

⚠WARNING: Cancer and Reproductive Harm - www.P65Warnings.ca.gov



SAE POWER SOCKET - FRONT MOUNT

Injection Molded PVC

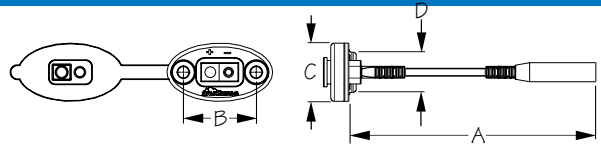

Bulk	Display	A	B	C	D	Volts	Max Amps	Wire Gauge	Wt.(lb.)	Std. Pack
n/a	426950-1	5"	1-1/4"	1"	3/4"	12-24	20A @ 12V	14 AWM	.12	10 ea

SAE type Polarized Electrical Connector is a two-prong power socket connector set. Great for solar panel connections and maintaining battery charge. 14-gauge duplex wire. Drill 3/4" hole and install with two #10 RH screws (not included). Maximum: 20A @ 12VDC.

⚠WARNING: Cancer and Reproductive Harm - www.P65Warnings.ca.gov



SAE POWER SOCKET - BACK NUT MOUNT

Injection Molded PVC

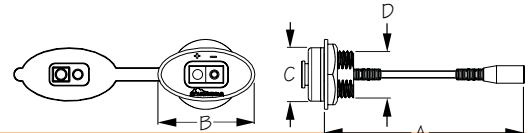

Bulk	Display	A	B	C	D	Volts	Max Amps	Wire Gauge	Wt.(lb.)	Std. Pack
n/a	426955-1	5"	1-13/16"	1"	7/8"	12-24	20A @ 12V	14 AWM	.13	10 ea

SAE type Polarized Electrical Connector is a two-prong power socket connector set. Great for Solar panel connections and maintaining battery charge. 14-gauge duplex wire. Installation is as easy as drilling a 7/8" hole, inserting the socket body, tightening the locking nut and connecting the wires. Maximum: 20A @ 12VDC.

⚠WARNING: Cancer and Reproductive Harm - www.P65Warnings.ca.gov



PERFORMANCE PADDLE CLIP KIT

Injection Molded Nylon/Stainless Steel

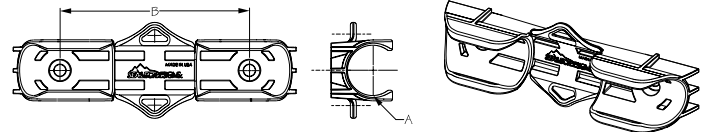

Bulk	Display	A	B	Fastener	Wt.(lb.)	Std. Pack
n/a	491361-9	1-1/8"	4"	1/4" PH	.18	10 kits

This one-piece Performance Paddle Clip allows for simple, one-handed storage of your paddle. Features an anti-snap ramp to prevent line from getting stuck under the clip when not in use, and leash attachment points for securing a paddle leash. Kit includes: Paddle clip (1), 10-32 X 1" PH machine screws (2), 10-32 Nyloc nuts (2), #10 flat washers (2), and #10 well nuts (2). Proudly constructed in the USA of UV resistant injection molded nylon with stainless steel hardware.

⚠WARNING: Cancer and Reproductive Harm - www.P65Warnings.ca.gov



DRAIN PLUG KIT

Injection Molded Nylon

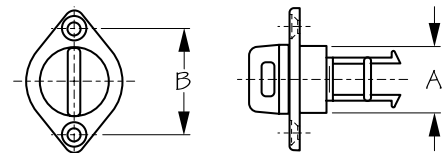

Bulk	Display	A	B	Fasteners Included	Wt.(lb.)	Std. Pack
n/a	520010-9	1"	1-1/2"	Yes	.08	10 kits

This Drain Plug was designed with a molded-in recess in the base to trap sealant to provide a watertight seal. For transom installations, baitwells, ice chests, tanks, etc. Kit includes: Drain plug and base (1), foam gasket (1), 10-32 X 1" OH machine screws (2), 10-32 Nyloc nuts (2), #10 flat washers (2), and #10 well nuts (2). Proudly constructed in the USA of UV resistant injection molded nylon with stainless steel hardware.

⚠WARNING: Cancer and Reproductive Harm - www.P65Warnings.ca.gov



PADDLE & POLE KEEPER KIT

Injection Molded Nylon/Polypropylene



Bulk	Display	Description	Fasteners Included	Wt.(lb.)	Std. Pack
n/a	671400-9	Paddle & Pole Keeper Kit	Yes	.34	5 kits

This Paddle & Pole Keeper Kit lets you easily store your pole or paddle and frees up your hands for other activities! Kit includes: 18" of 1/4" bungee (2), bungee terminal ends w/ sleeve (4), lashing hooks w/ one hole (2), 10-32 X 3/4" PH machine screws (6), 10-32 Nyloc nuts (6), #10 flat washers (6), trifold pop rivets (6), and easy installation instructions. Proudly constructed in the USA of injection molded nylon and polypropylene with stainless steel hardware.

⚠WARNING: Cancer and Reproductive Harm - www.P65Warnings.ca.gov

PULL-UP STRAP HANDLE KIT

Nylon/Stainless Steel



Bulk	Display	Description	Fasteners Included	Wt.(lb.)	Std. Pack
n/a	736470-9	Pull-up Strap Handle Kit	Yes	.75	5 kits

Whether you are looking to fish from a standing position on your sit-on-top kayak, or just need a little assistance getting out of the boat, the Pull-Up Strap Handle Kit can be easily installed on any kayak. Kit includes: Webbing w/ grab loop - 74" X 1" (1), 1" webbing slide (1), stainless steel eye strap (1), 10-32 X 3/4" OH machine screws (2), 10-32 Nyloc nuts (2), and #10 fender washers (2). Constructed of nylon with stainless steel hardware.

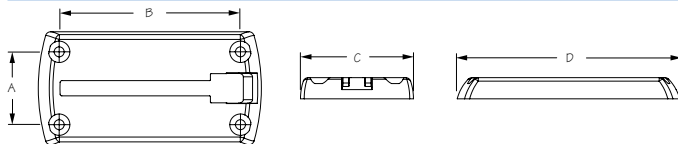

4" TRACK KIT

Polycarbonate



Bulk	Display	A	B	C	D	Color	Fastener	Wt.(lb.)	Std. Pack
n/a	738504-9	1-1/4"	3-1/4"	2"	4"	Black	#8 PH	.10	10 kits

This 4" Track features an industry standard groove for versatile mounting of all your paddling and fishing gear. Proudly constructed in the USA of black polycarbonate. Kit includes: 4" track (1), 8-32 X 1" PH machine screws (4), #8 Nyloc nuts (4), #8 FH washers (4), and #8-32 well nuts (4).

⚠WARNING: Cancer and Reproductive Harm - www.P65Warnings.ca.gov

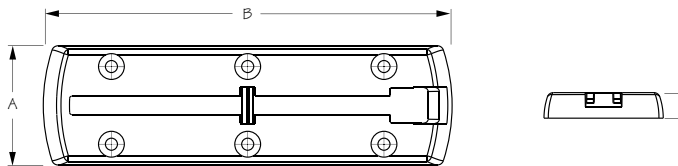

6" TRACK KIT

Polycarbonate



Bulk	Display	A	B	C	Color	Fastener	Wt.(lb.)	Std. Pack
n/a	738506-9	1-3/4"	6"	3/8"	Black	#8 PH	.10	10 kits

This 6" Track features an industry standard groove for versatile mounting of all your paddling and fishing gear. Proudly constructed in the USA of black polycarbonate. Kit includes: 6" track (1), 8-32 X 3/4" PH machine screws (6), #8 Nyloc nuts (6), #8 FH washers (6), and #8-32 well nuts (6).

⚠WARNING: Cancer and Reproductive Harm - www.P65Warnings.ca.gov

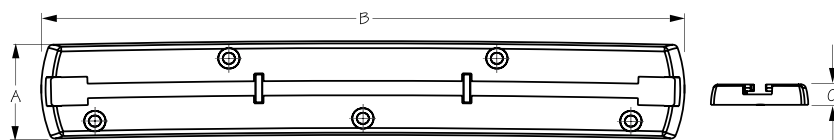

12" CURVED TRACK KIT

Polycarbonate



Bulk	Display	A	B	C	Color	Fastener	Wt.(lb.)	Std. Pack
n/a	738512-9	1-3/4"	12"	3/8"	Black	#8 PH	.10	10 kits

This 12" Curved Track fits the contour of your kayak's gunwale. Features an industry standard groove for versatile mounting of all your paddling and fishing gear. Proudly constructed in the USA of black polycarbonate. Kit includes: 12" curved track (1), 8-32 X 3/4" PH machine screws (6), #8 Nyloc nuts (6), #8 FH washers (6), and #8-32 well nuts (6).

⚠WARNING: Cancer and Reproductive Harm - www.P65Warnings.ca.gov



KAYAK HATCH COVERS - VCP OVAL

Injection Molded Polymer

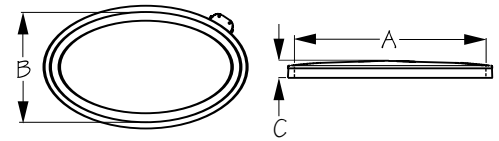

Bulk	Display	Description	A	B	C	Style	Wt.(lb.)	Std. Pack
n/a	745270-1	Lid Only	17-1/4"	2"	10"	Performance	1.30	1 ea

The VCP Oval Hatch Cover is a great as a replacement for lost or damaged lids. This performance hatch features our unique two-part construction for maximum protection. Designed to float when dropped in the water, the hatch lids are easy to attach while still offering a superior watertight seal. Proudly constructed in the USA using the highest-quality injection molded polymer.

Our VCP Oval hatch is compatible with the Valley Canoe Products® (VCP) oval hatch when mounted on an injection molded rim bolted/glued to the deck; not recommended for rotomolded kayaks that do not feature this rim (*Sea-Dog® is not affiliated with Valley Sea Kayaks® and/or Kayak Sport®, reference to these brands only indicates similar sizing of hatch cover products).

⚠WARNING: Cancer and Reproductive Harm - www.P65Warnings.ca.gov



KAYAK HATCH COVERS - 8" VCP ROUND

Injection Molded Polymer

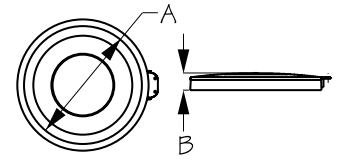

Bulk	Display	Description	A	B	Style	Wt.(lb.)	Std. Pack
n/a	746180-1	Lid Only	8"	1-3/8"	Performance	.55	1 ea

This 8" Round Hatch Cover is a great as a replacement for lost or damaged lids. This performance hatch features our unique two-part construction for maximum protection. Designed to float when dropped in the water and is easy to attach while still offering a superior watertight seal. Proudly constructed in the USA using the highest-quality injection molded polymer.

Compatible with the Valley Canoe Products® (VCP) round day hatch when mounted on an injection molded rim bolted/glued to the deck; not recommended for rotomolded kayaks that do not feature this rim (*Sea-Dog® is not affiliated with Valley Sea Kayaks® and/or Kayak Sport®, reference to these brands only indicates similar sizing of hatch cover products).

⚠WARNING: Cancer and Reproductive Harm - www.P65Warnings.ca.gov



KAYAK ADJUSTABLE FOOTBRACE

Injection Molded Polypropylene/Fiberglass/Nylon

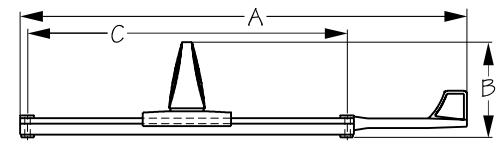

Bulk	Display	A	B	C	Flag	Rod Color	Wt.(lb.)	Std. Pack
n/a	747100B-1	20-1/4"	4-1/4"	14-1/2"	Standard	Black	1.40	5 pr

The Kayak Adjustable Footbrace has 10" of adjustable travel with only the flip of the lever. The two mounting holes (measuring 14-1/2" apart) fit most existing footbrace patterns. The entire unit is designed to be maintenance free and self-cleaning while offering superior strength. In addition, the ergonomically designed pedals are extremely comfortable... even with bare feet. Thru-hole mounting for easy user installation. Proudly constructed in the USA of injection molded polypropylene and glass filled nylon. Patent #7,168,388.

⚠WARNING: Cancer and Reproductive Harm - www.P65Warnings.ca.gov



KAYAK ADJUSTABLE FOOTBRACE

W/ RUDDER CONTROL

Injection Molded Polypropylene/Fiberglass/Nylon



PATENTED

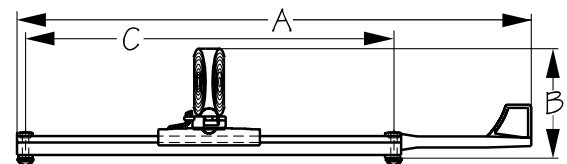
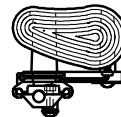

Bulk	Display	A	B	C	Flag	Rod Color	Wt.(lb.)	Std. Pack
n/a	747200B-1	20-1/4"	4-1/4"	14-1/2"	Standard	Black	2.00	5 pr

Our Kayak Adjustable Footbrace w/ Rudder Control offers the same great benefits as its fixed counterpart with the added benefit of rudder control capabilities. One of the easiest footbraces to adjust while on the water. Proudly constructed in the USA of injection molded polypropylene and glass filled nylon.

⚠WARNING: Cancer and Reproductive Harm - www.P65Warnings.ca.gov

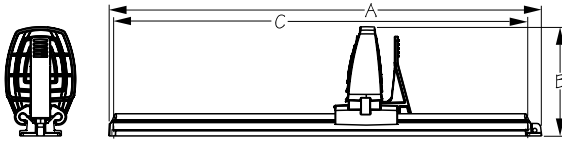

KAYAK RECREATIONAL FOOTBRACE

Injection Molding Polypropylene/Fiberglass/Nylon



Bulk	Display	A	B	C	Fastener Size	Style Type	Wt.(lb.)	Std. Pack
n/a	747520-1	15-5/8"	4-1/4"	14-1/2"	1/4"	Thru Hull	.95	5 pr

The Kayak Recreational Footbrace features superior strength and is designed to be maintenance free. The low profile pedal make installation easy. This footbrace system is a dream for OEM installations and a perfect option for replacement applications. Proudly constructed in the USA of of injection molded polypropylene and glass filled nylon.

▲WARNING: Cancer and Reproductive Harm - www.P65Warnings.ca.gov

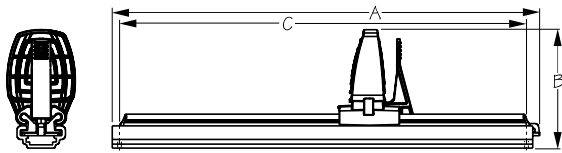

KAYAK RECREATIONAL FOOTBRACE W/ RUDDER CONTROL

Injection Molding Polypropylene/Fiberglass/Nylon



Bulk	Display	A	B	C	Fastener Size	Track Type	Wt.(lb.)	Std. Pack
n/a	747600-1	15-5/8"	4-3/8"	14-1/2"	1/4"	Standard	1.55	5 pr

This Kayak Recreational Footbrace with Rudder Control includes the addition of a channeled track to slide in adding rudder control functionality to our standard Recreational Footbrace. Proudly constructed in the USA of injection molded polypropylene and glass filled nylon.

▲WARNING: Cancer and Reproductive Harm - www.P65Warnings.ca.gov

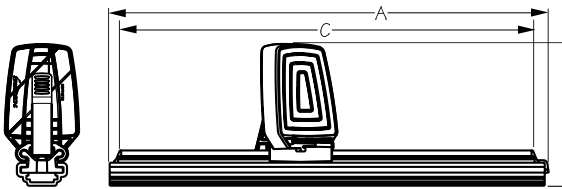

KAYAK RECREATIONAL ANGLED FOOTBRACE W/ RUDDER CONTROL

Injection Molding Polypropylene/Fiberglass/Nylon



Bulk	Display	A	B	C	Fastener Size	Track Type	Wt.(lb.)	Std. Pack
n/a	747650B-1	15-5/8"	4-3/8"	14-1/2"	1/4"	Standard	1.70	5 pr
n/a	747750B-1	Angled Recreational Footbrace Upgrade Kit					.40	8 pr

The Angled Footbrace with rudder control slides are perfect for rudder and motor control steering. The footbraces are designed for sit-on-top kayaks or canoes with a raised seat providing ergonomic and comfortable foot placement. The wider, longer pedal shape is secure and barefoot friendly. With an adjustment range of 11-1/2" they can be set to fit almost anyone. The Angled Foot Pedal upgrade option is interchangeable with any of our Sea-Dog trigger adjusted Recreational Footbraces. Slotted mounting holes accommodating 14-1/8" to 14-5/8" center-to-center applications. Proudly designed and constructed in the USA of injection molded polypropylene and glass filled nylon.



▲WARNING: Cancer and Reproductive Harm - www.P65Warnings.ca.gov

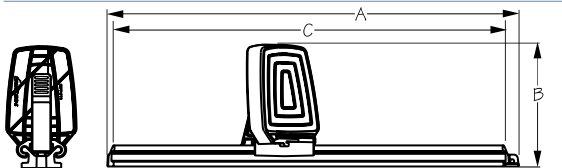

KAYAK RECREATIONAL ANGLED FOOTBRACE

Injection Molding Polypropylene/Fiberglass/Nylon



Bulk	Display	A	B	C	Fastener Size	Style Type	Wt.(lb.)	Std. Pack
n/a	747710B-1	15-5/8"	3-7/8"	14-1/2"	1/4"	Stud Mount	.80	5 pr
n/a	747720B-1	15-5/8"	3-7/8"	14-1/2"	1/4"	Thru Hull	.80	5 pr
n/a	747750B-1	Angled Recreational Footbrace Upgrade Kit					.40	8 pr

The Angled Footbrace is designed for sit-on-top kayaks or canoes with a raised seat providing ergonomic and comfortable foot placement. The wider, longer pedal shape is secure and barefoot friendly. With an adjustment range of 11-1/2" they can be set to fit almost anyone. The Angled Foot Pedal upgrade option is interchangeable with any of our Sea-Dog trigger adjusted Recreational Footbraces. Multiple track options cover most mounting requirements with slotted mounting holes accommodating 14-1/8" to 14-5/8" center-to-center applications. Proudly designed and constructed in the USA of injection molded polypropylene and glass filled nylon.



▲WARNING: Cancer and Reproductive Harm - www.P65Warnings.ca.gov



RUDDER CABLE TUBING KIT

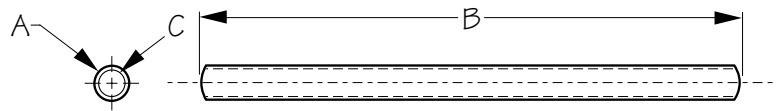

Bulk	Display	A (Tubing Size)	B	C (Inner Dia.)	Color	Wt.(lb.)	Std. Pack
n/a	748010-1	3/16"	15'	5/32"	Black	.20	10 pr

Kit includes: 15' sections of 3/16" rudder cable tubing (2) and 3/16" UL cable clamps (10). Proudly constructed in the USA of nylon.

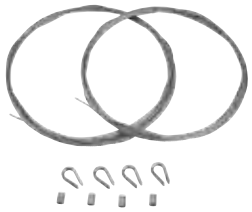

RUDDER CABLE KIT

304 Stainless Steel



Bulk	Display	A (Cable Size)	B	Color	Wt.(lb.)	Std. Pack
n/a	748020-1	1/16"	15'	Steel	.25	10 pr

Kit includes: 15' sections of 1/16" rudder cable (2), thimbles (4), and swedges (4). Constructed of 304 stainless steel.

⚠️WARNING: Cancer and Reproductive Harm - www.P65Warnings.ca.gov



TRUCOURSE™ RUDDER & FOOTBRACE KIT

Injection Molded Polypropylene/Fiberglass/Nylon

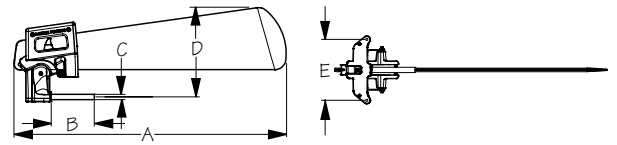

Bulk	Display	A	B	C	D	E	Wt.(lb.)	Std. Pack
n/a	748100-3	17"	3"	3/8"	6-1/4"	4-1/4"	4.00	1 ea

Kit includes Trucourse™ Rudder, Kayak Adjustable Footbrace w/ Rudder Control (747200B-1) and Rudder Rigging Kit. Installation kit includes most items needed to attach a rudder to a kayak with an existing mounting gudgeon, including cable, tubing, pull line, cleats and fasteners. Mounting gudgeons sold separately. Proudly constructed in the USA of injection molded polypropylene and glass filled nylon.

⚠️WARNING: Cancer and Reproductive Harm - www.P65Warnings.ca.gov



TRUCOURSE™ RUDDER MOUNTING GUDGEON (UNIVERSAL BRACKET)

Stamped 304 Stainless Steel

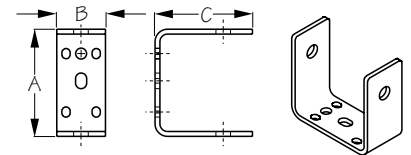

Bulk	Display	A	B	C	Wt.(lb.)	Std. Pack
n/a	748270-1	2-3/4"	1-1/4"	2-1/2"	.30	5 ea

This gudgeon is required to mount our Trucourse™ Rudder to kayaks with pre-tapped mounting holes with screw inserts found on the stern of the kayak (includes Wilderness System®, Necky®, Ocean Kayak®, Emotion®, and more). Constructed of stamped 304 stainless steel.



DECK BUNGEE KIT

Injection Molded Nylon/Polypropylene



Bulk	Display	Description	Fasteners Included	Wt.(lb.)	Std. Pack
n/a	749530-9	Deck Bungee Kit	Yes	.50	5 kits

This kit comes with everything needed to add an additional deck bungee to any kayak. Just set your pattern, drill your holes, tie your knots and you are ready to go. Kit includes: 11' of 1/4" bungee (1), 3/8" pad eyes (6), 8-32 X 3/4" OH machine screws (12), #8-32 Nyloc nuts (12), and #8 flat washers (12). Proudly constructed in the USA of injection molded nylon and polypropylene.

⚠️WARNING: Cancer and Reproductive Harm - www.P65Warnings.ca.gov

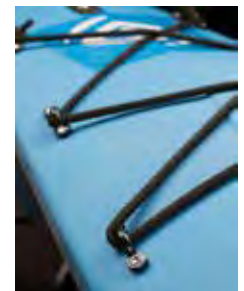

COMING SOON

FROM

SEADOGLINE[®]
QUALITY MARINE GEAR



MADE IN THE USA



PO Box 479
Everett, WA 98206
425-259-0194
425-339-1345
Sea-Dog.com

SEADOGLINE
QUALITY MARINE GEAR