



6

Cordage & Accessories

Anchor Chains

Gas Lift Springs

Hatch Springs

Deck Pipes

Windshield Accessories

Rod Holders

Fillet Tables

Flagpoles

Antenna Bases

Fender Holders

Bow Sockets

Deck & Folding Steps

Bow Rollers

Ladders

Antenna Accessories

Cable Connectors

Anchoring & Deck Hardware



DOCK LINE

Twisted Nylon

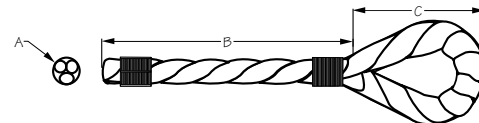

Bulk	Display	A (Dia.)	B (Length)	C (Eye Size)	Color	WLL-kgs/lbs	B.S.-kgs/lbs	Wt.(lb.)	Std. Pack
n/a	301110010BK-1	3/8"	10'	12"	Black	370/815	1850/3750	.35	12 ea
n/a	301110010BL-1	3/8"	10'	12"	Blue	370/815	1850/3750	.35	12 ea
n/a	301110010WH-1	3/8"	10'	12"	White	370/815	1850/3750	.35	12 ea
n/a	301110015BK-1	3/8"	15'	12"	Black	370/815	1850/3750	.40	12 ea
n/a	301110015BL-1	3/8"	15'	12"	Blue	370/815	1850/3750	.40	12 ea
n/a	301110015WH-1	3/8"	15'	12"	White	370/815	1850/3750	.40	12 ea
n/a	301110020BK-1	3/8"	20'	12"	Black	370/815	1850/3750	.45	12 ea
n/a	301110020BL-1	3/8"	20'	12"	Blue	370/815	1850/3750	.45	12 ea
n/a	301110020WH-1	3/8"	20'	12"	White	370/815	1850/3750	.45	12 ea
n/a	301110025BK-1	3/8"	25'	12"	Black	370/815	1850/3750	.50	12 ea
n/a	301110025BL-1	3/8"	25'	12"	Blue	370/815	1850/3750	.50	12 ea
n/a	301110025WH-1	3/8"	25'	12"	White	370/815	1850/3750	.50	12 ea
n/a	301110050WH-1	3/8"	50'	12"	White	370/815	1850/3750	1.00	6 ea
n/a	301112015BK-1	1/2"	15'	12"	Black	415/915	2080/4200	.40	12 ea
n/a	301112015WH-1	1/2"	15'	12"	White	415/915	2080/4200	.40	12 ea
n/a	301112020BK-1	1/2"	20'	12"	Black	415/915	2080/4200	.45	12 ea
n/a	301112020WH-1	1/2"	20'	12"	White	415/915	2080/4200	.45	12 ea
n/a	301112025BK-1	1/2"	25'	12"	Black	415/915	2080/4200	.50	12 ea
n/a	301112025WH-1	1/2"	25'	12"	White	415/915	2080/4200	.50	12 ea
n/a	301112035BK-1	1/2"	35'	12"	Black	415/915	2080/4200	.55	6 ea
n/a	301112035WH-1	1/2"	35'	12"	White	415/915	2080/4200	.55	6 ea
n/a	301112050WH-1	1/2"	50'	12"	White	415/915	2080/4200	1.00	6 ea
n/a	301116020BK-1	5/8"	20'	15"	Black	900/1980	4500/9100	.50	6 ea
n/a	301116020WH-1	5/8"	20'	15"	White	900/1980	4500/9100	.50	6 ea
n/a	301116025BK-1	5/8"	25'	15"	Black	900/1980	4500/9100	.55	6 ea
n/a	301116025WH-1	5/8"	25'	15"	White	900/1980	4500/9100	.55	6 ea
n/a	301116035BK-1	5/8"	35'	15"	Black	900/1980	4500/9100	.60	6 ea
n/a	301116035WH-1	5/8"	35'	15"	White	900/1980	4500/9100	.60	6 ea
n/a	301116050BK-1	5/8"	50'	15"	Black	900/1980	4500/9100	.75	4 ea
n/a	301119025BK-1	3/4"	25'	18"	Black	1060/2330	5300/10700	.60	6 ea
n/a	301119035BK-1	3/4"	35'	18"	Black	1060/2330	5300/10700	.65	6 ea
n/a	301119050BK-1	3/4"	50'	18"	Black	1060/2330	5300/10700	.85	2 ea

Twisted Nylon Dock Lines

- 100% premium twisted three-strand nylon
- High strength with superior stretch for the shock loads of boat wakes and harbor surges
- Superior abrasion resistance to counteract chafe
- Professionally hand-spliced with five tucks
- Yacht whipped at the bitter end and splice point
- All lines are medium lay
- Comes in an attractive, reusable clamshell package



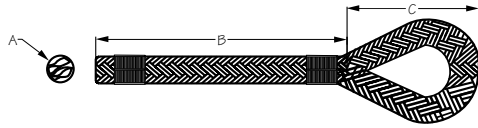

PREMIUM DOCK LINE

Double Braided Nylon



Bulk	Display	A (Dia.)	B (Length)	C (Eye Size)	Color	WLL-kgs/lbs	B.S.-kgs/lbs	Wt.(lb.)	Std. Pack
n/a	302110010BK-1	3/8"	10'	12"	Black	376/825	1880/3800	.35	12 ea
n/a	302110010BL-1	3/8"	10'	12"	Blue	376/825	1880/3800	.35	12 ea
n/a	302110010G/W-1	3/8"	10'	12"	Gold/White	376/825	1880/3800	.35	12 ea
n/a	302110010GY-1	3/8"	10'	12"	Gray	376/825	1880/3800	.35	12 ea
n/a	302110010NV-1	3/8"	10'	12"	Navy	376/825	1880/3800	.35	12 ea
n/a	302110010WH-1	3/8"	10'	12"	White	376/825	1880/3800	.35	12 ea
n/a	302110015BK-1	3/8"	15'	12"	Black	376/825	1880/3800	.45	12 ea
n/a	302110015BL-1	3/8"	15'	12"	Blue	376/825	1880/3800	.45	12 ea
n/a	302110015G/W-1	3/8"	15'	12"	Gold/White	376/825	1880/3800	.45	12 ea
n/a	302110015GY-1	3/8"	15'	12"	Gray	376/825	1880/3800	.45	12 ea
n/a	302110015NV-1	3/8"	15'	12"	Navy	376/825	1880/3800	.45	12 ea
n/a	302110015RD-1	3/8"	15'	12"	Red	376/825	1880/3800	.45	12 ea
n/a	302110015WH-1	3/8"	15'	12"	White	376/825	1880/3800	.45	12 ea
n/a	302110020BK-1	3/8"	20'	12"	Black	376/825	1880/3800	.50	12 ea
n/a	302110020BL-1	3/8"	20'	12"	Blue	376/825	1880/3800	.50	12 ea
n/a	302110020G/W-1	3/8"	20'	12"	Gold/White	376/825	1880/3800	.50	12 ea
n/a	302110020GY-1	3/8"	20'	12"	Gray	376/825	1880/3800	.50	12 ea
n/a	302110020NV-1	3/8"	20'	12"	Navy	376/825	1880/3800	.50	12 ea
n/a	302110020RD-1	3/8"	20'	12"	Red	376/825	1880/3800	.50	12 ea
n/a	302110020WH-1	3/8"	20'	12"	White	376/825	1880/3800	.50	12 ea
n/a	302110025BK-1	3/8"	25'	12"	Black	376/825	1880/3800	.55	12 ea
n/a	302110025BL-1	3/8"	25'	12"	Blue	376/825	1880/3800	.55	12 ea
n/a	302110025G/W-1	3/8"	25'	12"	Gold/White	376/825	1880/3800	.55	12 ea
n/a	302110025GY-1	3/8"	25'	12"	Gray	376/825	1880/3800	.55	12 ea
n/a	302110025NV-1	3/8"	25'	12"	Navy	376/825	1880/3800	.55	12 ea
n/a	302110025RD-1	3/8"	25'	12"	Red	376/825	1880/3800	.55	12 ea
n/a	302110025WH-1	3/8"	25'	12"	White	376/825	1880/3800	.55	12 ea
n/a	302110050BK-1	3/8"	50'	12"	Black	376/825	1880/3800	.65	6 ea
n/a	302112010BK-1	1/2"	10'	12"	Black	438/960	2190/4400	.45	12 ea
n/a	302112010G/W-1	1/2"	10'	12"	Gold/White	438/960	2190/4400	.45	12 ea
n/a	302112010NV-1	1/2"	10'	12"	Navy	438/960	2190/4400	.45	12 ea
n/a	302112010WH-1	1/2"	10'	12"	White	438/960	2190/4400	.45	12 ea
n/a	302112015BK-1	1/2"	15'	12"	Black	438/960	2190/4400	.50	12 ea
n/a	302112015BL-1	1/2"	15'	12"	Blue	438/960	2190/4400	.50	12 ea
n/a	302112015G/W-1	1/2"	15'	12"	Gold/White	438/960	2190/4400	.50	12 ea
n/a	302112015GY-1	1/2"	15'	12"	Gray	438/960	2190/4400	.50	12 ea
n/a	302112015NV-1	1/2"	15'	12"	Navy	438/960	2190/4400	.50	12 ea
n/a	302112015RD-1	1/2"	15'	12"	Red	438/960	2190/4400	.50	12 ea
n/a	302112015WH-1	1/2"	15'	12"	White	438/960	2190/4400	.50	12 ea
n/a	302112020BK-1	1/2"	20'	12"	Black	438/960	2190/4400	.55	12 ea
n/a	302112020BL-1	1/2"	20'	12"	Blue	438/960	2190/4400	.55	12 ea
n/a	302112020G/W-1	1/2"	20'	12"	Gold/White	438/960	2190/4400	.55	12 ea
n/a	302112020GY-1	1/2"	20'	12"	Gray	438/960	2190/4400	.55	12 ea
n/a	302112020NV-1	1/2"	20'	12"	Navy	438/960	2190/4400	.55	12 ea
n/a	302112020RD-1	1/2"	20'	12"	Red	438/960	2190/4400	.55	12 ea
n/a	302112020WH-1	1/2"	20'	12"	White	438/960	2190/4400	.55	12 ea
n/a	302112025BK-1	1/2"	25'	12"	Black	438/960	2190/4400	.60	12 ea
n/a	302112025BL-1	1/2"	25'	12"	Blue	438/960	2190/4400	.60	12 ea
n/a	302112025G/W-1	1/2"	25'	12"	Gold/White	438/960	2190/4400	.60	12 ea
n/a	302112025NV-1	1/2"	25'	12"	Navy	438/960	2190/4400	.60	12 ea
n/a	302112025RD-1	1/2"	25'	12"	Red	438/960	2190/4400	.60	12 ea
n/a	302112025WH-1	1/2"	25'	12"	White	438/960	2190/4400	.60	12 ea
n/a	302112030BK-1	1/2"	30'	12"	Black	438/960	2190/4400	.65	12 ea
n/a	302112030G/W-1	1/2"	30'	12"	Gold/White	438/960	2190/4400	.65	12 ea
n/a	302112030WH-1	1/2"	30'	12"	White	438/960	2190/4400	.65	12 ea
n/a	302112035BK-1	1/2"	35'	12"	Black	438/960	2190/4400	.68	12 ea
n/a	302112035G/W-1	1/2"	35'	12"	Gold/White	438/960	2190/4400	.68	12 ea



More SKUs on Next Page...

PREMIUM DOCK LINE (continued)

Double Braided Nylon

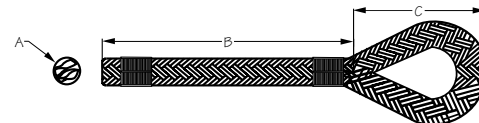

Bulk	Display	A (Dia.)	B (Length)	C (Eye Size)	Color	WLL-kgs/lbs	B.S.-kgs/lbs	Wt.(lb.)	Std. Pack
n/a	302112035NV-1	1/2"	35'	12"	Navy	438/960	2190/4400	.68	12 ea
n/a	302112035WH-1	1/2"	35'	12"	White	438/960	2190/4400	.68	12 ea
n/a	302112050BK-1	1/2"	50'	12"	Black	438/960	2190/4400	.75	6 ea
n/a	302116015BK-1	5/8"	15'	15"	Black	927/2045	4650/9400	.60	6 ea
n/a	302116015G/W-1	5/8"	15'	15"	Gold/White	927/2045	4650/9400	.60	6 ea
n/a	302116015NV-1	5/8"	15'	15"	Navy	927/2045	4650/9400	.60	6 ea
n/a	302116015WH-1	5/8"	15'	15"	White	927/2045	4650/9400	.60	6 ea
n/a	302116020BK-1	5/8"	20'	15"	Black	927/2045	4650/9400	.60	6 ea
n/a	302116020G/W-1	5/8"	20'	15"	Gold/White	927/2045	4650/9400	.60	6 ea
n/a	302116020NV-1	5/8"	20'	15"	Navy	927/2045	4650/9400	.60	6 ea
n/a	302116020WH-1	5/8"	20'	15"	White	927/2045	4650/9400	.60	6 ea
n/a	302116025BK-1	5/8"	25'	15"	Black	927/2045	4650/9400	.65	6 ea
n/a	302116025G/W-1	5/8"	25'	15"	Gold/White	927/2045	4650/9400	.65	6 ea
n/a	302116025WH-1	5/8"	25'	15"	White	927/2045	4650/9400	.65	6 ea
n/a	302116030BK-1	5/8"	30'	15"	Black	927/2045	4650/9400	.70	6 ea
n/a	302116030G/W-1	5/8"	30'	15"	Gold/White	927/2045	4650/9400	.70	6 ea
n/a	302116030NV-1	5/8"	30'	15"	Navy	927/2045	4650/9400	.70	6 ea
n/a	302116030WH-1	5/8"	30'	15"	White	927/2045	4650/9400	.70	6 ea
n/a	302116035BK-1	5/8"	35'	15"	Black	927/2045	4650/9400	.75	6 ea
n/a	302116035G/W-1	5/8"	35'	15"	Gold/White	927/2045	4650/9400	.75	6 ea
n/a	302116035NV-1	5/8"	35'	15"	Navy	927/2045	4650/9400	.75	6 ea
n/a	302116035WH-1	5/8"	35'	15"	White	927/2045	4650/9400	.75	6 ea
n/a	302116050BK-1	5/8"	50'	15"	Black	927/2045	4650/9400	.75	6 ea
n/a	302116050WH-1	5/8"	50'	15"	White	927/2045	4650/9400	.75	6 ea
n/a	302119025BK-1	3/4"	25'	18"	Black	1104/2430	5520/11200	.70	6 ea
n/a	302119025G/W-1	3/4"	25'	18"	Gold/White	1104/2430	5520/11200	.70	6 ea
n/a	302119025WH-1	3/4"	25'	18"	White	1104/2430	5520/11200	.70	6 ea
n/a	302119030BK-1	3/4"	30'	18"	Black	1104/2430	5520/11200	.75	6 ea
n/a	302119035BK-1	3/4"	35'	18"	Black	1104/2430	5520/11200	.80	6 ea
n/a	302119035G/W-1	3/4"	35'	18"	Gold/White	1104/2430	5520/11200	.80	6 ea
n/a	302119035WH-1	3/4"	35'	18"	White	1104/2430	5520/11200	.80	6 ea
n/a	302119050BK-1	3/4"	50'	18"	Black	1104/2430	5520/11200	.90	6 ea

Double Braided Nylon Dock Lines

- 100% premium double braided nylon
- Professionally spliced soft eye at one end
- Yacht whipped at the bitter end and splice point
- Available in a wide range of colors and sizes
- Comes in an attractive, reusable clamshell package



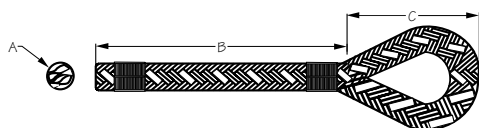

PREMIUM DOCK LINE WITH REFLECTIVE TRACER

Double Braided Nylon



Bulk	Display	A (Dia.)	B (Length)	C (Eye Size)	Color	WLL-kgs/lbs	B.S.-kgs/lbs	Wt.(lb.)	Std. Pack
n/a	302110010BKT-1	3/8"	10'	12"	Black	376/825	1880/3800	.35	12 ea
n/a	302110010G/WT-1	3/8"	10'	12"	Gold/White	376/825	1880/3800	.35	12 ea
n/a	302110015BKT-1	3/8"	15'	12"	Black	376/825	1880/3800	.45	12 ea
n/a	302110015G/WT-1	3/8"	15'	12"	Gold/White	376/825	1880/3800	.45	12 ea
n/a	302110020BKT-1	3/8"	20'	12"	Black	376/825	1880/3800	.50	12 ea
n/a	302110020G/WT-1	3/8"	20'	12"	Gold/White	376/825	1880/3800	.50	12 ea
n/a	302112010BKT-1	1/2"	10'	12"	Black	438/960	2190/4400	.45	12 ea
n/a	302112010G/WT-1	1/2"	10'	12"	Gold/White	438/960	2190/4400	.45	12 ea
n/a	302112015BKT-1	1/2"	15'	12"	Black	438/960	2190/4400	.50	12 ea
n/a	302112015G/WT-1	1/2"	15'	12"	Gold/White	438/960	2190/4400	.50	12 ea
n/a	302112020BKT-1	1/2"	20'	12"	Black	438/960	2190/4400	.55	12 ea
n/a	302112020G/WT-1	1/2"	20'	12"	Gold/White	438/960	2190/4400	.55	12 ea
n/a	302116015BKT-1	5/8"	15'	15"	Black	927/2045	4650/9400	.60	6 ea
n/a	302116015G/WT-1	5/8"	15'	15"	Gold/White	927/2045	4650/9400	.60	6 ea
n/a	302116020BKT-1	5/8"	20'	15"	Black	927/2045	4650/9400	.60	6 ea
n/a	302116020G/WT-1	5/8"	20'	15"	Gold/White	927/2045	4650/9400	.60	6 ea

Double Braided Nylon Dock Lines with Tracer

- 100% premium double braided nylon
- Reflective tracers, visible up to 200 ft.
- Professionally spliced soft eye
- Yacht whipped at the bitter end and splice point
- High-capacity tensile strength and excellent shock absorption capabilities
- Resistant to rot, abrasion, mildew, oil, and UV rays
- Can be stored wet or dry
- Comes in an attractive, reusable clamshell package

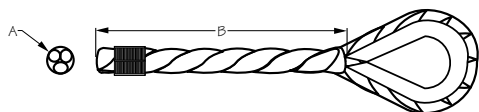

ANCHOR LINE

Twisted Nylon



Bulk	Display	A (Dia.)	B (Length)	Color	WLL-kgs/lbs	B.S.-kgs/lbs	Wt.(lb.)	Std. Pack
n/a	301110060WH-1	3/8"	60'	White	370/815	1850/3750	1.10	6 ea
n/a	301110100WH-1	3/8"	100'	White	370/815	1850/3750	1.25	6 ea
n/a	301110150WH-1	3/8"	150'	White	370/815	1850/3750	1.50	4 ea
n/a	301110200WH-1	3/8"	200'	White	370/815	1850/3750	1.75	4 ea
n/a	301112100WH-1	1/2"	100'	White	415/915	2080/4200	2.00	4 ea
n/a	301112150WH-1	1/2"	150'	White	415/915	2080/4200	2.50	2 ea
n/a	301112200WH-1	1/2"	200'	White	415/915	2080/4200	3.00	2 ea
n/a	301116200WH-1	5/8"	200'	White	900/980	4500/9100	3.50	1 ea

Twisted Nylon Anchor Line

- 100% premium twisted three-strand nylon
- Excellent flexibility, stretches to absorb shock
- Medium lay with a soft feel
- 304 Stainless steel thimble
- Professionally spliced with five tucks
- Yacht whipped at the bitter end
- Packaged on an easy to dispense spool



PREMIUM ANCHOR LINE

Double Braided Nylon

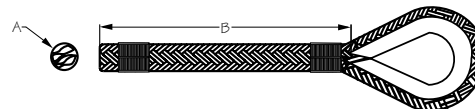

Bulk	Display	A (Dia.)	B (Length)	Color	WLL-kgs/lbs	B.S.-kgs/lbs	Wt.(lb.)	Std. Pack
n/a	302110060G/W-1	3/8"	60'	Gold/White	376/825	1880/3800	1.90	1 ea
n/a	302110100G/W-1	3/8"	100'	Gold/White	376/825	1880/3800	2.20	4 ea
n/a	302110150G/W-1	3/8"	150'	Gold/White	376/825	1880/3800	3.30	4 ea
n/a	302110200G/W-1	3/8"	200'	Gold/White	376/825	1880/3800	4.40	2 ea
n/a	302110250G/W-1	3/8"	250'	Gold/White	376/825	1880/3800	5.00	4 ea
n/a	302112060G/W-1	1/2"	60'	Gold/White	438/960	2190/4400	3.00	1 ea
n/a	302112100G/W-1	1/2"	100'	Gold/White	438/960	2190/4400	3.30	4 ea
n/a	302112150G/W-1	1/2"	150'	Gold/White	438/960	2190/4400	4.40	2 ea
n/a	302112200G/W-1	1/2"	200'	Gold/White	438/960	2190/4400	5.25	2 ea
n/a	302112250G/W-1	1/2"	250'	Gold/White	438/960	2190/4400	5.60	1 ea
n/a	302112300G/W-1	1/2"	300'	Gold/White	438/960	2190/4400	6.00	1 ea

Double Braided Nylon Anchor Line

- 100% premium double braided nylon
- Excellent flexibility, stretches to absorb shock
- Medium lay with a soft feel
- 304 Stainless steel thimble
- Professionally spliced
- Yacht whipped at bitter end and thimble splice point
- Packaged on an easy to dispense spool



ANCHOR LINE WITH SNAP

Hollow Braided Polypropylene

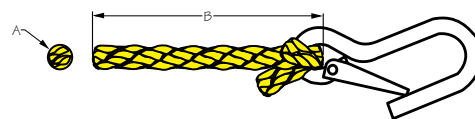

Bulk	Display	A (Dia.)	B (Length)	Color	WLL-kgs/lbs	B.S.-kgs/lbs	Wt.(lb.)	Std. Pack
n/a	304206050YW-1	1/4"	50'	Yellow	104/230	520/1050	.75	12 ea
n/a	304206100YW-1	1/4"	100'	Yellow	104/230	520/1050	1.50	12 ea
n/a	304210075YW-1	3/8"	75'	Yellow	268/590	1340/2700	1.25	12 ea
n/a	304210100YW-1	3/8"	100'	Yellow	268/590	1340/2700	1.50	12 ea

Hollow Braid Anchor Line with Snap

- 100% premium multi-filament polypropylene floating rope
- Plated steel Spring Hook (155630)
- Packaged in a reusable clamshell pack (304206050YW-1) or easy to dispense spool

⚠WARNING: Cancer and Reproductive Harm - www.P65Warnings.ca.gov



BUNGEE DOCK LINE

Polypropylene/Natural Rubber/Polyester Cover

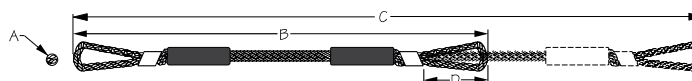

Bulk	Display	A (Dia.)	B	C	D (Eye Size)	Color	Wt.(lb.)	Std. Pack
n/a	306204-1	3/8"	4'	5-1/2'	7"	Black	.65	12 pr
n/a	306205-1	3/8"	5'	7'	7"	Black	.79	12 pr
n/a	306206-1	3/8"	6'	9'	7"	Black	.92	6 pr
n/a	306254-1	3/8"	4'	5-1/2'	7"	White	.65	12 pr
n/a	306255-1	3/8"	5'	7'	7"	White	.79	12 pr
n/a	306256-1	3/8"	6'	9'	7"	White	.92	6 pr

Bungee dock lines have adjustable eye's with rubber chafe protectors and mesh covered bungee centers. Designed to be used in combination with standard dock lines.

⚠WARNING: Cancer and Reproductive Harm - www.P65Warnings.ca.gov

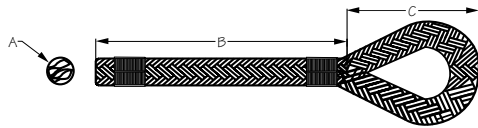

PREMIUM FENDER LINE

Double Braided Nylon



Bulk	Display	A (Dia.)	B (Length)	C (Eye Size)	Color	WLL-kgs/lbs	B.S.-kgs/lbs	Wt.(lb.)	Std. Pack
n/a	302106006BK-1	1/4"	6'	2"	Black	132/290	660/1330	.64	12 pr
n/a	302106006BL-1	1/4"	6'	2"	Blue	132/290	660/1330	.64	12 pr
n/a	302106006G/W-1	1/4"	6'	2"	Gold/White	132/290	660/1330	.64	12 pr
n/a	302106006GY-1	1/4"	6'	2"	Gray	132/290	660/1330	.64	12 pr
n/a	302106006NV-1	1/4"	6'	2"	Navy	132/290	660/1330	.64	12 pr
n/a	302106006RD-1	1/4"	6'	2"	Red	132/290	660/1330	.64	12 pr
n/a	302106006WH-1	1/4"	6'	2"	White	132/290	660/1330	.64	12 pr
n/a	302110006BK-1	3/8"	6'	3"	Black	376/825	1880/3800	.64	12 pr
n/a	302110006BL-1	3/8"	6'	3"	Blue	376/825	1880/3800	.64	12 pr
n/a	302110006G/W-1	3/8"	6'	3"	Gold/White	376/825	1880/3800	.64	12 pr
n/a	302110006GY-1	3/8"	6'	3"	Gray	376/825	1880/3800	.64	12 pr
n/a	302110006NV-1	3/8"	6'	3"	Navy	376/825	1880/3800	.64	12 pr
n/a	302110006RD-1	3/8"	6'	3"	Red	376/825	1880/3800	.64	12 pr
n/a	302110006WH-1	3/8"	6'	3"	White	376/825	1880/3800	.64	12 pr

Double Braided Fender Line

- 100% premium double braided nylon
- Professional double braided nylon splice
- Yacht whipped at bitter end and splice point
- Sold in pairs

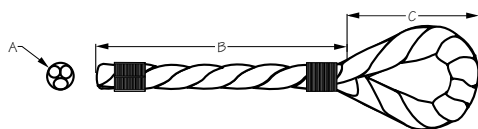

FENDER LINE

Twisted Nylon



Bulk	Display	A (Dia.)	B (Length)	C (Eye Size)	Color	WLL-kgs/lbs	B.S.-kgs/lbs	Wt.(lb.)	Std. Pack
n/a	301106006WH-1	1/4"	6'	2"	White	124/275	620/1250	.64	12 pr
n/a	301106008WH-1	3/8"	8'	3"	White	370/815	1850/3750	.75	12 pr

Twisted Nylon Fender Line

- 100% premium twisted three-strand nylon
- Professionally spliced with five tucks
- Yacht whipped at bitter end and splice point
- Sold in pairs

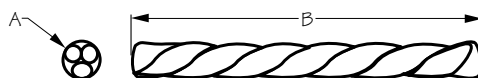

BULK CORDAGE

Twisted Nylon



Bulk	Display	A (Dia.)	B (Length)	Color	WLL-kgs/lbs	B.S.-kgs/lbs	Wt.(lb.)	Std. Pack
301106600WH	n/a	1/4"	600'	White	124/275	620/1250	5.00	1 ea
301110600WH	n/a	3/8"	600'	White	370/815	1850/3750	6.00	1 ea
301112600WH	n/a	1/2"	600'	White	415/915	2080/4200	8.00	1 ea

Twisted Nylon Bulk Cordage

- 100% premium twisted nylon
- Packaged on an easy to dispense spool



PREMIUM BULK CORDAGE

Double Braided Nylon



Bulk	Display	A (Dia.)	B (Length)	Color	WLL-kgs/lbs	B.S.-kgs/lbs	Wt.(lb.)	Std. Pack
302106600BK	n/a	1/4"	600'	Black	132/290	680/1375	5.00	2 ea
302106600G/W	n/a	1/4"	600'	Gold/White	132/290	680/1375	5.00	2 ea
302106600WH	n/a	1/4"	600'	White	132/290	680/1375	5.00	2 ea
302110600BK	n/a	3/8"	600'	Black	376/825	1880/3800	6.60	1 ea
302110600G/W	n/a	3/8"	600'	Gold/White	376/825	1880/3800	6.60	1 ea
302110600NV	n/a	3/8"	600'	Navy	376/825	1880/3800	6.60	1 ea
302110600WH	n/a	3/8"	600'	White	376/825	1880/3800	6.60	1 ea
302112600BK	n/a	1/2"	600'	Black	438/960	2190/4430	14.40	1 ea
302112600G/W	n/a	1/2"	600'	Gold/White	438/960	2190/443	14.40	1 ea
302112600NV	n/a	1/2"	600'	Navy	438/960	2190/443	14.40	1 ea
302112600WH	n/a	1/2"	600'	White	438/960	2190/443	14.40	1 ea
302116600G/W	n/a	5/8"	600'	Gold/White	927/2045	4650/9400	15.60	1 ea
302119600G/W	n/a	3/4"	600'	Gold/White	1104/2430	5520/11175	16.80	1 ea

Double Braided Nylon Bulk Cordage

- 100% premium double braided nylon
- Packaged on an easy to dispense spool



BULK CORDAGE

Solid Braided Nylon



Bulk	Display	A (Dia.)	B (Length)	Color	WLL-kgs/lbs	B.S.-kgs/lbs	Wt.(lb.)	Std. Pack
303105999WH	n/a	3/16"	1,000'	White	50/110	252/510	12.0	2 ea
303106500WH	n/a	1/4"	500'	White	132/290	660/1330	10.0	2 ea
303108500WH	n/a	5/16"	500'	White	230/500	1150/2330	11.0	1 ea
303110500WH	n/a	3/8"	500'	White	382/840	1910/3865	12.5	1 ea
303112500WH	n/a	1/2"	500'	White	410/900	2050/4150	13.0	1 ea

Solid Braided Nylon Bulk Cordage

- 100% premium solid braided nylon
- Packaged on an easy to dispense spool



BULK CORDAGE

Twisted Polypropylene



Bulk	Display	A (Dia.)	B (Length)	Color	WLL-kgs/lbs	B.S.-kgs/lbs	Wt.(lb.)	Std. Pack
301206600YW	n/a	1/4"	600'	Yellow	104/230	520/1050	5.00	4 ea
301210600YW	n/a	3/8"	600'	Yellow	268/590	1340/2710	6.50	1 ea
301212600YW	n/a	1/2"	600'	Yellow	368/810	1840/3725	7.00	1 ea

Bulk Cordage

- Twisted polypropylene floating rope
- Excellent resistance to most common chemicals
- Resistant to rot, mildew, and degradation
- Good abrasion and UV resistance
- Good strength properties with moderate stretch
- Additional colors and combinations available
- Packaged on an easy to dispense spool

⚠WARNING: Cancer and Reproductive Harm - www.P65Warnings.ca.gov

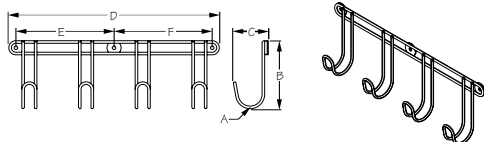

ROPE & ACCESSORY HANGER

304 Stainless Steel

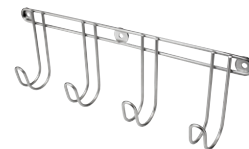

Bulk	Display	A	B	C	D	E	F	Wt.(lb.)	Std. Pack
n/a	300085-1	1-3/4"	5-1/4"	2-1/2"	16"	7-3/8"	7-3/8"	.88	1 ea



This wall mounted Rope & Accessory Hanger is a great storage management solution. Ideal for the organization of ropes, water hoses, extension cords, etc. Deep hooks keep line in place even when heeling over. Constructed of corrosion resistant 304 stainless steel. Installs with three 1/4" RH fasteners (not included).

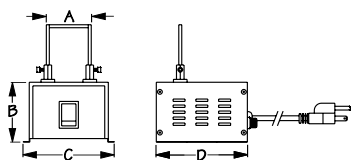

ROPE CUTTER

Powder Coated Steel



Bulk	Display	A	B	C	D	Volts	Wt.(lb.)	Std. Pack	
n/a	300090-3	2-1/4"	3-1/8"	4-13/16"	4-5/8"	120	3.34	1 ea	
n/a	300091-1	Replacement Blade						.05	1 ea

This bench top Rope Cutter easily cuts and heat seals nylon, polyester, polypropylene, and Dacron cordage and webbing. The replaceable blade heats up to 1100° Fahrenheit (600° Celsius) in 10 seconds. Includes brass bristle cleaning brush and T-handle Allen wrench for installing the replaceable blade. Features a 40" heavy duty grounded cord and a lighted on/off rocker switch. Base is pre-drilled for permanent mounting on a bench or table. 120VAC @ 50W. ETL certified #5002516.

⚠WARNING: Cancer and Reproductive Harm - www.P65Warnings.ca.gov

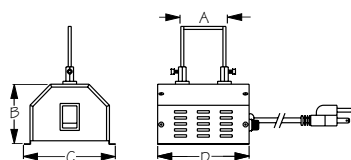

QUICK CUT BENCH TOP ROPE CUTTER

Powder Coated Steel



Bulk	Display	A	B	C	D	Volts	Wt.(lb.)	Std. Pack	
n/a	300092-3	2-1/4"	3-1/8"	4-13/16"	4-13/16"	120	3.15	1 ea	
n/a	300091-1	Replacement Blade						.05	1 ea

This Quick Cut Bench Top Rope Cutter easily cuts and heat seals nylon, polyester, polypropylene, and Dacron cordage and webbing. The replaceable blade heats up to 1000° Fahrenheit (500° Celsius) in 10 seconds. Includes brass bristle cleaning brush and T-handle Allen wrench for installing the replaceable blade. Features a 39" heavy duty grounded cord and a lighted on/off rocker switch. Base is pre-drilled for permanent mounting on a bench or table. 120VAC @ 30W. ETL certified #5002516.

⚠WARNING: Cancer and Reproductive Harm - www.P65Warnings.ca.gov

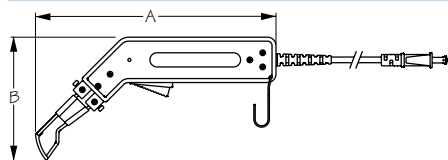

DELUXE HANDHELD ROPE CUTTER

Steel/Plastic



Bulk	Display	A	B	Max Rope Size	Volts	Wt.(lb.)	Std. Pack	
n/a	300095-3	10-1/2"	5-1/2"	1"	120	3.80	1 ea	
n/a	300096-1	Replacement Blade						.05

This Deluxe Handheld Rope Cutter easily cuts and heat seals nylon, polyester, polypropylene, and Dacron cordage and webbing. Replaceable blade heats to 1100° Fahrenheit (600° Celsius) in 10 seconds. Includes brass bristle cleaning brush, T-handle Allen wrench, and carrying case. 10' heavy duty grounded cord. 120V. ETL listed.

⚠WARNING: Cancer and Reproductive Harm - www.P65Warnings.ca.gov



ECONOMY HANDHELD ROPE CUTTER & SOLDERING GUN

Steel/Plastic

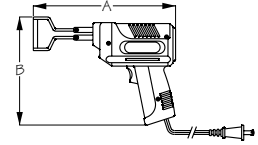

Bulk	Display	A	B	Max Rope Size	Volts	Wt.(lb.)	Std. Pack
n/a	300097-3	9-1/4"	6-3/4"	1-3/4"	120	1.65	1 ea
n/a	300098-1	Replacement Blade				.05	1 ea

This Economy Handheld Rope Cutter & Soldering Gun can easily cut and heat seal nylon, polyester, polypropylene, and Dacron cordage and webbing. Replaceable blade heats to 700° Fahrenheit (400° Celsius). Includes replaceable blade and soldering tip. 4' cord. 100W, 120VAC. UL listed.

⚠WARNING: Cancer and Reproductive Harm - www.P65Warnings.ca.gov



UTILITY CORDAGE

Solid Braid Polyester Cord



Bulk	Display	Description	A (Dia.)	B (Length)	Color	WLL-kgs/lbs	B.S.-kgs/lbs	Wt.(lb.)	Std. Pack
n/a	303303050WH-1	Hank	1/8"	50'	White	22/50	110/225	.50	12 ea
n/a	303304050-1	Hank	5/32"	50'	White	50/110	252/510	.60	12 ea
n/a	303305050-1	Hank	3/16"	50'	White	132/290	660/1330	.75	12 ea

Utility Cordage

- Solid braid polyester cord
- Mildew and rot resistant
- Excellent for many quick tie and flag halyard applications

⚠WARNING: Cancer and Reproductive Harm - www.P65Warnings.ca.gov



WHIPPING TWINE

Waxed & Braided Polyester

Bulk	Display	Description	(Dia.)	(Length)	Color	Wt.(lb.)	Std. Pack
n/a	562569WH-1	Whipping Twine	1 mm	45'	White	.25	12 ea

Whipping Twine

- Waxed & braided Polyester twine
- Adds a professional finish to splices and rope ends
- Kit includes #15 needle

⚠WARNING: Cancer and Reproductive Harm - www.P65Warnings.ca.gov



ANCHOR CHAIN

Forged Hot Dipped Galvanized Steel

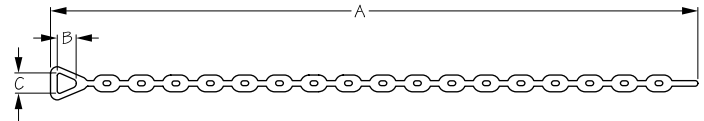

Bulk	Display	A	B	C	Chain Link Size	Wt.(lb.)	Std. Pack
312833	n/a	3'	1-1/16"	1-1/16"	3/16"	1.48	1 ea
312844	n/a	4'	1"	1-1/8"	1/4"	3.25	1 ea
312846	n/a	6'	1"	1-1/8"	1/4"	4.82	1 ea
312855	n/a	5'	1-3/8"	1-1/4"	5/16"	6.28	1 ea

These Anchor Chains feature welded, over-sized end links for easy shackle attachment. Recommended for use between the anchor and anchor line with fluke style anchors to increase holding power. Constructed of forged hot dipped galvanized steel.

⚠WARNING: Cancer and Reproductive Harm - www.P65Warnings.ca.gov

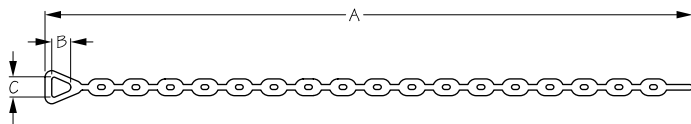

ANCHOR CHAIN

Forged Hot Dipped Galvanized Steel/PVC Coated



Bulk	Display	A	B	C	Chain Link Size	Wt.(lb.)	Std. Pack
312933	n/a	3'	1-1/16"	1-1/16"	3/16"	1.48	1 ea
312944	n/a	4'	1"	1-1/8"	1/4"	3.25	1 ea
312955	n/a	5'	1-3/8"	1-1/4"	5/16"	6.28	1 ea

These Anchor Chains feature welded, over-sized end links for easy shackle attachment. White PVC coating provides corrosion resistance and boat surface protection. Recommended for use between the anchor and anchor line with fluke style anchors to increase holding power. Constructed of forged hot dipped galvanized steel with white vinyl PVC coating.

⚠WARNING: Cancer and Reproductive Harm - www.P65Warnings.ca.gov

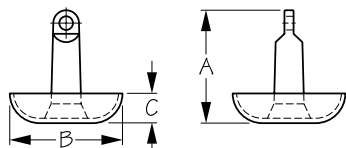

MUSHROOM ANCHOR

Cast Iron



Bulk	Display	Coating/ Paint	Size	A	B	C	Wt.(lb.)	Std. Pack
314168	n/a	Black Vinyl	8	7-1/2"	6-11/16"	1-3/4"	7.8	1 ea
314170	n/a	Black Vinyl	10	8"	7-7/8"	2"	10.9	1 ea
314175	n/a	Black Vinyl	15	8"	8-3/16"	2-1/8"	14.6	1 ea

These sturdy Mushroom Anchors are an economical solution for light weight boats. Ideal for canoes, kayaks, or rowboats. The wide-area mushroom cap offers effective holding power in mud and weedy bottoms. The drain holes in the base facilitate easy retrieval, allowing water and mud to dissipate quickly. One-piece cast iron construction with a black vinyl coated finish ensures long-lasting, dependable use.

⚠WARNING: Cancer and Reproductive Harm - www.P65Warnings.ca.gov

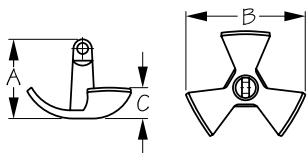

RIVER ANCHOR

Cast Iron



Bulk	Display	Coating/ Paint	Size	A	B	C	Wt.(lb.)	Std. Pack
314268	n/a	Black Vinyl	8	6-3/4"	9"	2-5/8"	9.1	1 ea
314272	n/a	Black Vinyl	12	7-7/8"	9-3/4"	3"	14.2	1 ea
314275	n/a	Black Vinyl	15	7-7/8"	10"	3"	15.0	1 ea
314278	n/a	Black Vinyl	18	8"	11-1/4"	2-5/8"	19.6	1 ea
314290	n/a	Black Vinyl	30	9-1/4"	12-3/8"	3-1/4"	30.0	1 ea

These River Anchors are designed specifically for river currents and heavy drift conditions. The grappling action of the anchors three individual blades offers effective holding power for rivers and mud bottom lakes, even on windy days. The flow-through holes between the blades facilitate easy retrieval. Ideal for pontoon and bass boats. One-piece cast iron construction with a black vinyl coated finish ensures long-lasting, dependable use.

- Allow additional 1/16" - 3/32" for vinyl coating on all dimensions
- Weights vary due to metal and coating content; listed weights are approximate

⚠WARNING: Cancer and Reproductive Harm - www.P65Warnings.ca.gov



NAVY ANCHOR

Cast Iron

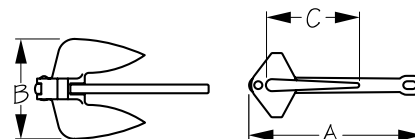

Bulk	Display	Coating/ Paint	Size	A	B	C	Wt.(lb.)	Std. Pack
314510	n/a	Aluminum Paint	10	13-1/2"	7-3/4"	7-1/4"	11.0	1 ea
314515	n/a	Aluminum Paint	15	13-1/2"	7-7/8"	7-1/4"	15.6	1 ea
314520	n/a	Aluminum Paint	20	13-1/2"	10-1/2"	8-1/4"	21.2	1 ea
314528	n/a	Aluminum Paint	28	13-1/2"	11"	9-1/4"	26.0	1 ea
314570	n/a	Black Vinyl	10	13-1/2"	7-3/4"	7-1/4"	11.5	1 ea
314575	n/a	Black Vinyl	15	13-1/2"	7-7/8"	7-1/4"	16.1	1 ea
314580	n/a	Black Vinyl	20	13-1/2"	10-1/2"	8-1/4"	19.6	1 ea
314588	n/a	Black Vinyl	28	13-1/2"	11"	9-1/4"	26.0	1 ea

These Navy Anchors are a classic, proven design whose performance is based on a combination of weight and the mechanical principle of flukes to dig in and hold firm. Navy Anchors work well in rocky bottoms, and also penetrate easily through weeds. The reverse action of the shank allows for quick and easy retrieval of a fouled anchor. The stock folds flat, parallel to the shank, for compact storage. Chain is recommended for optimum performance. Constructed of cast iron with a painted aluminum or black vinyl coated finish.

- Allow additional 1/16" - 3/32" for vinyl coating on all dimensions
- Weights vary due to metal and coating content; listed weights are approximate

⚠WARNING: Cancer and Reproductive Harm - www.P65Warnings.ca.gov



FOLDING ANCHOR

Hot Dipped Galvanized Iron/Forged Flukes

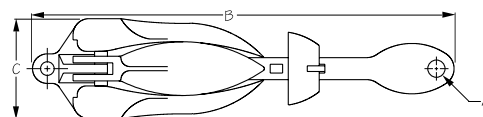

Bulk	Display	A	B	C	Boat Length	Line/Length	Chain/Length	Wt.(lb.)	Std. Pack
318001	n/a	1/4"	7"	2-1/4"	5' - 10'	1/4"/35'	3/16"/7'-10'	1.5	1 ea
318003	n/a	1/2"	12"	2-7/8"	5' - 12'	1/4"/35'	3/16"/7'-10'	3.5	1 ea
318005	n/a	1/2"	14"	4"	5' - 14'	5/16"/50'	3/16"/7'-10'	5.5	1 ea
318007	n/a	1/2"	16"	4-1/4"	5' - 16'	5/16"/50'	3/16"/7'-10'	7.0	1 ea
318009	n/a	1/2"	18"	4-1/4"	5' - 18'	5/16"/120'	3/16"/10'-13'	9.0	1 ea
318013	n/a	1/2"	21-1/2"	4-3/4"	14' - 22'	3/8"/150'	3/16"/10'-20'	13.0	1 ea
318018	n/a	1/2"	22-1/2"	5"	18' - 26'	3/8"/150'	1/4"/10'-20'	18.0	1 ea
318022	n/a	1/2"	24-1/4"	5"	22' - 30'	3/8"/150'	1/4"/10'-20'	22.0	1 ea
318027	n/a	1/2"	25-1/2"	5"	24' - 30'	1/2"/150'	1/4"/10'-20'	27.0	1 ea
318033	n/a	5/8"	26"	5"	26' - 32'	1/2"/175'	3/8"/10'-20'	33.0	1 ea

These grapnel Folding Anchors provide effective holding power in mud, sand, gravel, or rocky conditions. Designed with four arms that fold flat against the shank for compact storage they can be locked in the opened or closed position. Ideal for inflatable boats, as there are no open flukes to puncture sensitive fabric. Great as a primary anchor on dinghies, PWC's, canoes, kayaks, and small sailboats. They are also an inexpensive backup anchor on larger boats. Constructed of hot dipped galvanized iron with forged flukes.

- Weights vary due to metal content; listed weights are approximate

⚠WARNING: Cancer and Reproductive Harm - www.P65Warnings.ca.gov



FOLDING ANCHOR KIT

Painted Hot Dipped Galvanized Iron/Forged Flukes

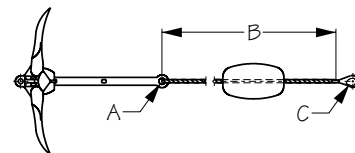

Bulk	Display	A	B	C	Boat Length	Line/Length	Wt.(lb.)	Std. Pack
318003K	n/a	1/2"	25'	1"	5' - 12'	1/4"/25'	3.5	1 ea

The Folding Anchor Kit features a 3.5 lbs. folding grapnel anchor with 25' of 1/4" line, an adjustable float, stainless fast eye boat snap, and storage bag. Great as a primary anchor on dinghies, PWC's, canoes, kayaks, and small sailboats. Inexpensive and easy to store, this kit is also useful as a backup anchor on larger boats. Effective holding power in mud, sand, gravel, or rocky conditions.

- Weights vary due to metal and coating content; listed weights are approximate

⚠WARNING: Cancer and Reproductive Harm - www.P65Warnings.ca.gov

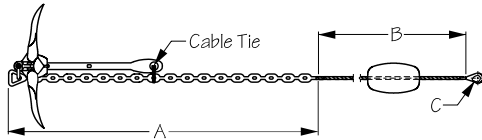

FOLDING ANTI-SNAG ANCHOR KIT

Hot Dipped Galvanized Iron/Forged Flukes



Bulk	Display	A	B	C	Chain Length	Line/Length	Boat Length	Wt.(lb.)	Std. Pack
318003KP	n/a	3'	35'	1"	3'	3/8"/35'	5' - 14'	5.06	1 ea

Folding Anti-Snag Anchor Kit makes an ideal primary anchor on dinghies, small sailboats, and inflatables. Cable tie break away from anchor chain for easy retrieval. Includes a 3 lbs. folding grapnel anchors, 3' of 3/16" vinyl coated anchor chain, 35' of 3/8" line, ten cable ties, an adjustable float, stainless fast eye boat snap, and mesh storage bag. Compact and easy to store. Effective holding power in mud, sand, gravel, or rocky conditions.

- Weights vary due to metal content. Listed weights are approximate

▲WARNING: Cancer and Reproductive Harm - www.P65Warnings.ca.gov

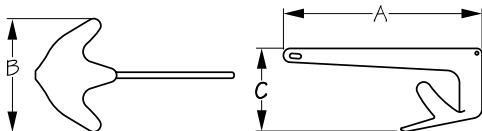

SEA-HOOK® CLAW ANCHOR

Hot Dipped Galvanized Investment Cast Steel



Bulk	Display	A	B	C	Boat Length	Wt.(lb.)	Std. Pack
318502	n/a	14-1/4"	9-11/16"	7-3/16"	13' - 18'	4.4	1 ea
318503	n/a	16"	10-1/4"	8-11/16"	13' - 18'	7.7	1 ea
318505	n/a	18-7/16"	12-3/8"	9-7/16"	19' - 23'	11.0	1 ea
318507	n/a	20-15/16"	14-3/16"	10-3/4"	24' - 30'	16.5	1 ea
318510	n/a	22-15/16"	15-1/8"	11-1/2"	31' - 35'	22.0	1 ea
318515	n/a	25-3/4"	17"	13-7/16"	36' - 40'	33.0	1 ea
318520	n/a	27-5/8"	18"	14-5/8"	41' - 47'	44.0	1 ea
318530	n/a	31-1/8"	20-1/2"	16-5/16"	48' - 63'	66.1	1 ea
318550	n/a	37-5/16"	23-9/16"	20-1/16"	64' - 92'	110.1	1 ea
318580	n/a	43-3/4"	28-9/16"	22-3/16"	93' - 120'	165.2	1 ea

The Sea-Hook® Claw Anchor is roll stabilized to perform well on short scopes and set effectively. Designed to right itself no matter how it lands on the bottom, it remains stable under a wide range of tide and wind conditions. Exceptional holding power in most sea beds. Stows easily on a bow roller. Quick set and reset. Constructed of hot dipped galvanized cast steel in a single piece design for maximum strength and holding power. 318501-318530 are investment cast. 318550-318580 are sand cast. Heat treated type C1035 steel. A competitively priced alternative to the Bruce® anchor.

- Weights vary due to metal and coating content; listed weights are approximate

▲WARNING: Cancer and Reproductive Harm - www.P65Warnings.ca.gov

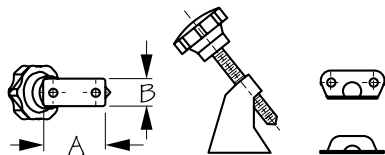

HATCH LATCH

Stamped 304 Stainless Steel



Bulk	Display	A	B	Fastener	Wt.(lb.)	Std. Pack
321000	321000-1	1-7/16"	5/8"	#10 RH	.19	10 ea

This Hatch Latch features a simple screw-in action to securely hold the hatch in a closed position. Constructed of corrosion resistant stamped 304 stainless steel. Installs with four #10 RH fasteners (not included).

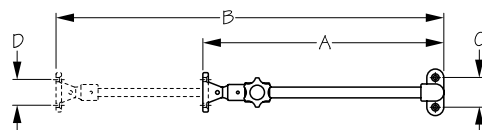

HATCH ADJUSTER

Formed 304 Stainless Steel/Nylon



Bulk	Display	A	B	C	D	Wt.(lb.)	Std. Pack
321291	321291-1	11-1/8"	17-7/8"	1-3/8"	1-3/16"	.33	5 ea
321292	321292-1	14-3/16"	24-3/16"	1-3/8"	1-3/16"	.40	5 ea

These Hatch Adjusters feature a simple thumb screw knob to lock into position. Great for dock box lids, hatches, windshields, etc. Constructed of corrosion resistant formed 304 stainless steel with UV resistant injection molded nylon mounting pads and knob. Installs with four fasteners (not included).



HATCH ADJUSTER WITH SWIVEL

Formed 304 Stainless Steel/Nylon

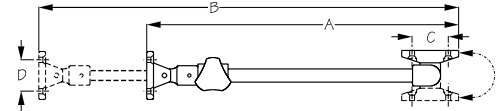

Bulk	Display	A	B	C	D	Wt.(lb.)	Std. Pack
321293C1	n/a	11-13/16"	18-9/16"	1-3/8"	1-3/16"	.36	5 ea

These Hatch Adjusters feature a simple twist knob to lock into position. Mounting pads feature a swivel for more mounting options. Great for dock box lids, hatches, windshields, etc. Constructed of corrosion resistant formed 304 stainless steel with UV resistant injection molded nylon mounting pad. Installs with four fasteners (not included).



HATCH ADJUSTER

Formed 304 Stainless Steel/Nylon

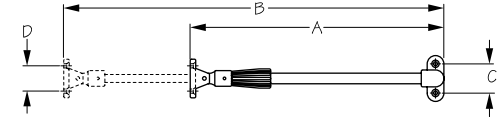

Bulk	Display	A	B	C	D	Wt.(lb.)	Std. Pack
321295	321295-1	11-15/16"	17-7/8"	1-3/8"	1-3/16"	.31	5 ea
321296	321296-1	14-15/16"	24"	1-3/8"	1-3/16"	.40	5 ea

These Hatch Adjusters feature a simple twist knob to lock into position. Great for dock box lids, hatches, windshields, etc. Constructed of corrosion resistant formed 304 stainless steel with UV resistant injection molded nylon mounting pads and knob. Installs with four fasteners (not included).



GAS FILLED LIFT SPRING

Chrome and Powder Coated Steel, Bronze, Polymers and Nitrogen Gas

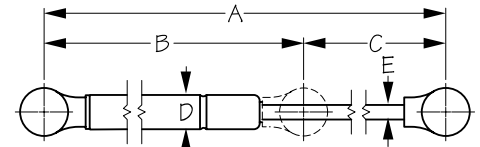

Bulk	Display	Lift Wt. (lbs.)	A	B	C	D	E	Uses*	Wt.(lb.)	Std. Pack
321402	321402-1	20	7-1/2"	5-1/2"	2"	15 mm	6 mm	1	.25	1 ea
321404	321404-1	40	7-1/2"	5-1/2"	2"	15 mm	6 mm	1	.25	1 ea
321422	321422-1	20	10"	7"	3"	15 mm	6 mm	1, 2, 3	.31	1 ea
321424	321424-1	40	10"	7"	3"	15 mm	6 mm	1, 2, 3	.31	1 ea
321426	321426-1	60	10"	7"	3"	15 mm	6 mm	1, 3	.31	1 ea
321462	321462-1	20	15"	9-1/2"	5-1/2"	15 mm	6 mm	1, 2	.41	1 ea
321463	321463-1	30	15"	9-1/2"	5-1/2"	15 mm	6 mm	1, 2	.41	1 ea
321464	321464-1	40	15"	9-1/2"	5-1/2"	15 mm	6 mm	1, 2	.41	1 ea
321466	321466-1	60	15"	9-1/2"	5-1/2"	15 mm	6 mm	1, 2	.41	1 ea
321473	321473-1	30	17"	11"	6-3/4"	15 mm	6 mm	1, 4	.44	1 ea
321474	321474-1	40	17"	11"	6-3/4"	15 mm	6 mm	1, 2, 4	.44	1 ea
321476	321476-1	60	17"	11"	6-3/4"	15 mm	6 mm	1, 2	.44	1 ea
321482	321482-1	20	20"	12"	8-1/8"	15 mm	6 mm	1, 2	.50	1 ea
321483	321483-1	30	20"	12"	8-1/8"	15 mm	6 mm	1, 2	.50	1 ea
321484	321484-1	40	20"	12"	8-1/8"	15 mm	6 mm	1, 2	.50	1 ea
321486	321486-1	60	20"	12"	8-1/8"	15 mm	6 mm	1, 2	.50	1 ea
321488	321488-1	80	20"	12"	8-1/8"	18 mm	8 mm	1, 2	.50	1 ea
321489	321489-1	90	20"	12"	8-1/8"	18 mm	8 mm	1, 2	.50	1 ea
321492	321492-1	120	20"	12"	8"	18 mm	8 mm	1, 2	.78	1 ea
321599	321599-1	Gas Lift Rod End Fitting							.01	10 ea

*Uses/Application KEY: 1=Marine, 2=RV, 3=Tool Box/Utility, 4=Truck Cap

These Gas Filled Lift Springs and hardware are manufactured to marine OE standards and have been installed in marine and RV applications for many years. You can count on our high quality and a 2-year warranty on all Sea-Dog® Gas Filled Lift Springs.

Sea-Dog® Gas Filled Lift Springs are the ideal choice for all marine, RV, truck cap, tool box, and utility applications because of their unique, multi-lobe seal which offers superior service life and performance. Hard chromium plated shafts, bronze bushings, and polymer end fittings mean you are buying THE BEST.

Other applications for Sea-Dog® Gas Filled Lift Springs:

Engine or access hatches, doors, tool boxes, golf carts, canopies, seating, RV doors, furniture, truck caps, and utility boxes. Accepts 10 mm ball.

⚠WARNING: Cancer and Reproductive Harm - www.P65Warnings.ca.gov

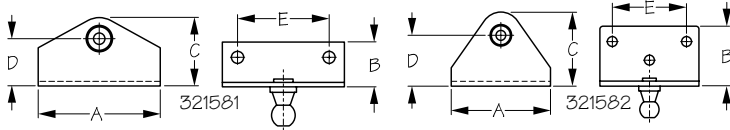

90° GAS LIFT MOUNT

304 Stainless Steel



Bulk	Display	A	B	C	D	E	Finish	Fastener	Wt.(lb.)	Std. Pack
321581	321581-1	2"	5/8"	1-1/8"	3/4"	1-1/2"	Stainless	#10 RH	.07	10 ea
321582	321582-1	2"	1-1/4"	1-1/2"	1"	1-1/2"	Stainless	#10 RH	.13	10 ea

90° Gas Lift Mounts are used for mounting gas filled lift springs. 10 mm ball. Constructed of corrosion resistant stamped 304 stainless steel. Installs with #10 RH fasteners (not included).

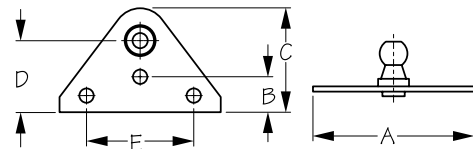

FLUSH GAS LIFT MOUNT

304 Stainless Steel



Bulk	Display	A	B	C	D	E	Finish	Fastener	Wt.(lb.)	Std. Pack
321583	321583-1	2-1/4"	1/2"	1-1/2"	1"	1-1/2"	Stainless	#10 RH	.06	10 ea

Flush Gas Lift Mounts are used for mounting gas filled lift springs. 10 mm ball. Constructed of corrosion resistant stamped 304 stainless steel. Installs with three #10 RH fasteners (not included).

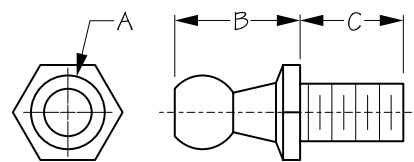

GAS LIFT BALL STUD - 10 MM

Formed 304 Stainless Steel



Bulk	Display	A (Ball)	B	C	Threads	Hex Nut	Wt.(lb.)	Std. Pack
321586	321586-1	10 mm	5/8"	9/16"	5/16"-18	1/2"	.02	10 ea

Gas Lift Ball Studs feature a 10 mm ball which fits all Sea-Dog® Gas Lift Springs. Constructed of formed 304 stainless steel.

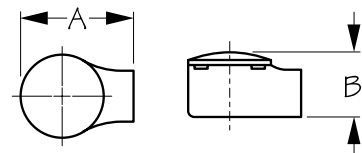

GAS LIFT ROD END FITTING

Injection Molded Nylon



Bulk	Display	Thread	A	B	Wt.(lb.)	Std. Pack
321599	321599-1	6 mm-1	1-1/8"	5/8"	.01	10 ea

Gas Lift Rod End Fitting accepts 10 mm ball. Constructed of injection molded nylon. Replacement for Sea-Dog® Gas Lift Springs.

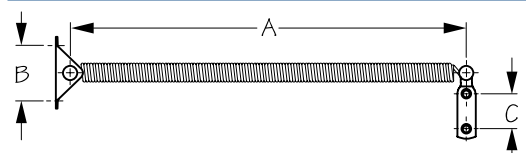

HATCH SPRING - SMALL

Formed 304 Stainless Steel



Bulk	Display	A	B	C	Fastener	Internal Cable	Wt.(lb.)	Std. Pack
321650	321650-1	8-5/8"	1-1/16"	3/4"	#6 RH & 1/8" Pop Rivet	Yes	.20	10 ea

This Hatch Spring has an internal wire that prevents the spring from being overextended during normal use. Constructed of corrosion resistant formed 304 stainless steel. Installs with four #6 RH fasteners or 1/8" pop rivets (not included). Not recommended for applications where hatch will scoop wind while boat is underway and overextend spring.

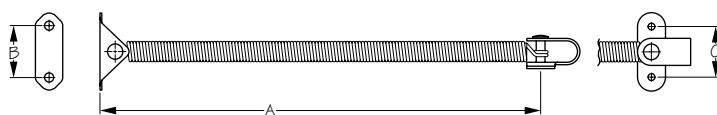

HATCH SPRING

Formed 304 Stainless Steel



Bulk	Display	A	B	C	Fastener	Internal Cable	Wt.(lb.)	Std. Pack
321660	321660-1	9"	1-1/16"	1-1/16"	#10 RH and/or 3/16" Pop Rivet	Yes	.19	10 ea

This Hatch Spring has an internal wire that prevents the spring from being overextended during normal use. Constructed of corrosion resistant formed 304 stainless steel. Installs with four #10 RH fasteners or 3/16" pop rivets (not included). Not recommended for applications where hatch will scoop wind while boat is underway and overextend spring.



HATCH SPRING

Formed 304 Stainless Steel

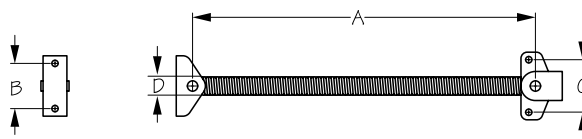

Bulk	Display	A	B	C	D	Internal Cable	Fastener	Wt.(lb.)	Std. Pack
321670	321670-1	10-1/8"	1-3/8"	1-5/8"	9/16"	Yes	#10 RH	.37	10 ea

This Hatch Spring has an internal wire that prevents the spring from being overextended during normal use. Ideal for use on lighter hatches, dock boxes, and lazarettes. Constructed of corrosion resistant formed 304 stainless steel. Installs with four #10 RH fasteners (not included). Not recommended for applications where hatch will scoop wind while boat is underway and overextend spring.



HATCH SPRING

Formed 304 Stainless Steel/Nylon

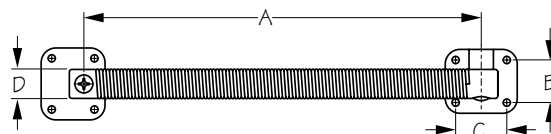

Bulk	Display	A	B	C	D	Internal Cable	Fastener	Wt.(lb.)	Std. Pack
321680	321680-1	11-5/8"	1-1/4"	1-1/2"	7/8"	Yes	#10 RH	.78	5 ea

This strong Hatch Spring has an internal cable that prevents the spring from being overextended during normal use. Ideal for larger hatches and dock boxes. Constructed of corrosion resistant formed 304 stainless steel with heavy duty molded nylon mounting pads on both ends. Installs with eight #10 RH fasteners (not included).



CHAIN DECK PIPE

Investment Cast 316 Stainless Steel

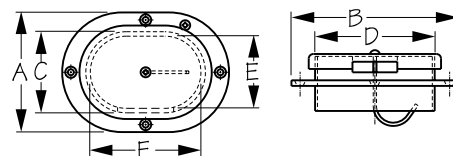

Bulk	Display	A	B	C	D	E	F	Fastener	Wt.(lb.)	Std. Pack	
321800	n/a	4-1/16"	5-5/8"	2-3/4"	4-1/8"	2-1/2"	3-3/4"	#10 FH	2.51	1 ea	
n/a	321810-1	Replacement Cap & Chain								.88	1 ea

This Chain Deck Pipe facilitates the storage of anchor lines out of the way below deck, reducing the risk of trip hazards on deck. The oval opening can accommodate a large thimble and line plus the shackle and chain. Chain can remain in slot when the cover is closed. The cover is held in place with the chain when suspended from the integral hook. Constructed of corrosion resistant investment cast 316 stainless steel. Installs with four #10 FH fasteners (not included).



HINGED DECK PIPE

Investment Cast 316 Stainless Steel

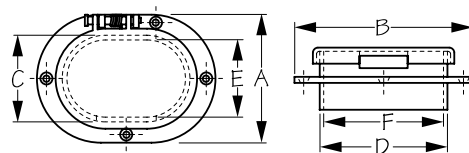

Bulk	Display	A	B	C	D	E	F	Fastener	Wt.(lb.)	Std. Pack
321805	n/a	4-1/16"	5-5/8"	2-3/4"	4-1/8"	2-7/16"	3-3/4"	#10 FH	2.08	1 ea

These Hinged Deck Pipes facilitate the storage of anchor lines out of the way below deck, reducing the risk of trip hazards on deck. The oval pipe opening can accommodate a large thimble and line plus the shackle and chain. This deck pipe features a hinged cap for easy access. Chain can remain in slot when the cover is closed. Constructed of corrosion resistant investment cast 316 stainless steel. Installs with four #10 FH fasteners (not included).



HINGED DECK PIPE - EURO STYLE

Investment Cast 316 Stainless Steel

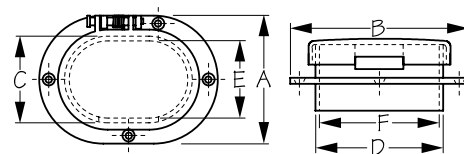

Bulk	Display	A	B	C	D	E	F	Fastener	Wt.(lb.)	Std. Pack
321806	n/a	4-1/16"	5-3/8"	2-3/4"	4-1/8"	2-7/16"	3-3/4"	#10 FH	2.08	1 ea

A new look to a trusted favorite! These Euro Style Hinged Deck Pipes facilitate the storage of anchor lines out of the way below deck, reducing the risk of trip hazards on deck. The oval pipe opening can accommodate a large thimble and line plus the shackle and chain. This deck pipe features a hinged cap for easy access. Chain can remain in slot when the cover is closed. Constructed of corrosion resistant investment cast 316 stainless steel. Installs with four #10 FH fasteners (not included).

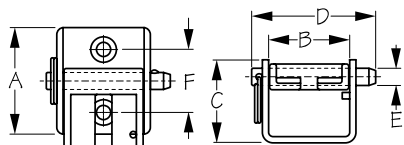

CHAIN STOPPER

Formed 304 Stainless Steel



Bulk	Display	A	B	C	D	E	F	Fastener	Wt.(lb.)	Std. Pack
321820	321820-1	2-3/8"	1-13/16"	1-13/16"	2-3/4"	3/8"	1-3/8"	5/16" FH	1.14	1 ea
321825	321825-1	3-1/8"	2-3/8"	2-7/16"	3-5/8"	1/2"	1-7/8"	3/8" FH	1.43	1 ea

These Chain Stoppers help prevent damage to the windlass and reduce the risk of accidental free fall of the anchor while under way. Chain Stoppers mount alone or inside most bow rollers and work with your anchor roller to take tension off your windlass. Chain and rope should be secured at anchor when your windlass is not in use to avoid high loads the windlass was not designed for. 321820 fits chain sizes 3/16" - 1/4". 321825 fits chain sizes 5/16" - 3/8". Constructed of corrosion resistant formed 304 stainless steel.

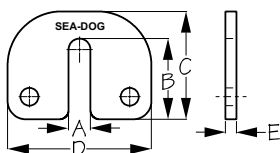

CHAIN GRIPPER PLATE

Investment Cast 316 Stainless Steel



Bulk	Display	A	B	C	D	E	Wt.(lb.)	Std. Pack
321850	321850-1	5/8"	2-1/4"	3"	4"	5/16"	.81	5 ea

This Chain Gripper Plate stabilizes anchor chains and reduces stress on windlass when anchored in heavy seas. The two holes are used for a bridle application with two Bow Shackles (147212) to connect lines to port and starboard cleats for stabilization. Fits anchor chain sizes: 5/16", 3/8", 7/16", and 1/2". Constructed of corrosion resistant investment cast 316 stainless steel. Installs with two RH fasteners (not included).

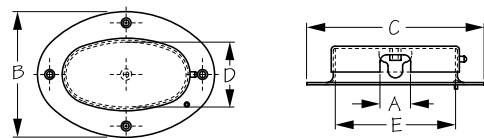

CHAIN DECK PIPE

Forged Brass Chrome Plated



Bulk	Display	A	B	C	D	E	Fastener	Wt.(lb.)	Std. Pack
322070	n/a	1"	4-1/2"	6-1/4"	2-5/16"	4"	#8 FH	1.23	1 ea
n/a	322075-1	Replacement Cap & Chain						.54	1 ea

This Chain Deck Pipe facilitates the storage of anchor lines out of the way below deck, reducing the risk of trip hazards on deck. The oval pipe opening can accommodate a large thimble and line up to 1" in diameter plus the shackle and chain. Chain can remain in slot when the cover is closed. Constructed of chrome plated forged brass. Installs with four #8 FH fasteners (not included).

▲WARNING: Cancer and Reproductive Harm - www.P65Warnings.ca.gov

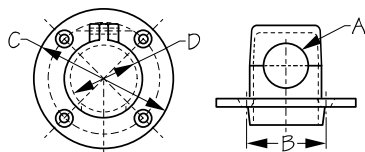

HINGED CHAIN DECK PIPE

Die Cast Brass Chrome Plated



Bulk	Display	A	B	C	D	Fastener	Wt.(lb.)	Std. Pack
322080	322080-1	1"	1-3/4"	3-1/8"	1-1/2"	#8 FH	.64	5 ea

This Hinged Chain Deck Pipe facilitates the storage of anchor lines out of the way below deck, reducing the risk of trip hazards on deck. The circular pipe features a hinged cap for easy access. Chain can remain in slot when the cover is closed. Constructed of die cast chrome plated brass. Installs with four #8 FH fasteners (not included).

▲WARNING: Cancer and Reproductive Harm - www.P65Warnings.ca.gov

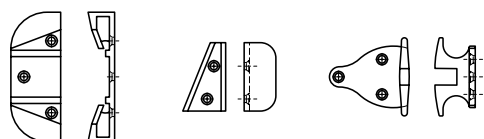

ANCHOR CHOCK

Investment Cast 316 Stainless Steel



Bulk	Display	Anchor Size	Fastener	Wt.(lb.)	Std. Pack
322150	322150-1	5 - 20 lb.	#10 FH	1.44	5 sets

Anchor Chocks protect the surface of your deck in rough seas or while the boat is underway. Secures the anchor when not in use while still maintaining easy access. For use with conventional fluke anchors from 5-20 lbs., 9/16" maximum shank thickness. Constructed of corrosion resistant investment cast 316 stainless steel. Deck mounts with ten #10 FH fasteners (not included).



ANTI-RATTLE WINDOW STOP

Sand Cast Brass Chrome Plated

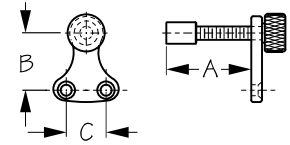

Bulk	Display	A	B	C	Fastener	Wt.(lb.)	Std. Pack
322210	322210-1	1-5/16"	7/8"	5/8"	#6 FH	.07	10 ea

This Anti-Rattle Window Stop reduces vibration and noise while underway. Threaded pin tightens on shank. Constructed of chrome plated sand cast brass. Installs with two #6 FH fasteners (not included).

⚠WARNING: Cancer and Reproductive Harm - www.P65Warnings.ca.gov



LADDER LOCKS

Cast Brass or Chrome Plated Brass

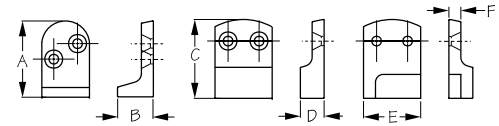

Bulk	Display	A	B	C	D	E	F	Finish	Wt.(lb.)	Std. Pack
322270	322270-1	1-5/8"	3/4"	1-5/8"	1/2"	1-1/4"	1/4"	Chrome	.64	10 pr
322271	322271-1	1-5/8"	3/4"	1-5/8"	1/2"	1-1/4"	1/4"	Brass	.64	10 pr

These highly polished Ladder Locks are commonly used with wooden step ladders. Ladder slips into tapered locks and becomes secure as it is lowered in to place. Constructed of cast brass with a plain or chrome plated finish. Installs with eight #10 FH fasteners (not included).

⚠WARNING: Cancer and Reproductive Harm - www.P65Warnings.ca.gov



FOLDING STEP

Sand Cast Brass Chrome Plated

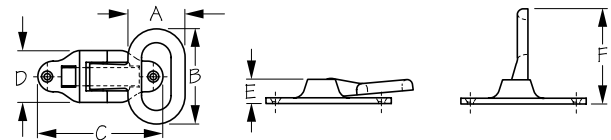

Bulk	Display	A	B	C	D	E	F	Fastener	Wt.(lb.)	Std. Pack
322620	322620-1	2"	3-1/4"	4-5/16"	1-13/16"	13/16"	3-7/16"	#12 FH	1.10	5 ea

This Folding Step has a patterned, texture finish for better traction. The spring loaded folding mechanism will keep the step in the open or closed position without rattling. Constructed of chrome plated sand cast brass. Installs with two FH fasteners (not included). Also see Sea-Dog® Stainless Folding Step (328020).

⚠WARNING: Cancer and Reproductive Harm - www.P65Warnings.ca.gov



WINDSHIELD LATCH

Injection Molded Nylon

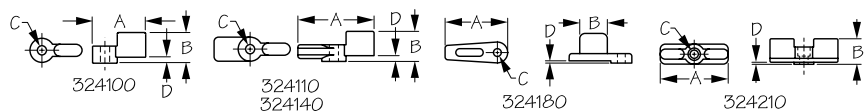

Bulk	Display	Description	A	B	C	D	Wt.(lb.)	Std. Pack
324100	n/a	Single Wing Latch	1-3/16"	5/8"	3/16"	1/16"	.01	10 ea
324110	324110-1	Single Wing Latch	1-9/16"	5/8"	3/16"	1/8"	.01 / .02	10 ea / 10 pr
324140	324140-1	Single Wing Latch	1-9/16"	13/16"	3/16"	5/16"	.01 / .02	10 ea / 10 pr
324180	324180-1	Thumb Latch	1-1/2"	11/16"	3/16"	1/16"	.01 / .02	10 ea / 10 pr
324210	324210-1	Double Latch	1-11/16"	5/8"	3/16"	1/16"	.01 / .02	10 ea / 10 pr

These Windshield Latches are used to secure windshield doors with a simple twist design. Prevents rattling due to engine vibration at high speeds. Constructed of UV resistant black injection molded nylon.



WINDSHIELD BRACE FOOT

Injection Molded Nylon

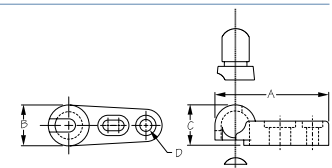

Bulk	Display	A	B	C	D	Wt.(lb.)	Std. Pack
324300	324300-1	2-1/16"	3/4"	3/4"	3/16"	.02	10 set / 10 sets

This Windshield Brace Foot fits 1/2" ID tubing to support a windshield. Constructed of UV resistant black injection molded nylon.

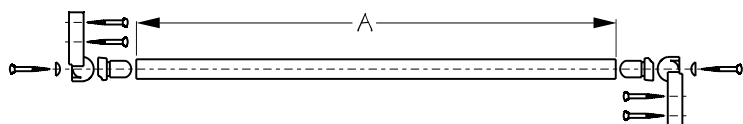

WINDSHIELD BRACE KIT

Formed Aluminum/Injection Molded Nylon



Bulk	Display	A	Fastener	Wt.(lb.)	Std. Pack
n/a	324310-1	14-1/4"	#10 PH	.14	5 ea



Windshield Brace Kit includes two windshield brace feet and a 14-1/4" length of formed aluminum tube to be cut to size per individual application. Injection molded nylon brace feet inserts must be crimped in place. Installs with #10 PH screws (not included). Direct replacement for Taylor Made® TMS-041.

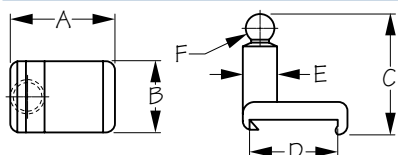

MALE WINDSHIELD RETAINER SPACER

Injection Molded Nylon



Bulk	Display	Color	A	B	C	D	E	F	Wt.(lb.)	Std. Pack
324360	324360-1	Black	1-1/8"	3/4"	1-5/16"	15/16"	3/8"	5/16"	.01 / .02	10 ea / 10 pr

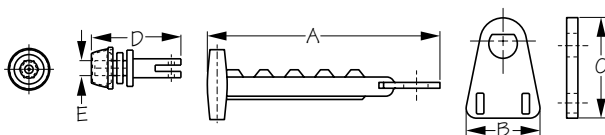

SIDE VENT ADJUSTER KIT

Injection Molded Nylon



Bulk	Display	A	B	C	D	E	Wt.(lb.)	Std. Pack
324380	324380-1	5"	1-9/16"	2-3/16"	1-15/16"	5/16"	.07	10 ea

This Side Vent Adjuster Kit is used for adjusting the opening of windshield wing windows. Improved push nut retainer cap with washer. Constructed of UV resistant injection molded nylon with a 304 stainless steel pin.

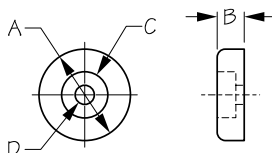

WINDSHIELD/DOOR BUMPER PAD

Injection Molded Kraton



Bulk	Display	Color	A	B	C	D	Fastener	Wt.(lb.)	Std. Pack
324390	324390-1	Black	3/4"	3/16"	3/8"	1/8"	#8 RH	.01 / .02	10 ea / 10 pr
324391	324391-1	Clear	3/4"	3/16"	3/8"	1/8"	#8 RH	.01 / .02	10 ea / 10 pr

▲WARNING: Cancer and Reproductive Harm - www.P65Warnings.ca.gov

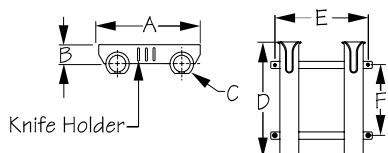

TWO POLE SIDE MOUNT ROD HOLDER

Injection Molded Polypropylene



Bulk	Display	A	B	C	D	E	F	Color	Wt.(lb.)	Std. Pack
n/a	325028-1	9"	1-3/4"	1-3/4"	10-3/4"	8"	4-5/8"	White	.73	4 ea
n/a	325029-1	9"	1-3/4"	1-3/4"	10-3/4"	8"	4-5/8"	Black	.73	4 ea



These Two Pole Side Mount Rod Holders feature a built-in knife and lure holder. Accommodates rods up to 1-3/4" in diameter. Constructed from one-piece of injection molded UV stabilized polypropylene. No assembly required. Installs with four #8 fasteners (included in display packed product). Available in black or white.

▲WARNING: Cancer and Reproductive Harm - www.P65Warnings.ca.gov



THREE POLE SIDE MOUNT ROD HOLDER

Injection Molding Polypropylene

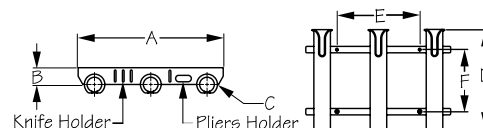

Bulk	Display	A	B	C	D	E	F	Color	Wt.(lb.)	Std. Pack
325038	325038-1	13-1/2"	1-7/8"	1-3/4"	10-3/4"	7"	4-1/2"	White	1.50	4 ea
325039	325039-1	13-1/2"	1-7/8"	1-3/4"	10-3/4"	7"	4-1/2"	Black	1.50	4 ea

These Three Pole Side Mount Rod Holders feature a built-in knife, pliers, and lure holder. Accommodates rods up to 1-3/4" in diameter. Constructed from one-piece of injection molded UV stabilized polypropylene. No assembly required. Installs with four #8 fasteners (included in display packed product). Available in black or white.



⚠WARNING: Cancer and Reproductive Harm - www.P65Warnings.ca.gov



TRACK ROD HOLDER

Aluminum/PVC Vinyl

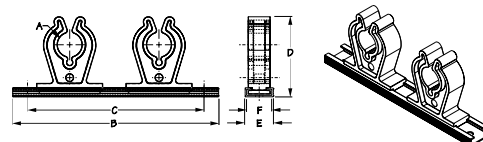

Bulk	Display	A	B	C	D	E	F	Kit Includes	Wt.(lb.)	Std. Pack	
n/a	325044-1	7/8"	7"	5-7/8"	2-7/8"	13/16"	15/16"	2 Tracks/4 Clips	.48	4 ea	
325040	n/a	Aluminum Track Section Only (6 ft. total length)								3.00	10 ea
325041	n/a	Clip Only								.08	10 ea

These Track Rod Holders are designed to hold fishing rods in the toughest conditions. Can be mounted vertically or horizontally in boats and homes. Includes two 7" pre-drilled aluminum tracks and four PVC clips. Installs with four fasteners (included).

⚠WARNING: Cancer and Reproductive Harm - www.P65Warnings.ca.gov



NARROW GUNNEL FLUSH MOUNT ROD HOLDER

Injection Molding ABS

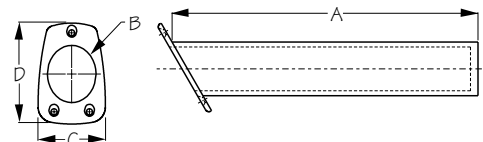

Bulk	Display	A	B	C	D	Color	Fastener	Wt.(lb.)	Std. Pack
325060	325060-1	10"	1-5/8"	2-3/16"	3-5/16"	Black	#10 FH	.24	8 ea
325061	325061-1	10"	1-5/8"	2-3/16"	3-5/16"	White	#10 FH	.24	8 ea

These Narrow Gunnel Flush Mount Rod Holders are designed for narrow gunnel applications. Accommodates rods up to 1-5/8" in diameter. Features a 30° angle. Constructed of UV resistant injection molded ABS. Installs with three #10 FH fasteners (not included). Available in black or white.

⚠WARNING: Cancer and Reproductive Harm - www.P65Warnings.ca.gov



NARROW GUNNEL ROD HOLDER WITH STAINLESS TOP

Stamped 316 Stainless/Injection Molding ABS

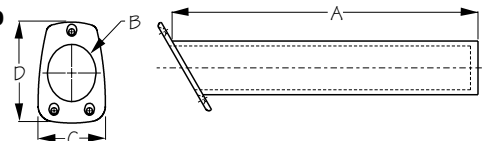

Bulk	Display	A	B	C	D	Finish	Fastener	Wt.(lb.)	Std. Pack
325065	325065-1	10"	1-5/8"	2-5/16"	3-7/16"	Stainless	#10 FH	.38	8 ea

This Narrow Gunnel Flush Mount Rod Holder with Stainless Top is designed for narrow gunnel applications. Accommodates rods up to 1-5/8" in diameter. Features a 30° angle. Constructed of UV resistant injection molded ABS with highly polished investment cast 316 stainless top. Installs with three #10 FH fasteners (not included).



⚠WARNING: Cancer and Reproductive Harm - www.P65Warnings.ca.gov

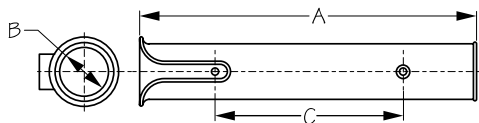

SIDE MOUNT ROD HOLDER

Injection Molded Polypropylene



Bulk	Display	A	B	C	Color	Fastener	Wt.(lb.)	Std. Pack
325120	325120-1	11-11/16"	1-3/4"	6-1/4"	Black	#10 RH	.22	8 ea
325121	325121-1	11-11/16"	1-3/4"	6-1/4"	White	#10 RH	.22	8 ea
325122	325122-1	11-11/16"	1-3/4"	6-1/4"	Gray	#10 RH	.22	8 ea

These Side Mount Rod Holders feature an integral, molded-in standoff located on the back of the rod holder. This standoff allows direct mounting to any flat surface. Accommodates rods up to 1-3/4" in diameter. Constructed of injection molded polypropylene. Installs with two #10 RH fasteners (not included).

- Custom colors available on large volume orders

⚠WARNING: Cancer and Reproductive Harm - www.P65Warnings.ca.gov

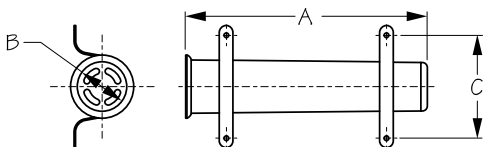

SIDE MOUNT ROD HOLDER

Injection Molded Polypropylene/304 Stainless Steel



Bulk	Display	A	B	C	Color	Fastener	Wt.(lb.)	Std. Pack
325140	325140-1	9"	1-3/4"	3-13/16"	Black	#8 RH	.31	8 ea
325141	325141-1	9"	1-3/4"	3-13/16"	White	#8 RH	.31	8 ea

These Side Mount Rod Holders can accommodate rods up to 1-3/4" in diameter. Constructed of injection molded polypropylene with corrosion resistant 304 stainless steel mounting brackets. Installs with four #8 RH fasteners (not included). Available in black or white.

⚠WARNING: Cancer and Reproductive Harm - www.P65Warnings.ca.gov

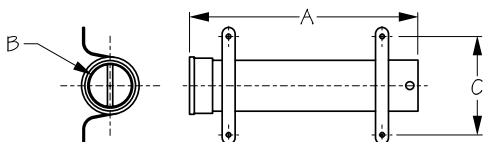

SIDE MOUNT ROD HOLDER

Formed 316 Stainless Steel



Bulk	Display	A	B	C	Fastener	Wt.(lb.)	Std. Pack
325150	325150-1	9"	1-5/8"	3-13/16"	#8 RH	1.04	8 ea
OP32505	n/a	Replacement End Cap				.01	10 ea

This Side Mount Rod Holder can accommodate rods up to 1-5/8" in diameter. Constructed of corrosion resistant formed 316 stainless steel with mounting brackets and plastic end cap. Installs with four #8 RH fasteners (not included).

⚠WARNING: Cancer and Reproductive Harm - www.P65Warnings.ca.gov

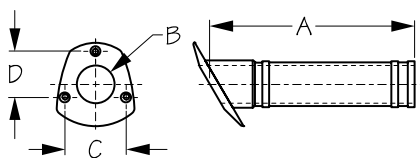

FLUSH MOUNT ROD HOLDER

Injection Molded ABS



Bulk	Display	A	B	C	D	Color	Cap	Fastener	Wt.(lb.)	Std. Pack
325160	325160-1	9-3/16"	1-5/8"	2-1/2"	2-5/8"	Black	No	#12 FH	.40	8 ea
325161	325161-1	9-3/16"	1-5/8"	2-1/2"	2-5/8"	White	No	#12 FH	.40	8 ea
325160CAP	n/a	Optional Cap & Gasket				Black	Yes	#12 FH	.12	5 ea

These Flush Mount Rod Holders can accommodate rods up to 1-5/8" in diameter. Features a 30° angle. Constructed of UV resistant injection molded ABS. Installs with three #12 FH fasteners (not included). Available in black or white. Optional cap and gasket sold separately (pictured below).

- Custom colors available on large volume orders

⚠WARNING: Cancer and Reproductive Harm - www.P65Warnings.ca.gov





FLUSH MOUNT ROD HOLDER STAINLESS TOP

Injection Molded ABS/Stainless Steel

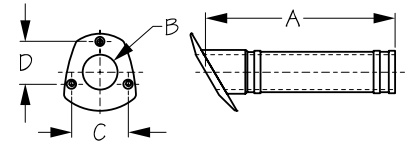

Bulk	Display	A	B	C	D	Color	Fastener	Wt.(lb.)	Std. Pack
325168	325168-1	9-1/2"	1-5/8"	2-1/2"	2-5/8"	Stainless	1/4" FH	.72	8 ea
325168CAP	n/a	Optional Cap & Gasket				Black	1/4" FH	.12	5 ea

This Flush Mount Rod Holder with Stainless Top can accommodate rods up to 1-5/8" in diameter. Features a 30° angle. Constructed of UV resistant injection molded ABS with a stainless steel top cap for a classic look at an economical price. Installs with three 1/4" FH fasteners (not included).

⚠WARNING: Cancer and Reproductive Harm - www.P65Warnings.ca.gov



LED RGB ROD HOLDER

Formed 304 Stainless Steel/Rubber

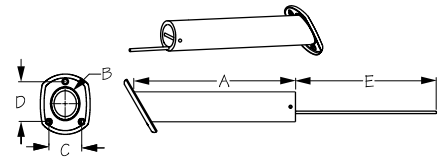

Bulk	Display	A	B	C	D	E	Lumens	Watts/Voltage	Wt.(lb.)	Std. Pack
325181	n/a	9-1/2"	1-5/8"	2-3/16"	3"	12"	200	2.6/12	2.25	8 ea
n/a	325181-3	9-1/2"	1-5/8"	2-3/16"	3"	12"	200	2.6/12	2.25	4 ea
n/a	403051-1	Bluetooth Smart Phone Controller - RGB							.22	4 ea
426624	426624-1	Optional Terminal Block (4-Position)							.06	10 ea

These LED RGB Rod Holders have translucent tube inserts with bright RGB LEDs and a 30° angle. Or retrofit your existing rod holder with the LED RGB Tube Insert (325189, sold separately). Just remove your existing liner, install the LED RGB Tube Insert and cut to your mounting face angle. A Bluetooth Smart Phone Controller (403051-1, sold separately) lets you operate this RGB LED Rod Holder from your smartphone (IOS 6 or Android 4.0 and above). Choose from numerous dynamic color-changing modes with adjustable speed and brightness levels or from static color modes. Add multiple LED RGB rod holders with optional terminal block (426624, sold separately). Constructed of formed 304 stainless steel. Patented.



⚠WARNING: Cancer and Reproductive Harm - www.P65Warnings.ca.gov



LED RGB ROD HOLDER CAP

PVC

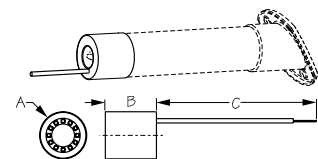

Bulk	Display	A	B	C	Lumens	Watts/Volts	Light Color	LEDs	Wt.(lb.)	Std. Pack
325188	325188-1	2"	2-1/4"	12"	200	2.4/12	RGB	12	.05	8 ea / 4 ea
n/a	403051-1	Bluetooth Smart Phone Controller - RGB							.22	4 ea
426624	426624-1	Optional Terminal Block (4 Position)							.06	10 ea

LED RGB Rod Holder Cap attaches on the bottom of any 2" diameter rod holder. A Bluetooth Smart Phone Controller (403051-1) lets you operate this RGB LED Rod Holder Cap from your smartphone (IOS 6 or Android 4.0 and above). Choose from numerous dynamic color-changing modes with adjustable speed and brightness levels or from static color modes. Add multiple LED RGB Rod Holder Caps with optional terminal block (426624). Patented. *ROD HOLDER SOLD SEPARATELY.

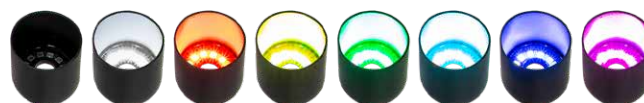

⚠WARNING: Cancer and Reproductive Harm - www.P65Warnings.ca.gov

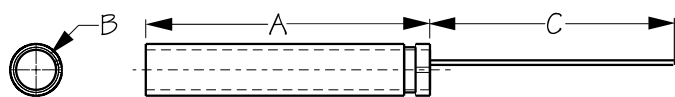

LED RGB ROD HOLDER TUBE INSERT

Rubber
NEW



Bulk	Display	A	B	C	Wt.(lb.)	Std. Pack
325189	325189-1	10"	1-5/8"	12"	.25	8 ea / 4 ea
n/a	403051-1	Bluetooth Smart Phone Controller - RGB			.22	4 ea
426624	426624-1	Optional Terminal Block (4-Position)			.06	10 ea



Retrofit your existing rod holder with the LED RGB Tube Insert. Just remove your existing liner, install the LED RGB Tube Insert and cut to your mounting face angle. A Bluetooth Smart Phone Controller (403051-1, sold separately) lets you operate this RGB LED Rod Holder Tube Insert from your smartphone (IOS 6 or Android 4.0 and above). Choose from numerous dynamic color-changing modes with adjustable speed and brightness levels or from static color modes. Add multiple LED RGB rod holders with optional terminal block (426624, sold separately). Patented.

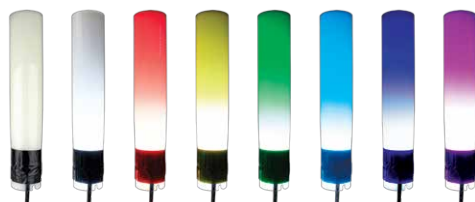

WARNING: Cancer and Reproductive Harm - www.P65Warnings.ca.gov

ECONOMY 90° FLUSH MOUNT ROD HOLDER WITH CAP

Formed 304 Stainless Steel

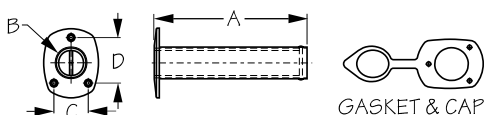

Bulk	Display	A	B	C	D	Fastener	Wt.(lb.)	Std. Pack
325173	325173-1	8-1/4"	1-9/16"	2-3/16"	3"	1/4" FH	1.25	8 ea
n/a	325238-1	Replacement Cap & Gasket				1/4" FH	.12	5 ea

A value priced, vertical mount rod holder! This Economy 90° Flush Mount Rod Holder with Cap can accommodate rods up to 1-1/2" in diameter. Features a 90° angle. Constructed of corrosion resistant formed 304 stainless steel with a plastic liner, mounting gasket, and integral cap. Installs with three #12 FH fasteners (not included).

WARNING: Cancer and Reproductive Harm - www.P65Warnings.ca.gov

FLUSH MOUNT ROD HOLDER WITH CAP

Formed 316 Stainless Steel

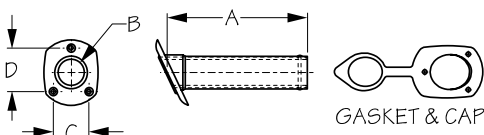

Bulk	Display	A	B	C	D	Fastener	Wt.(lb.)	Std. Pack
325175	325175-1	8-3/4"	1-1/2"	2-3/16"	3"	1/4" FH	1.50	8 ea
n/a	325239-1	Replacement Cap & Gasket				1/4" FH	.20	5 ea

This Flush Mount Rod Holder with Cap can accommodate rods up to 1-1/2" in diameter. Features a 30° angle. Constructed of corrosion resistant formed 316 stainless steel with a UV resistant PVC cap and PE liner. Installs with three #12 FH fasteners (not included). This new design has the same liner and cap that is used on the Cast Stainless Steel Rod Holder (325235).

WARNING: Cancer and Reproductive Harm - www.P65Warnings.ca.gov

FLUSH MOUNT ROD HOLDER

Formed 316 Stainless Steel

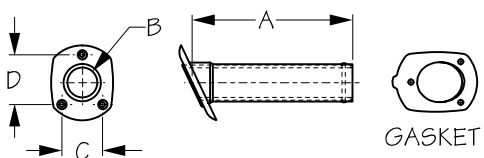

Bulk	Display	A	B	C	D	Fastener	Wt.(lb.)	Std. Pack
325176	325176-1	8-3/4"	1-1/2"	2-1/8"	3"	1/4" FH	1.50	8 ea
n/a	325239-1	Optional Cap & Gasket					.20	5 ea

This Flush Mount Rod Holder can accommodate rods up to 1-1/2" in diameter. Features a 30° angle. Constructed of corrosion resistant formed 316 stainless steel. Installs with three #12 FH fasteners (not included).

WARNING: Cancer and Reproductive Harm - www.P65Warnings.ca.gov



SIDE MOUNT ROD HOLDER

Formed 316 Stainless Steel

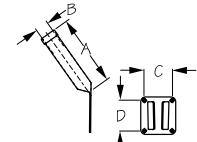

Bulk	Display	A	B	C	D	Fastener	Wt.(lb.)	Std. Pack	
325190	325190-1	9"	1-13/16"	2-15/16"	3-1/4"	1/4" FH	1.70	1 ea	
n/a	325199-1	Mounting Plate Only						.31	1 ea
OP32505	n/a	Replacement End Cap						.01	10 ea

This Side Mount Rod Holder slides in and out of its mounting plate for a lower profile when not in use. Accommodates rods up to 1-13/16" in diameter. Features a 30° angle. Constructed of corrosion resistant formed 316 stainless steel. Installs with four 1/4" FH fasteners (not included).



⚠WARNING: Cancer and Reproductive Harm - www.P65Warnings.ca.gov



90° FLUSH MOUNT ROD HOLDER WITH CAP

Investment Cast 316 Stainless Steel

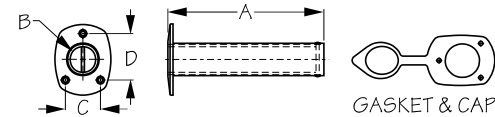

Bulk	Display	A	B	C	D	Fastener	Wt.(lb.)	Std. Pack	
325233	325233-1	9-5/8"	1-5/8"	2-3/16"	3"	1/4" FH	1.58	8 ea	
n/a	325238-1	Replacement Cap & Gasket						.12	5 ea

A high quality, vertical mount rod holder! This 90° Flush Mount Rod Holder with Cap can accommodate rods up to 1-5/8" in diameter. Features a 90° angle. Constructed of corrosion resistant investment cast 316 stainless steel with a plastic liner, integral cap, and mounting gasket. Installs with three 1/4" FH fasteners (not included).

⚠WARNING: Cancer and Reproductive Harm - www.P65Warnings.ca.gov



FLUSH MOUNT ROD HOLDER WITH CAP

Investment Cast 316 Stainless Steel

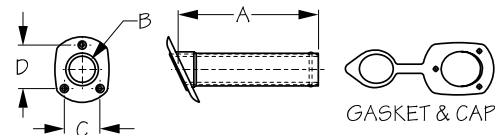

Bulk	Display	A	B	C	D	Fastener	Wt.(lb.)	Std. Pack	
325235	325235-1	8-3/4"	1-1/2"	2-3/16"	3"	1/4" FH	2.00	8 ea	
n/a	325239-1	Replacement Cap & Gasket						.20	5 ea

This Flush Mount Rod Holder with Cap is uniquely designed to incorporate a gasket, reducing leakage common on other cast rod holders. Accommodates rods up to 1-1/2" in diameter. Features a 30° angle. Constructed of corrosion resistant investment cast 316 stainless steel with a UV resistant PVC cap and full length PE liner. Installs with three 1/4" FH fasteners (not included). This new design has the same liner and cap that is used on the stamped stainless steel Rod Holder (325175).

⚠WARNING: Cancer and Reproductive Harm - www.P65Warnings.ca.gov



FLUSH MOUNT ROD HOLDER

Investment Cast 316 Stainless Steel

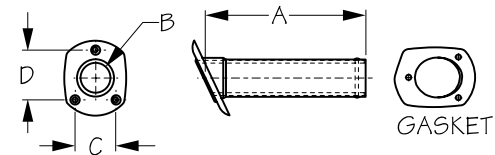

Bulk	Display	A	B	C	D	Fastener	Wt.(lb.)	Std. Pack	
325236	325236-1	8-3/4"	1-1/2"	2-3/16"	3"	1/4" FH	2.00	8 ea	
n/a	325239-1	Optional Cap & Gasket						.20	5 ea

This Flush Mount Rod Holder can accommodate rods up to 1-1/2" in diameter. Features a 30° angle. Constructed of corrosion resistant investment cast 316 stainless steel. Installs with three 1/4" FH fasteners (not included).

⚠WARNING: Cancer and Reproductive Harm - www.P65Warnings.ca.gov

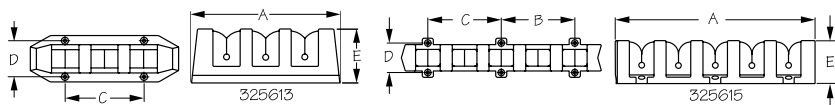

ROD STORAGE RACK

Injection Molded Polypropylene



Bulk	Display	A	B	C	D	E	Fastener	Wt.(lb.)	Std. Pack
n/a	325613-1	7-13/16"	n/a	4-3/16"	1-15/16"	2-7/8"	#8 FH	.22	5 pr
n/a	325615-1	11-3/8"	4-1/4"	4-1/4"	1-5/8"	2-7/16"	#8 FH	.47	5 pr

These Rod Storage Racks feature soft foam inserts for securing rods and reducing potential damage from rough seas. Constructed of UV resistant injection molded polypropylene. Installs with #8 FH fasteners (included). 325613 holds 3 rods. 325615 holds 5 rods.

⚠WARNING: Cancer and Reproductive Harm - www.P65Warnings.ca.gov

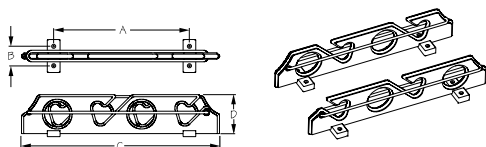

ROD STORAGE RACK

Polypropylene



Bulk	Display	A	B	C	D	# of Rod Holders	Fastener	Wt.(lb.)	Std. Pack
n/a	325624-1	10-7/16"	1-1/2"	15-1/8"	3"	4	#8 FH	.98	4 pr
n/a	325626-1	16"	1-1/2"	21-3/4"	3"	6	#8 FH	1.48	4 pr

Constructed of extremely durable, high-strength UV resistant polypropylene. For horizontal and overhead installation. Rods are secured with bungee cord attachment. Installs with twelve #8 FH fasteners (included).

⚠WARNING: Cancer and Reproductive Harm - www.P65Warnings.ca.gov

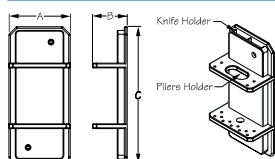

KNIFE & PLIERS HOLDER

Injection Molded Polypropylene



Bulk	Display	A	B	C	Fastener	Wt.(lb.)	Std. Pack
n/a	325925-1	3-7/8"	2-1/4"	8-7/8"	#6 FH	.64	5 ea

This Knife & Pliers Holder is great for storing knives, pliers, and fishing lures. Constructed of injection molded polypropylene. Installs with two #6 FH fasteners (included).

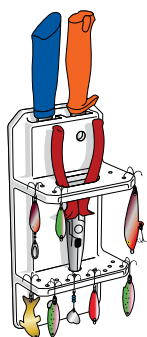

⚠WARNING: Cancer and Reproductive Harm - www.P65Warnings.ca.gov

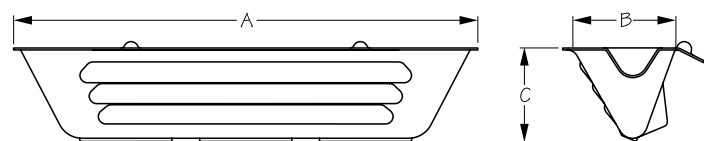

COHO FISH CLEANER™

Injection Molded Polypropylene



Bulk	Display	A	B	C	Wt.(lb.)	Std. Pack
325950	n/a	31-1/2"	10"	6-1/4"	2.40	4 ea

The Coho Fish Cleaner is easy to clean and maintain. Hooks attach to underside of gunnel (no holes required) allowing the tray to hang over the side of the boat, eliminating the mess of cleaning fish. Can be adapted to different mounting situations simply by changing the position of the adjustment knots. Constructed of strong high impact one-piece injection molded polypropylene for lightweight portability.

⚠WARNING: Cancer and Reproductive Harm - www.P65Warnings.ca.gov



FILLET & PREP TABLE ROD HOLDER MOUNT

Injection Molded Polypropylene/Stainless Steel

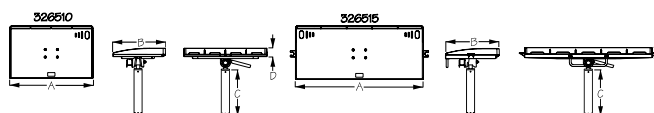

Bulk	Display	A	B	C	D	Table Size	Wt.(lb.)	Std. Pack
n/a	326510-3	20"	12-5/8"	12"	2"	Medium	4.00	1 ea
n/a	326515-3	30"	12-5/8"	12"	2-3/8"	Large	6.00	1 ea

- Solid one-piece construction for long life and easy maintenance
- Easily adjustable, multi-position gimbaled rod holder mounting system folds flat for storage
- UV stabilized high density polypropylene construction
- Medium: 20" wide by 12-5/8" deep, Large: 30" wide by 12-5/8" deep
- Assembles in minutes, all assembly hardware included
- Easily accessible knife and pliers holders, large table features additional hose holder and towel bar
- Knives and pliers not included
- Large table (326515-3) pictured



⚠WARNING: Cancer and Reproductive Harm - www.P65Warnings.ca.gov



FILLET & PREP TABLE ROUND RAIL MOUNT

Injection Molded Polypropylene

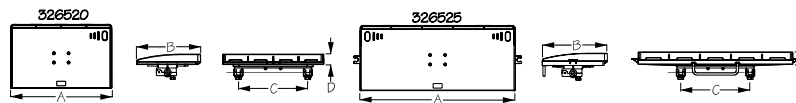

Bulk	Display	A	B	C	D	Table Size	Fits Tubing	Wt.(lb.)	Std. Pack
n/a	326520-3	20"	12-5/8"	13-1/2"	2"	Medium	3/4"-1-1/4"	3.50	1 ea
n/a	326525-3	30"	12-5/8"	13-1/2"	2-3/8"	Large	3/4"-1-1/4"	5.50	1 ea

- Solid one-piece construction for long life and easy maintenance
- Mounting system includes: rail mount adapter (326599-1), rail mount clamps (327199-1, pair), and all assembly hardware
- UV stabilized high density polypropylene construction
- Medium: 20" wide by 12-5/8" deep, Large: 30" wide by 12-5/8" deep
- Fits round tubing 3/4"-1-1/4" diameter
- Easily accessible knife and pliers holders, large table features additional hose holder and towel bar
- Knives and pliers not included
- Medium table (326520-3) pictured



Includes Rail Mount Adapter and Rail Mount Clamps



⚠WARNING: Cancer and Reproductive Harm
www.P65Warnings.ca.gov

FILLET & PREP TABLE SQUARE RAIL MOUNT

Injection Molded Polypropylene

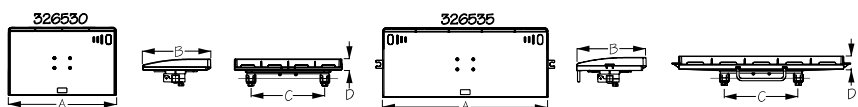

Bulk	Display	A	B	C	D	Table Size	Fits Tubing	Wt.(lb.)	Std. Pack
n/a	326530-3	20"	12-5/8"	13-1/2"	2"	Medium	1" - 1-1/4"	3.50	1 ea
n/a	326535-3	30"	12-5/8"	13-1/2"	2-3/8"	Large	1" - 1-1/4"	5.50	1 ea

- Solid one-piece construction for long life and easy maintenance
- Rail mounting system includes: (326599-1) rail mount adapter, removable square rail mount clamps (327197-1, pair), and all assembly hardware
- UV stabilized high density polypropylene construction
- Medium: 20" wide by 12-5/8" deep, Large: 30" wide by 12-5/8" deep
- Fits square tubing 1" - 1-1/4" diameter
- Assembles in minutes, all assembly hardware included
- Easily accessible knife and pliers holders, large table features additional hose holder and towel bar
- Knives and pliers not included
- Large table (326535-3) pictured

Includes Rail Mount Adapter and Sq. Rail Mount Clamps

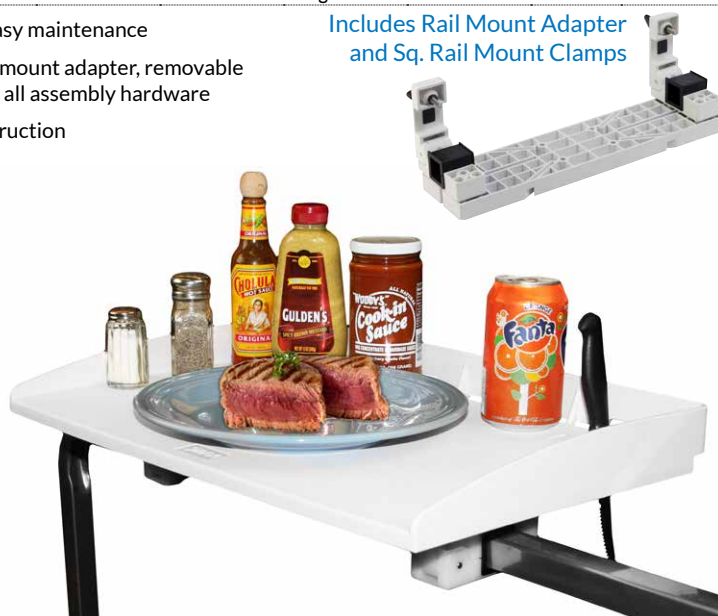

⚠WARNING: Cancer and Reproductive Harm
www.P65Warnings.ca.gov

FILLET & PREP TABLE ONLY

Injection Molded Polypropylene

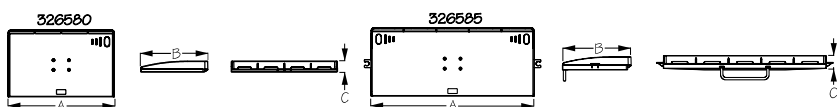

Bulk	Display	A	B	C	Table Size	Wt.(lb.)	Std. Pack
n/a	326580-3	20"	12-5/8"	2"	Medium	2.00	1 ea
n/a	326585-3	30"	12-5/8"	2-3/8"	Large	3.00	1 ea

- Solid one-piece construction for long life and easy maintenance
- UV stabilized high-density polypropylene construction
- Medium: 20" wide by 12-5/8" deep, Large: 30" wide by 12-5/8" deep
- Easily accessible knife and pliers holders, large table features additional hose holder and towel bar
- Knives and pliers not included
- Medium table (326580-3) pictured
- DOES NOT INCLUDE MOUNTING HARDWARE

⚠WARNING: Cancer and Reproductive Harm - www.P65Warnings.ca.gov

GIMBALED ROD HOLDER MOUNTING ACCESSORY

Injection Molded Polypropylene/Stainless Steel

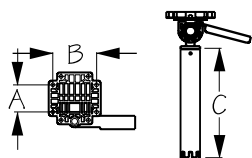

Bulk	Display	A	B	C	Fastener	Wt.(lb.)	Std. Pack
n/a	326598-1	1-13/16"	2-15/16"	12"	1/4" FH	1.84	1 ea



Gimbaled Rod Holder Mounting Accessory works on all of our fillet tables (326510-3, 326515-3, 326580-3, and 326585-3) and comes complete with all hardware necessary to attach the mount to the table. Great for mounting a variety of accessories. Constructed of injection molded polypropylene and stainless steel.

⚠WARNING: Cancer and Reproductive Harm - www.P65Warnings.ca.gov



FILLET & PREP TABLE RAIL MOUNT ADAPTER PLATE WITH HARDWARE

Injection Molded Polypropylene/Stainless Steel

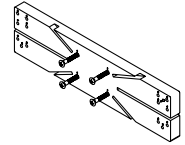

Bulk	Display	Description	Fastener	Wt.(lb.)	Std. Pack
n/a	326599-1	Fillet Table Rail Mount Adapter Plate with Hardware	1/4" FH	.25	1 ea

Fillet Table Rail Mount Adapter Plate works on the 326580-3 and 326585-3 fillet tables and comes complete with all hardware necessary to mount the plate to the table. Accepts the 327199-1 Removable Rail Mount Clamp (sold separately). Constructed of injection molded polypropylene and stainless steel.

⚠WARNING: Cancer and Reproductive Harm - www.P65Warnings.ca.gov

REMOVABLE SQUARE RAIL MOUNT CLAMPS

Injection Molded Nylon/Stainless Steel

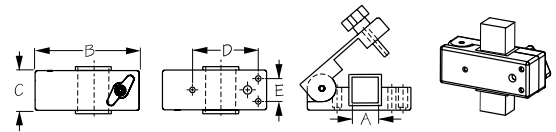

Bulk	Display	A	B	C	D	E	Wt.(lb.)	Std. Pack
n/a	327197-1	1" - 1-1/4"	3-7/8"	1-7/16"	2-1/2"	7/8"	.32	6 pr

Removable Square Rail Mount Clamps are great for retrofitting your existing rails to mount a wide variety of items, including fillet tables, solar panels, GPS, cell phone holders, cup holders, binocular racks, etc. Clamps fit 1" to 1-1/4" square tubing, making them ideal for pontoon boats. Includes shims, thumb screws, and all mounting hardware. Constructed of UV stabilized injection molded nylon with stainless hardware.



⚠WARNING: Cancer and Reproductive Harm - www.P65Warnings.ca.gov

REMOVABLE ROUND RAIL MOUNT CLAMPS

Injection Molded Nylon/EDPM/Stainless Steel

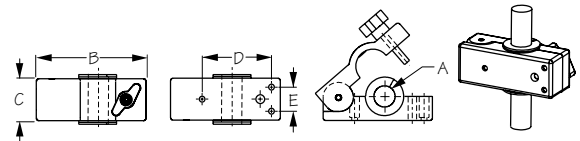

Bulk	Display	A	B	C	D	E	Wt.(lb.)	Std. Pack
n/a	327199-1	3/4", 1" & 1-1/4"	3-7/8"	1-7/16"	2-1/2"	7/8"	.32	6 pr

Removable Round Rail Mount Clamps are great for retrofitting your existing rails to mount a wide variety of items, including fillet tables, solar panels, GPS, cell phone holders, cup holders, binocular racks, etc. Clamps fit 3/4", 1", and 1-1/4" tubing. Includes shims, thumb screws, and all mounting hardware. Constructed of UV stabilized injection molded nylon with stainless hardware.



⚠WARNING: Cancer and Reproductive Harm - www.P65Warnings.ca.gov

RAIL MOUNT BRACKET KITS

Injection Molded Nylon/304 Stainless Steel

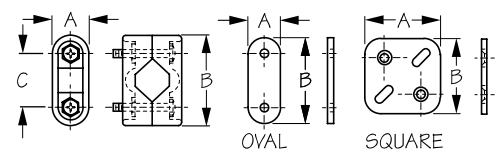

Bulk	Display	Description	A	B	C	Color	Fits Tubing	Fastener	Wt.(lb.)	Std. Pack
n/a	327101-1	Oval Plate Bracket Kit	3/4"	2"	1-1/4"	Black	7/8" - 1"	#10 RH	.26	10 pr
n/a	327102-1	Square Plate Bracket Kit	1-3/4"	1-3/4"	1-1/4"	Black	7/8" - 1"	#10 FH	.36	10 pr
n/a	327100-1	Brackets & Fasteners only	7/8"	2-1/8"	1-1/4"	Black	7/8" - 1"	#10 RH	.18	10 pr
n/a	327105-1	Brackets & Fasteners only	7/8"	2-1/8"	1-1/4"	White	7/8" - 1"	#10 RH	.18	10 pr

These Rail Mount Bracket Kits are designed for easy attachment to 7/8" - 1" tubing, allowing for positive attachment without scratching or marring the tubing. Great for Solar panels and Spreader lights. Constructed of injection molded nylon with 304 stainless hardware. Available with oval or square mounting plate. White brackets available separately. 327101-1 (Oval Plate Bracket Kit) includes 4 brackets, 2 oval plates, 4 #10-32 round head bolts, 4 #10-32 nuts and 2 rubber anti-slip strips. 327102-1 (Square Plate Bracket Kit) includes 4 brackets, 2 square plates, 4 #10-32 flat head bolts, 4 #10-32 nuts and 2 rubber anti-slip strips. Sold in pairs.

⚠WARNING: Cancer and Reproductive Harm - www.P65Warnings.ca.gov

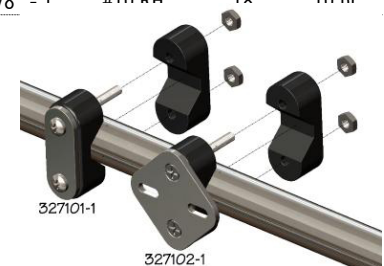

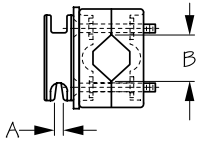

RAIL MOUNT LOOP CLEAT FENDER CLEAT

Injection Molded Nylon/Stainless Steel



Bulk	Display	A (Rope Size)	B	Wt.(lb.)	Std. Pack
n/a	327110-1	1/8" - 1/4"	7/8" - 1"	.23	10 ea

This Rail Mount Loop Fender Cleat includes a Clamcleat® Cub Cleat-CL232 (002320). This simple, economical fender accessory allows for easy attachment of fenders using up to 1/4" rope. Also see fender cleats, hooks, and holders (327200-1, 327234-1, 672510, and 672520). Constructed of UV resistant injection molded nylon with stainless hardware.

⚠WARNING: Cancer and Reproductive Harm - www.P65Warnings.ca.gov

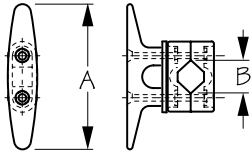

RAIL MOUNT CLEAT

Injection Molded Nylon/Stainless Steel



Bulk	Display	A	B	Wt.(lb.)	Std. Pack
n/a	327111-1	4-5/16"	7/8" - 1"	.25	10 ea

This Rail Mount Cleat includes Heavy Duty Cleat (043340). Ideal for easy attachment of fender, flag halyards, canvas tie downs, and related accessories. Constructed of UV resistant injection molded nylon with stainless hardware.

⚠WARNING: Cancer and Reproductive Harm - www.P65Warnings.ca.gov

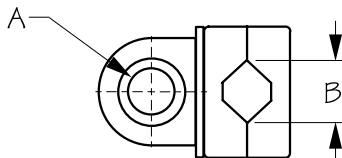

RAIL MOUNT FAIRLEAD WITH STAINLESS INSERT

Injection Molded Nylon/Stainless Steel



Bulk	Display	A	B	Wt.(lb.)	Std. Pack
n/a	327112-1	11/16"	7/8" - 1"	.26	10 ea

This Rail Mount Fairlead with Stainless Insert includes Fairlead (082615). Allows easy routing of roller furling lines. The stainless insert allows use of wire lines if necessary. Constructed of UV resistant injection molded nylon with stainless hardware.

⚠WARNING: Cancer and Reproductive Harm - www.P65Warnings.ca.gov

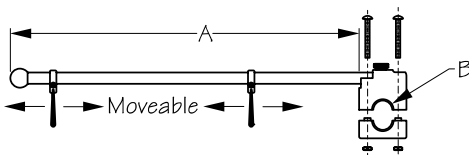

ADJUSTABLE RAIL MOUNT FLAGPOLE

Injection Molded Nylon/Stainless Steel



Bulk	Display	A	B	Wt.(lb.)	Std. Pack
n/a	327122-1	15-1/4"	7/8" - 1"	.36	5 ea
n/a	327124-1	28-1/4"	7/8" - 1"	.55	5 ea
n/a	328197-1	Nylon Flagpole Pennant Mounts (328190) & Stainless Clips (328196) (set of 2)		.08	10 ea
n/a	327194-1	Rail Mount Bracket For Flagpole-Round		.10	10 ea
328112	328112-1	Replacement Flag Pole - 17"		.24	5 ea
328114	328114-1	Replacement Flag Pole - 30"		.44	5 ea
n/a	328190-1	Nylon Adjustable Flag Pole Mounts - 1/2"		.02	10 pr
n/a	328195-1	Stainless Flag Pole Hole Mount Pennant Clips (set of 4)		.04	10 sets
n/a	328196-1	Stainless Flag Pole Eye Mount Pennant Clips (set of 4)		.04	10 sets

These Adjustable Rail Mount Flagpoles attach flags using nylon pennant mounts with spring wire quick release clips designed to hold their shape through continued use. Both pennant mounts can move either direction on the flagpole, allowing flexibility in mounting various sizes of flags where the eyelets of the flag are less than the overall length of the flagpole. For use on either 7/8" or 1" tubing. Maximum speed 10 MPH. Constructed of highly polished, corrosion resistant, heavy wall, stainless steel tubing with an injection molded nylon rail mount bracket and clips.

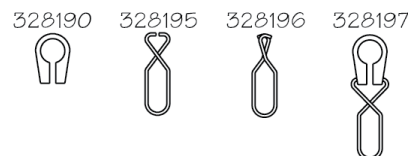



RAIL MOUNT FLAGPOLE

Injection Molded Nylon/Stainless Steel

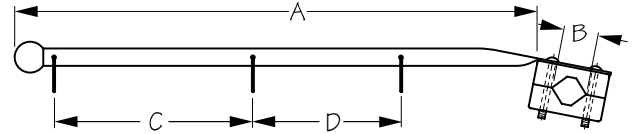

Bulk	Display	A	B	C	D	Wt.(lb.)	Std. Pack
n/a	327120-1	15-1/2"	7/8" - 1"	5-11/16"	4-1/4"	.28	5 ea

The Rail Mount Flagpole is designed for easy attachment of flags using split rings. Maximum speed 10 MPH. Constructed of corrosion resistant stainless steel with a UV resistant injection molded nylon rail mount bracket and split rings.



RAIL MOUNT RING BUOY BRACKET

Stamped Aluminum Powder Coated

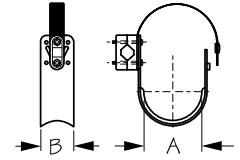

Bulk	Display	A	B	Wt.(lb.)	Std. Pack
n/a	327130-1	3-7/8"	2"	.37	5 ea
n/a	327100-1	Replacement Brackets		.18	10 pr

This Rail Mount Ring Buoy Bracket can be used on 7/8" or 1" tubing or mounted directly to a flat surface. Includes all necessary hardware for rail mounting. Constructed of marine grade stamped aluminum and powder coated for a long-lasting finish.

⚠WARNING: Cancer and Reproductive Harm - www.P65Warnings.ca.gov



RAIL MOUNT FIXED ANTENNA BASE

Formed 304 Stainless Steel

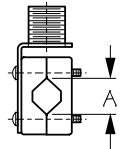

Bulk	Display	Description	A	Wt.(lb.)	Std. Pack
327140	n/a	Rail Mount Fixed Antenna Base (Base Only)	n/a	.20	5 ea
n/a	327141-1	Rail Mount Fixed Antenna Base with Mounting Brackets	7/8" - 1"	.29	5 ea

These Rail Mount Fixed Antenna Bases are designed to allow an antenna wire to feed directly through the base. Ideal for Loran, GPS, and CB antennas with standard 1"-14 threads (NOT recommended for whips over 8'). Can be mounted on either vertical or horizontal rails, as well as any flat surface. Constructed of corrosion resistant formed 304 stainless steel. 327141-1 includes UV stabilized injection molded nylon mounting brackets for use on 7/8" and 1" tubing.



RAIL MOUNT ADJUSTABLE ANTENNA BASE

Investment Cast 316 Stainless Steel

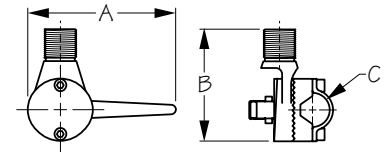

Bulk	Display	A	B	C	Wt.(lb.)	Std. Pack
327145	327145-1	4-5/8"	3-7/16"	7/8" - 1"	1.26	1 ea

This Ratchet Rail Mount Adjustable Antenna Base features a lever action lay-down handle that makes lowering antenna quick and easy for passing under bridges, storage, and trailering. Accepts any standard antenna with 1"-14 threads (NOT recommended for whips over 8'). Can be mounted on either 7/8" and 1" vertical or horizontal rails. Constructed of corrosion resistant investment cast 316 stainless steel.



RAIL MOUNT ADJUSTABLE ANTENNA BASE

Injection Molded Nylon

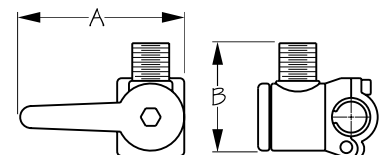

Bulk	Display	A	B	Fits Tubing	Wt.(lb.)	Std. Pack
327148	327148-1	4-5/16"	2-13/16"	7/8" - 1"	.34	5 ea

This Rail Mount Adjustable Antenna Base features a lever action lay-down handle that makes lowering antenna quick and easy for passing under bridges, storage, and trailering. Accepts any standard antenna with 1"-14 threads (NOT recommended for whips over 8'). Can be mounted on either 7/8" and 1" vertical or horizontal rails. Constructed of UV resistant injection molded nylon.

⚠WARNING: Cancer and Reproductive Harm - www.P65Warnings.ca.gov

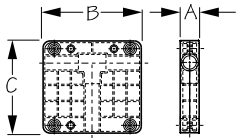

RAIL MOUNT MOTOR BRACKET

Injection Molded Polypropylene

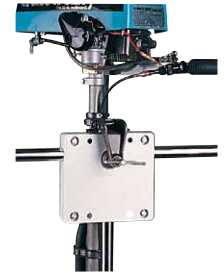

Bulk	Display	A	B	C	Color	HP Rating	Wt.(lb.)	Std. Pack
327150	327150-1	1-9/16"	6-11/16"	6-11/16"	White	8 HP (2-Cycle Only)	1.12	5 ea
327151	327151-1	1-9/16"	6-11/16"	6-11/16"	Black	8 HP (2-Cycle Only)	1.12	5 ea

These Rail Mount Motor Brackets are designed to hold small, 2-cycle outboards up to 8 HP upright on the stern rail. Will fit both 7/8" and 1" rails, as well as rails using 90° tee fittings. Most other polypropylene and wood motor brackets only fit 1" welded rails. The two-piece unit features extra holes, enabling the use of a recommended chain to secure the motor. Can also be used as a mounting platform for barbecues, down rigger brackets, fish cleaning tables, etc. Constructed of UV stabilized polypropylene. Includes all necessary fasteners. Available in black or white.

⚠WARNING: Cancer and Reproductive Harm - www.P65Warnings.ca.gov

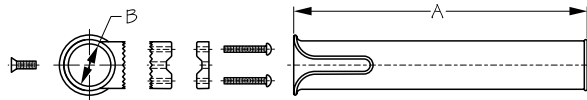

RAIL MOUNT ROD HOLDER

Injection Molded Polypropylene



Bulk	Display	Color	A	B	Fits Tubing	Wt.(lb.)	Std. Pack
327160	327160-1	Black	11-3/4"	1-3/4"	7/8" - 1"	.42	8 ea
327161	327161-1	White	11-3/4"	1-3/4"	7/8" - 1"	.42	8 ea

These Rail Mount Rod Holders can accommodate rods up to 1-3/4" in diameter. Features a front mount adjustment screw, allowing easy adjustment without having to disassemble the rail mount brackets. A leash on the rod and/or reel is recommended when using rail mount rod holders. Constructed of injection molded polypropylene. Available in black or white.

⚠WARNING: Cancer and Reproductive Harm - www.P65Warnings.ca.gov

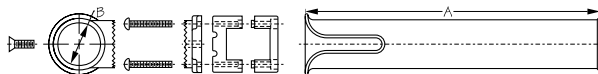

RAIL MOUNT ROD HOLDER - SQUARE RAIL

Injection Molded Polypropylene



Bulk	Display	Color	A	B	Fits Tubing	Wt.(lb.)	Std. Pack
327166	327166-1	White	11-3/4"	1-3/4"	1-1/4" x 1-1/4"	.50	8 ea

These Square Rail Mount Rod Holders can accommodate rods up to 1-3/4" in diameter. Features a front mount adjustment screw, allowing easy adjustment without having to disassemble the rail mount brackets. Designed to fit 1-1/4" square rails. A quick and easy way to add rod holders to pontoon boats! A leash on the rod and/or reel is recommended when using rail mount rod holders. Constructed of injection molded polypropylene.

⚠WARNING: Cancer and Reproductive Harm - www.P65Warnings.ca.gov

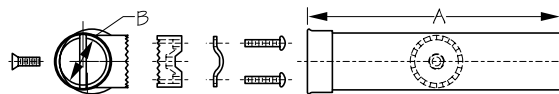

RAIL MOUNT ROD HOLDER

Formed & Cast 316 Stainless Steel



Bulk	Display	A	B	Fits Tubing	Wt.(lb.)	Std. Pack
327175	327175-1	9"	1-11/16"	7/8" - 1"	1.65	8 ea
OP32505	n/a	Replacement End Cap			.01	10 ea

This Rail Mount Rod Holder can accommodate rods up to 1-11/16" in diameter. Features a front mount adjustment screw, allowing easy adjustment without having to disassemble the rail mount brackets. Designed to fit 7/8" to 1" diameter tubing. A leash on the rod and/or reel is recommended when using rail mount rod holders. Constructed of corrosion resistant formed and cast 316 stainless steel with black plastic end cap.

⚠WARNING: Cancer and Reproductive Harm - www.P65Warnings.ca.gov



RAIL MOUNT BRACKET - ROUND

Injection Molded Nylon/Stainless Steel Screws

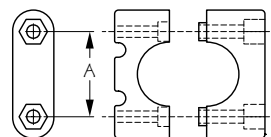

Bulk	Display	A	Fits Tubing	Color	Wt.(lb.)	Std. Pack
n/a	327190-1	1-5/16"	7/8" - 1"	Black	.05	10 pr
n/a	327191-1	1-9/16"	1-1/8"-1-1/4"	Black	.06	10 pr

Round Rail Mount Bracket for use on 7/8" and 1" tubing. Constructed of corrosion resistant UV stabilized injection molded nylon. Installs with two RH fasteners and nuts (included). Available in black or white.

⚠WARNING: Cancer and Reproductive Harm - www.P65Warnings.ca.gov



RAIL MOUNT BRACKET FOR FLAGPOLE - ROUND

Injection Molded Nylon/Stainless Steel Screws

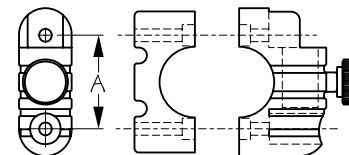

Bulk	Display	A	Fits Tubing	Pole Diameter	Color	Wt.(lb.)	Std. Pack
n/a	327194-1	1-5/16"	7/8" - 1"	1/2"	Black	.10	10 ea

Round Rail Mount Bracket is for use on 7/8" and 1" tubing. Constructed of corrosion resistant UV stabilized injection molded nylon. Installs with two RH fasteners and nuts (included). Accommodates Sea-Dog® Round Flagpoles (328112-1 and 328114-1) 1/2" diameter. Maximum speed 10 MPH.

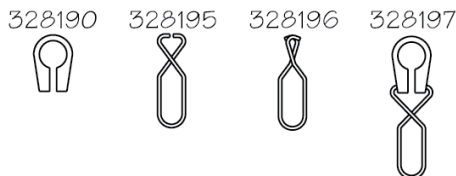

⚠WARNING: Cancer and Reproductive Harm - www.P65Warnings.ca.gov



FENDERMATE™

Injection Molded Nylon

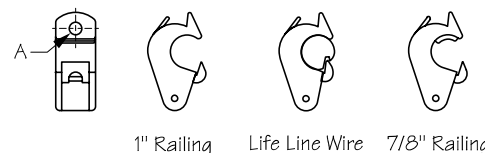

Bulk	Display	A (Line Size)	Wt.(lb.)	Std. Pack
n/a	327200-1	1/4"-5/16"	.30	10 pr

Fendermate™ is the latest in fender brackets. Clamps securely on both 7/8" and 1" round tubing and 3/16" and 1/4" life line wire. Unique double locking action locks the clamp on the rail or wire while still allowing full adjustment of the height of the fender. When the proper height is reached, the final locking action clamps the rope quickly and securely. Constructed of marine grade reinforced injection molded nylon.

⚠WARNING: Cancer and Reproductive Harm - www.P65Warnings.ca.gov



RAIL MOUNT DUAL FENDER HOLDER

Formed 304 Stainless Steel

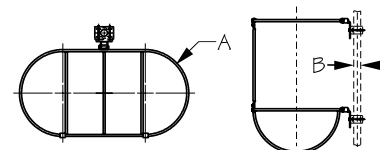

Bulk	Display	A	B	Wt.(lb.)	Std. Pack
n/a	327357-1	7-1/2"	7/8"-1"	1.82	1 ea
n/a	327359-1	9-1/2"	7/8"-1"	2.32	1 ea
n/a	327361-1	11-1/2"	7/8"-1"	2.82	1 ea

The Rail Mount Dual Fender Holder is for use on 7/8" or 1" tubing. Easy to mount, these fender holders adjust to any angle of railing and can hold any style fender. Folds flat for easy storage when not in use. Constructed of corrosion resistant formed 304 stainless steel. Fenders not included.

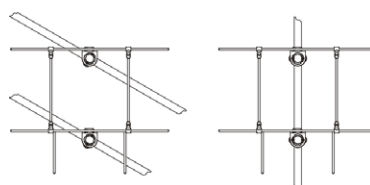

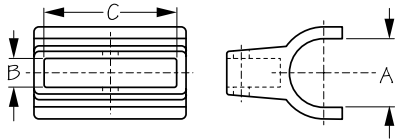

RAIL MOUNT BOW SOCKET

Injection Molded Nylon



Bulk	Display	A	B	C	Wt.(lb.)	Std. Pack
327400	327400-1	7/8"	3/8"	1-11/16"	.04 / .08	10 ea / 10 pr

This Rail Mount Bow Socket is designed to fit snugly on a 7/8" round rail without the use of fasteners. Used in conjunction with battens to assemble a rounded support structure for a boat cover they can be easily removed when the cover is not in use. Constructed of injection molded nylon.

▲WARNING: Cancer and Reproductive Harm - www.P65Warnings.ca.gov

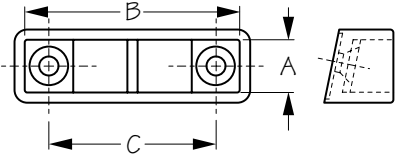

DECK MOUNT BOW SOCKET

Injection Molded Nylon



Bulk	Display	A	B	C	Color	Fastener	Wt.(lb.)	Std. Pack
327410	327410-1	7/16"	2"	1-5/8"	White	#10 FH	.02 / .04	10 ea / 10 pr
327411	n/a	7/16"	2"	1-5/8"	Black	#10 FH	.02	10 ea

These Deck Mount Bow Sockets are used in conjunction with battens to assemble a rounded support structure for a boat cover. Part of a system to disperse rain water to avoid water from accumulating in the center of the cover. Recessed base design accepts sealant, allowing for a watertight seal without the use of gaskets. Constructed of injection molded nylon. Installs with two #10 FH fasteners (not included). Available in black or white.

▲WARNING: Cancer and Reproductive Harm - www.P65Warnings.ca.gov

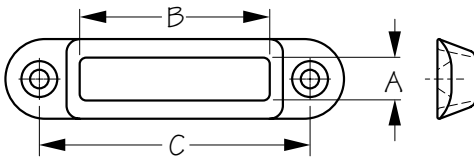

DECK MOUNT BOW SOCKET

Die Cast Zinc Chrome Plated



Bulk	Display	A	B	C	Fastener	Wt.(lb.)	Std. Pack
327415	327415-1	3/8"	1-13/16"	2-9/16"	#8 FH	.05 / .10	10 ea / 10 pr

This Deck Mount Bow Socket is used in conjunction with battens to assemble a rounded support structure for a boat cover. Part of a system to disperse rain water to avoid water from accumulating in the center of the cover. Constructed of die cast chrome plated zinc. Installs with two #8 FH fasteners (not included). Recommended for fresh water use.

▲WARNING: Cancer and Reproductive Harm - www.P65Warnings.ca.gov

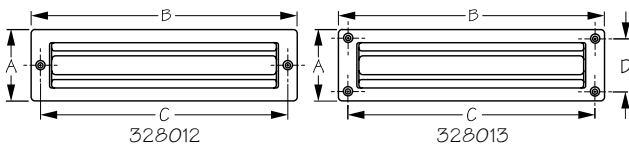

DECK STEP

Injection Molded Rubber/Stamped 304 Stainless Steel



Bulk	Display	A	B	C	D	Fastener	Wt.(lb.)	Std. Pack	
328012	328012-1	2-1/4"	8-3/8"	7-11/16"	n/a	#8 FH	.11 / .22	10 ea / 10 pr	
328013	328013-1	3-3/8"	8-7/8"	8-3/16"	2-13/16"	#8 FH	.35 / .70	10 ea / 10 pr	
n/a	328017-1	Replacement Pad for 328012						.44	5 pr

These Deck Steps are lined with injection molded rubber to facilitate traction. Constructed of corrosion resistant stamped 304 stainless steel. 3/16" thick from surface. 328012 pictured.

▲WARNING: Cancer and Reproductive Harm - www.P65Warnings.ca.gov

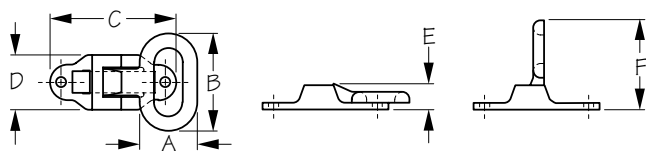

FOLDING STEP

Investment Cast 316 Stainless Steel



Bulk	Display	A	B	C	D	E	F	Fastener	Wt.(lb.)	Std. Pack
328020	328020-1	2"	3-3/8"	4-3/8"	1-7/8"	7/8"	3-7/16"	5/16" RH	.98	5 ea

This Folding Step has a patterned, texture finish for better traction. The spring loaded folding mechanism will keep the step in the open or closed position without rattling. Constructed of corrosion resistant investment cast stainless steel. Installs with two 5/16" RH fasteners (not included). Also see Sea-Dog® Chrome Brass Step (322620).



FOLDING STEP

Formed 304 Stainless Steel

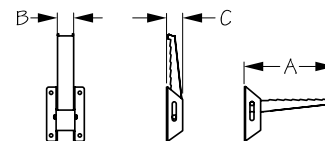

Bulk	Display	A	B	C	Fastener	Wt.(lb.)	Std. Pack
328025	328025-1	5-5/8"	1"	1"	#10 FH	.44	5 ea

The ultimate step at a very competitive price! This Folding Step can be locked in a rattle-free, upright position when not in use. The unique design features a sawtooth, edged step to provide secure footing when working on the mast or other areas where an additional step is needed but available space is limited. Usable tread is 1" W x 4-1/4" L. Overall length is 5-5/8". Constructed of stamped 304 stainless with a tumbled and electro-polished finish. Installs with four #10 FH fasteners (not included).



ANCHOR LIFT & LOCK BOW ROLLER

Electro-Galvanized Steel

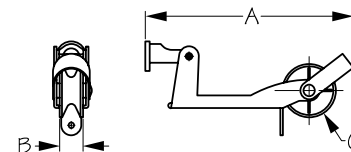

Bulk	Display	A	B	C	Max. Anchor Weight	Rope Dia.	Fastener	Wt.(lb.)	Std. Pack
328040	328040-1	6-13/16"	13/16"	1-7/8"	20 lbs.	3/8" Max.	#10 RH	.48	5 ea

This Anchor Lift & Lock Bow Roller makes it easier to set and retrieve your anchor. Designed for one-handed use by simply lifting up on the line to release the locking system. Then feed the rope until desired anchor depth is achieved. Lower the line down and the weight of the anchor will activate the braking mechanism, locking the line in place. Handles line up to 3/8" diameter. Constructed of electro-galvanized steel. Installs with four #10 RH fasteners (not included).

⚠WARNING: Cancer and Reproductive Harm - www.P65Warnings.ca.gov



SHORT BOW ROLLER

Investment Cast 316 Stainless Steel

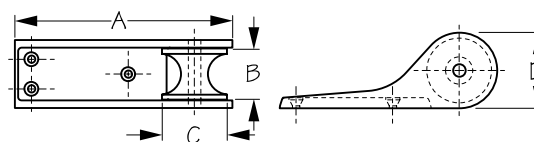

Bulk	Display	A	B	C	D	Rope Dia.	Fastener	Wt.(lb.)	Std. Pack
328050	n/a	7-7/8"	1-7/8"	2-3/8"	2-11/16"	1" Max.	1/4" RH	3.44	1 ea

This Short Bow Roller makes dropping and weighing anchor a breeze. Easy to use, it reduces the risk of damage to the hull or deck. The wheel accommodates rope up to 1" in diameter. Constructed of corrosion resistant investment cast 316 stainless steel. Installs with three 1/4" RH fasteners (not included).



EXTENDED FAIRLEAD BOW ROLLER

Investment Cast 316 Stainless Steel

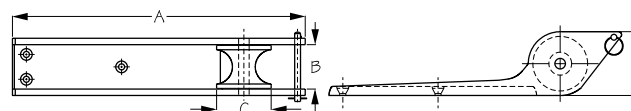

Bulk	Display	A	B	C	D	Rope Dia.	Fastener	Wt.(lb.)	Std. Pack
328050L	n/a	12-1/2"	1-15/16"	2-3/8"	2-11/16"	1" Max.	1/4" RH	4.36	1 ea
OP32801	n/a	Replacement	Release Pin					.03	1 ea

This Extended Fairlead Bow Roller is easy to use and reduces the risk of damage to the hull or deck. The wheel accommodates rope up to 1" in diameter. Constructed of corrosion resistant investment cast 316 stainless steel. Installs with three 1/4" RH fasteners (not included).



PLATFORM BOW ROLLER

Stamped 304 Stainless Steel

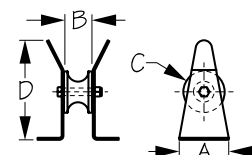

Bulk	Display	A	B	C	D	Rope Dia.	Fastener	Wt.(lb.)	Std. Pack
328051	n/a	3"	1-3/4"	2-1/2"	6"	1" Max.	3/8" Bolt	1.33	1 ea
n/a	328059-1	Replacement Wheel for 328051 (1-3/4" x 2-1/2")						.26	5 ea

These Platform Bow Rollers are designed to handle most fluke style anchors using a variety of platform or bowsprit mounting options. The flanges hold the flukes of the anchor securely, reducing the risk of damage to the hull. The rubber wheel accommodates rope up to 1" in diameter. Constructed of corrosion resistant stamped 304 stainless steel. Installs with four 3/8" bolts (not included).

⚠WARNING: Cancer and Reproductive Harm - www.P65Warnings.ca.gov

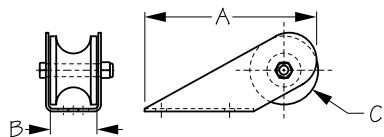

SHORT BOW ROLLER

Stamped 304 Stainless Steel



Bulk	Display	A	B	C	Rope Dia.	Finish	Fastener	Wt.(lb.)	Std. Pack
328052	n/a	6-1/4"	1-3/4"	2-1/2"	1" Max.	Unpolished	3/8" Bolt	1.08	1 ea
n/a	328059-1	Replacement Wheel (1-3/4" x 2-1/2")						.26	5 ea

This Short Bow Roller makes dropping and weighing anchor a breeze. Easy to use, it reduces the risk of damage to the hull or deck. The rubber wheel accommodates rope up to 1" in diameter. Constructed of corrosion resistant stamped 304 stainless steel. Installs with three 3/8" bolts (not included).

▲WARNING: Cancer and Reproductive Harm - www.P65Warnings.ca.gov

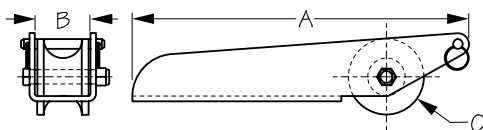

EXTENDED FAIRLEAD BOW ROLLER

Stamped 304 Stainless Steel



Bulk	Display	A	B	C	Rope Dia.	Finish	Fastener	Wt.(lb.)	Std. Pack
328053	n/a	11"	1-3/4"	2-1/2"	1" Max.	Unpolished	3/8" Bolt	2.46	1 ea
n/a	328059-1	Replacement Wheel (1-3/4" x 2-1/2")						.26	5 ea
OP32801	n/a	Replacement Release Pin						.03	1 ea

This Extended Fairlead Bow Roller is easy to use and reduces the risk of damage to the hull or deck. The rubber wheel accommodates rope up to 1" in diameter. Constructed of corrosion resistant stamped 304 stainless steel. Installs with three 3/8" bolts (not included).

▲WARNING: Cancer and Reproductive Harm - www.P65Warnings.ca.gov

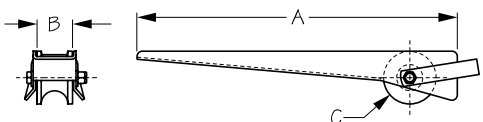

SEA-HOOK® STYLE BOW ROLLER

Stamped 304 Stainless Steel



Bulk	Display	A	B	C	Rope Dia.	Finish	Fastener	Wt.(lb.)	Std. Pack
328054	n/a	15-1/2"	1-3/4"	2-1/2"	1" Max.	Unpolished	3/8" Bolt	2.38	1 ea
n/a	328059-1	Replacement Wheel (1-3/4" x 2-1/2")						.26	5 ea

▲WARNING: Cancer and Reproductive Harm - www.P65Warnings.ca.gov

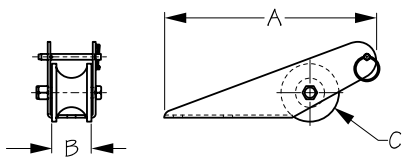

MEDIUM FAIRLEAD BOW ROLLER

Stamped 304 Stainless Steel



Bulk	Display	A	B	C	Rope Dia.	Fastener	Wt.(lb.)	Std. Pack	
328057	n/a	9"	1-3/4"	2-1/2"	1" Max.	3/8" Bolt	1.48	1 ea	
n/a	328059-1	Replacement Wheel (1-3/4" x 2-1/2")						.26	5 ea
OP32801	n/a	Replacement Release Pin						.03	1 ea

This Medium Fairlead Bow Roller is easy to use and reduces the risk of damage to the hull or deck. The rubber wheel accommodates rope up to 1" in diameter. Constructed of corrosion resistant stamped 304 stainless steel. Installs with three 3/8" bolts (not included).

▲WARNING: Cancer and Reproductive Harm - www.P65Warnings.ca.gov

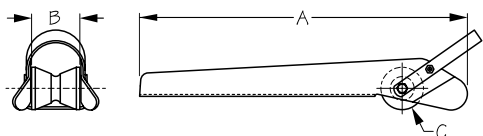

MEDIUM ANCHOR BOW ROLLER

Stamped 304 Stainless Steel



Bulk	Display	A	B	C	Finish	Rope Dia.	Fastener	Wt.(lb.)	Std. Pack
328064	n/a	19-1/4"	2-15/16"	2-3/4"	Unpolished	1-1/2" Max.	3/8" Bolt	5.00	1 ea
n/a	328069-1	Replacement Wheel (2-15/16" x 2-3/4")						.59	5 ea

▲WARNING: Cancer and Reproductive Harm - www.P65Warnings.ca.gov



PIVOTING MEDIUM BOW ROLLER

Stamped 304 Stainless Steel

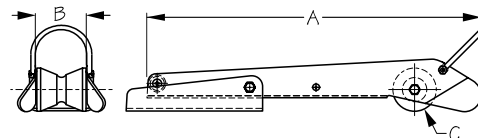

Bulk	Display	A	B	C	Rope Dia.	Fastener	Wt.(lb.)	Std. Pack
328068	n/a	21"	2-15/16"	2-3/4"	1-1/2" Max.	3/8" Bolt	8.30	1 ea
n/a	328069-1	Replacement Wheel (2-15/16" x 2-3/4")					.59	5 ea

This Pivoting Medium Bow Roller is designed to create a self-launching anchor system. As the anchor line is played out, the anchor roller pivots downward under the weight, allowing it to fall freely into the water. The rubber wheel accommodates rope up to 1-1/2" in diameter. Constructed of corrosion resistant stamped 304 stainless steel. Installs with 3/8" bolts (not included).

⚠WARNING: Cancer and Reproductive Harm - www.P65Warnings.ca.gov



LARGE ANCHOR BOW ROLLER

Stamped 304 Stainless Steel

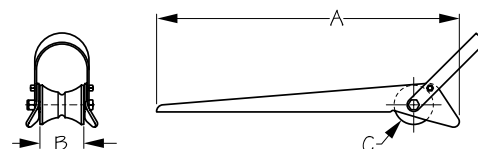

Bulk	Display	A	B	C	Rope Dia.	Wt.(lb.)	Std. Pack
328074	n/a	23"	3-3/8"	3"	1-1/2" Max.	8.00	1 ea
n/a	328079-1	Replacement Wheel (3-3/8" x 3")				.74	5 ea

Note: Does not have drilled mounting holes.

⚠WARNING: Cancer and Reproductive Harm - www.P65Warnings.ca.gov



LARGE PLATFORM BOW ROLLER

Stamped 304 Stainless Steel

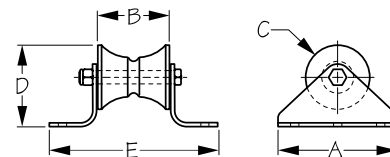

Bulk	Display	A	B	C	D	Rope Dia.	Fastener	Wt.(lb.)	Std. Pack
328076	n/a	5-5/8"	3-3/8"	3"	3-7/8"	1-1/2" Max.	3/8" Bolt	3.00	1 ea
n/a	328079-1	Replacement Wheel (3-3/8" x 3")						.74	5 ea

This Large Platform Bow Roller is designed to handle most fluke style anchors and mount in or under the anchor slot of a platform or bow plank. The rubber wheel accommodates rope up to 1-1/2" in diameter. Constructed of corrosion resistant stamped 304 stainless steel. Installs with six 3/8" bolts (not included).

⚠WARNING: Cancer and Reproductive Harm - www.P65Warnings.ca.gov



STERN FAIRLEAD ANCHOR ROLLER

Stamped 304 Stainless Steel

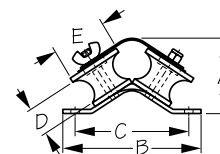

Bulk	Display	A	B	C	D	E	Fastener	Wt.(lb.)	Std. Pack
328090	n/a	3-7/16"	6-5/16"	5-3/16"	1-3/16"	2-1/2"	3/8" Bolt	1.33	1 ea

Stern Fairlead Anchor Roller is for line that may swing from one side or the other. Also used for bow anchoring. Handles line up to 1" diameter and chain up to 3/8". Constructed of corrosion resistant stamped 304 stainless steel. Installs with two 3/8" bolts (not included).

⚠WARNING: Cancer and Reproductive Harm - www.P65Warnings.ca.gov



REPLACEMENT BOW ROLLER WHEELS

Natural Rubber/Brass Insert

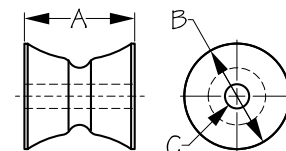

Bulk	Display	A	B	C	Wt.(lb.)	Std. Pack
n/a	328059-1	1-3/4"	2-1/2"	7/16"	.26	5 ea
n/a	328069-1	2-15/16"	2-3/4"	5/8"	.59	5 ea
n/a	328079-1	3-3/8"	3"	5/8"	.74	5 ea

These Replacement Bow Roller Wheels are constructed of natural rubber and feature a brass insert for added strength.

⚠WARNING: Cancer and Reproductive Harm - www.P65Warnings.ca.gov

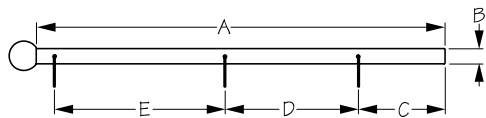

BOW FORM FLAGPOLE

Formed 304 Stainless Steel



Bulk	Display	A	B	C	D	E	Wt.(lb.)	Std. Pack
328110	328110-1	13-3/16"	1/2"	3"	4-1/4"	5-11/16"	.15	5 ea

This Bow Form Flagpole fits most bow forms with 1/2" diameter flagpole mounting holes. Each flagpole comes complete with split rings for easy flag attachment. Fits in Sea-Dog® Bow Forms (295110 - 295140). Maximum speed 10 MPH. Constructed of corrosion resistant formed 304 stainless steel.

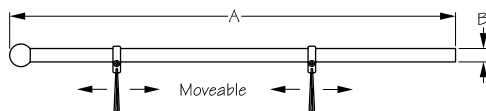

ADJUSTABLE BOW FORM FLAGPOLE

Stainless Steel/Injection Molded Nylon/Polypropylene



Bulk	Display	A	B	Wt.(lb.)	Std. Pack
328112	328112-1	16-3/4"	1/2"	.24	5 ea
328114	328114-1	29-7/8"	1/2"	.44	5 ea
n/a	328190-1	Nylon Adjustable Flagpole Clips - 1/2"		.02	10 pr
n/a	328195-1	Stainless Flagpole Hole Mount Pennant Clips (set of 4)		.04	10 sets
n/a	328196-1	Stainless Flagpole Eye Mount Pennant Clips (set of 4)		.04	10 sets
n/a	328197-1	Nylon Flagpole Pennant Mounts (328190) & Stainless Clips (328196) (set of 2)		.08	10 ea

These Adjustable Bow Form Flagpoles attach flags using nylon pennant mounts with spring wire quick release clips designed to hold their shape through continued use. Both pennant mounts can move either direction on the flagpole, allowing flexibility in mounting various sizes of flags where the eyelets of the flag are less than the overall length of the flagpole. Maximum speed 10 MPH. Constructed of highly polished, corrosion resistant, heavy wall, stainless steel tubing.

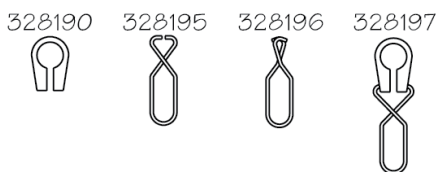

▲WARNING: Cancer and Reproductive Harm - www.P65Warnings.ca.gov

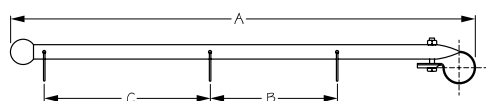

PULPIT FLAGPOLE

Formed 304 Stainless Steel/Polyethylene



Bulk	Display	A	B	C	Wt.(lb.)	Std. Pack
328115	328115-1	16-3/8"	4-1/2"	5-13/16"	.16	5 ea

This Pulpit Flagpole fits 7/8" or 1" tubing. Each flagpole comes complete with split rings for easy flag attachment. A polyethylene spacer reduces the possibility of scratching the railing. Maximum speed 10 MPH. Constructed of corrosion resistant formed 304 stainless steel. Fasteners included.

▲WARNING: Cancer and Reproductive Harm - www.P65Warnings.ca.gov

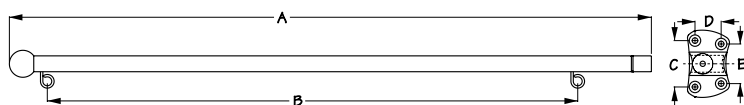

SIDE MOUNT FLAGPOLE

Formed 304 Stainless Steel



Bulk	Display	A	B	C	D	E	Wt.(lb.)	Std. Pack
328120	328120-1	20-1/4"	16-3/4"	1-7/16"	13/16"	1-1/4"	.39	5 ea

Side Mount Flagpole is easily removed for storage. Maximum speed 10 MPH. Constructed of corrosion resistant formed 304 stainless steel.



TRANSOM GUDGEON

Stamped 304 Stainless Steel

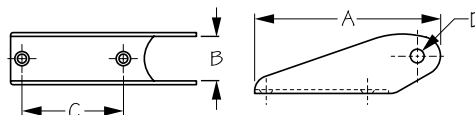

Bulk	Display	A	B	C	D	Fastener	Wt.(lb.)	Std. Pack
328150	328150-1	4-1/2"	1-1/16"	2-7/16"	5/16"	#10 FH	.30	10 ea

Transom, platforms, rudder and ladder applications.



HAWSE PIPE

Investment Cast 316 Stainless Steel

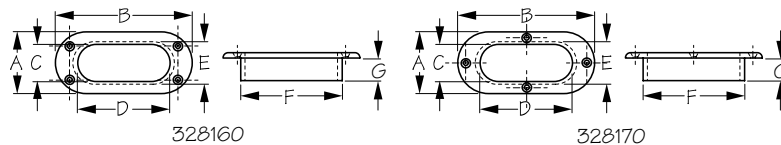

Bulk	Display	A	B	C	D	E	F	G	Wt.(lb.)	Std. Pack
328160	328160-1	2-1/2"	5-1/2"	1-1/2"	3-3/4"	1-3/4"	4-1/8"	15/16"	.76	5 ea
328170	n/a	5-3/16"	9-1/4"	2-7/8"	6-7/8"	3-7/16"	7-1/2"	3/4"	2.23	1 ea

Hawse Pipes are designed to protect the boats hull against damage from anchor line and chain while also reducing rope chafe. Constructed of corrosion resistant investment cast 316 stainless steel. Installs with four FH fasteners (not included).



HAWSE PIPE WITH BACK FLANGE

Investment Cast 316 Stainless Steel

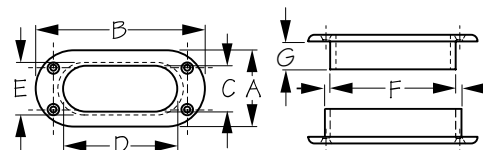

Bulk	Display	A	B	C	D	E	F	G	Wt.(lb.)	Std. Pack
328175	n/a	5-3/4"	9-1/2"	3-1/8"	6-7/8"	3-5/8"	7-1/2" / 7-7/8"	1-1/2"	7.63	5 ea

Hawse Pipes with Back Flanges are designed to protect the boats hull against damage from anchor line and chain while also reducing rope chafe. Back flange provides for a more robust installation. Constructed of corrosion resistant investment cast 316 stainless steel. Installs with eight 1/4" FH fasteners (not included).



TRIANGULAR HAWSE PIPE

Investment Cast 316 Stainless Steel

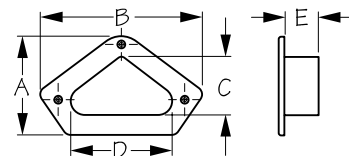

Bulk	Display	A	B	C	D	E	Fastener	Wt.(lb.)	Std. Pack
328180	n/a	4-7/8"	8"	2-13/16"	5"	1-11/16"	#8 FH	1.86	1 ea

Triangular Hawse Pipes are designed to protect the boats hull against damage from anchor line and chain while also reducing rope chafe. Triangular shape make them ideal for bow mounting. Constructed of corrosion resistant investment cast 316 stainless steel. Installs with three #8 FH fasteners (not included).



TELESCOPIC STEP LADDER WITH GUDGEON MOUNT

Formed 304 Stainless Steel

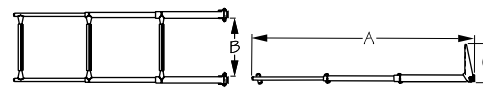

Bulk	Display	A	B	C	Steps	Wt.(lb.)	Std. Pack
328202	n/a	23-3/8"	8-3/4"	7"	2	3.25	1 ea
328203	n/a	34-3/8"	8-3/4"	7"	3	5.80	1 ea

Telescopic Step Ladders with Gudgeon Mounts include a securing strap. Constructed of corrosion resistant formed 304 stainless steel.

TELESCOPIC STEP LADDER WITH HANDLE AND GUDGEON MOUNT

Formed 304 Stainless Steel

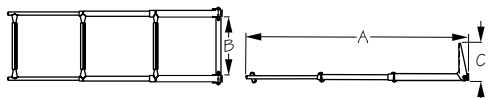

Bulk	Display	A	B	C	Steps	Wt.(lb.)	Std. Pack
328213	n/a	34-3/8"	8-3/4"	7"	3	5.50	1 ea

Telescopic Step Ladders with Gudgeon Mounts have a built in grip handle. Includes securing strap. Constructed of corrosion resistant formed 304 stainless steel.

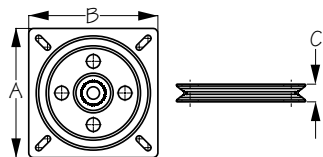

SEAT SWIVEL

Stamped Steel Powder Coated



Bulk	Display	A	B	C	D	E	Fastener	Wt.(lb.)	Std. Pack
328550	n/a	6-1/2"	6-1/2"	5-1/2"	4-3/4"	7/8"	1/4" RH	2.42	1 ea

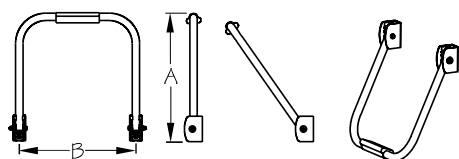

FLIP-UP LADDER - SINGLE STEP

Injection Molding Nylon/304 Stainless Steel



Bulk	Display	A	B	Fastener	Wt.(lb.)	Std. Pack
n/a	328908-1	15-3/8"	13"	1/4" RH	2.32	1 ea

This Flip-Up Ladder features three stationary positions. Constructed of corrosion resistant 304 stainless steel. Installs with 1/4" RH fasteners (not included).

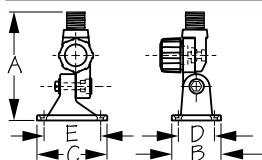

ADJUSTABLE ANTENNA BASE

Injection Molding Nylon



Bulk	Display	A	B	C	D	E	Fastener	Wt.(lb.)	Std. Pack
329100	329100-1	5-5/8"	2-1/2"	3-5/8"	1-7/8"	2-15/16"	1/4" FH	.44	10 ea

This Adjustable Antenna Base features dual swiveling mounts for full adjustability and a control knob for quick and easy adjustment, diminishing the potential of mooring, fishing, or other lines getting fouled on a handle. Designed to feed the antenna wire directly through the base, eliminating the need for a separate cable outlet and reducing potential areas for water leakage. Accepts any standard antenna with 1"-14 threads. Constructed of UV resistant injection molded nylon. Installs with four 1/4" FH fasteners (not included).

▲WARNING: Cancer and Reproductive Harm - www.P65Warnings.ca.gov

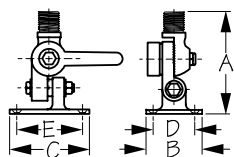

ADJUSTABLE ANTENNA BASE

Injection Molding Nylon



Bulk	Display	A	B	C	D	E	Fastener	Wt.(lb.)	Std. Pack
329130	329130-1	4-3/4"	2-9/16"	3-5/8"	1-13/16"	2-13/16"	1/4" FH	.50	10 ea

This Adjustable Antenna Base features dual swiveling mounts for full adjustability and a ratchet-style handle for side or deck mounting. Accepts any standard antenna with 1"-14 threads. Not recommended for whips over 8' in self-supporting mode. Constructed of UV resistant injection molded nylon. Installs with four 1/4" fasteners (not included).

▲WARNING: Cancer and Reproductive Harm - www.P65Warnings.ca.gov



ADJUSTABLE ANTENNA BASE

Investment Cast 316 Stainless Steel

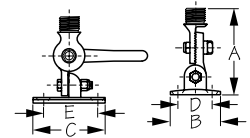

Bulk	Display	A	B	C	D	E	Fastener	Wt.(lb.)	Std. Pack
329230	329230-1	4-1/2"	2-1/2"	3-5/8"	1-13/16"	2-15/16"	1/4" FH	1.48	5 ea
329231	n/a	Gasket Only						.01	5 ea

This Adjustable Antenna Base features dual swiveling mounts for full adjustability and a ratchet-style handle for side or deck mounting. Designed with an integral feed system for Loran cable. Accepts any standard antenna with 1"-14 threads. Constructed of corrosion resistant investment cast 316 stainless steel. Installs with four 1/4" FH fasteners (not included). Optional gasket (329231) sold separately.

⚠WARNING: Cancer and Reproductive Harm - www.P65Warnings.ca.gov



HEAVY DUTY ADJUSTABLE ANTENNA BASE

Investment Cast 316 Stainless Steel

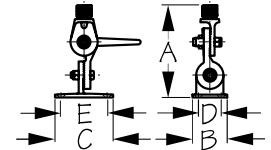

Bulk	Display	A	B	C	D	E	Fastener	Wt.(lb.)	Std. Pack
329235	329235-1	5-15/16"	2-1/4"	3-3/4"	1-1/2"	3"	1/4" FH	1.85	5 ea

A new, heavy duty version of the popular all stainless Adjustable Antenna Base has been enhanced with additional height and weight. For use with over-height whips or where extra strength and rigidity are required. Features dual swiveling mounts for full adjustability and a ratchet-style handle for side or deck mounting. Designed with an integral feed system for Loran cable. Accepts any standard antenna with 1"-14 threads. Constructed of corrosion resistant investment cast 316 stainless steel. Installs with four 1/4" FH fasteners (not included).

⚠WARNING: Cancer and Reproductive Harm - www.P65Warnings.ca.gov



ADJUSTABLE ANTENNA BASE

Die Cast Zinc Chrome Plated

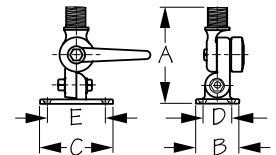

Bulk	Display	A	B	C	D	E	Fastener	Wt.(lb.)	Std. Pack
329300	329300-1	4-3/4"	2-1/8"	3-5/8"	1-7/16"	2-15/16"	1/4" FH	1.40	5 ea

This Adjustable Antenna Base features dual swiveling mounts for full adjustability and a ratchet-style handle for side or deck mounting. Designed with an integral feed system for Loran cable. Accepts any standard antenna with 1"-14 threads. Constructed of chrome plated die cast zinc with mirror finish. Installs with four 1/4" fasteners (not included). Recommended for freshwater use.

⚠WARNING: Cancer and Reproductive Harm - www.P65Warnings.ca.gov



FIXED ANTENNA BASE

Injection Molded Nylon

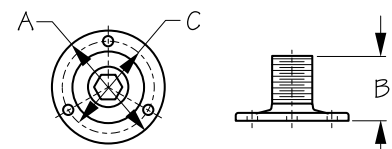

Bulk	Display	A	B	C	Fastener	Wt.(lb.)	Std. Pack
329500	329500-1	2-13/16"	1-9/16"	2-3/16"	1/4" RH	.05	10 ea

This low-profile, flange mount Fixed Antenna Base accepts any standard antenna with 1"-14 threads, but is ideal for GPS, marine TV, and other shorter antennas. Constructed of UV resistant injection molded nylon. Installs with three 1/4" RH fasteners (not included).

⚠WARNING: Cancer and Reproductive Harm - www.P65Warnings.ca.gov

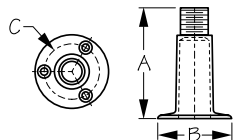

FIXED ANTENNA BASE

Investment Cast 316 Stainless Steel



Bulk	Display	A	B	C	Fastener	Wt.(lb.)	Std. Pack
329510	329510-1	4"	2-7/8"	2-1/8"	1/4" FH	.65	5 ea

This Fixed Antenna Base features a flange mount base with a recess which, when filled with silicone sealant, will form a watertight seal. Designed to allow antenna wire to feed directly through the base, eliminating the need for a separate cable grommet. Accepts any standard antenna with 1"-14 threads, but is ideal for TV, Loran, GPS, VHF antennas, and radar arches. Constructed of corrosion resistant investment cast 316 stainless steel. Installs with three 1/4" FH fasteners (not included).

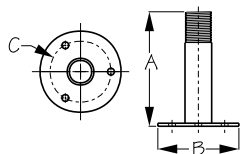

FIXED ANTENNA BASE

Formed 304 Stainless Steel



Bulk	Display	A	B	C	Fastener	Wt.(lb.)	Std. Pack
329515	329515-1	4-1/4"	3"	2-1/4"	1/4" RH	.42	5 ea
329517	329517-1	1-1/2"	3"	2-1/4"	1/4" RH	.27	5 ea

Fixed Antenna Base features a flange mount base. Designed to allow wire to feed directly through the base, eliminating the need for a separate cable grommet. Accepts any standard antenna with 1"-14 threads, but is ideal for TV, Loran, GPS, and VHF antennas. Constructed of corrosion resistant formed 304 stainless steel. Installs with three 1/4" RH fasteners (not included).

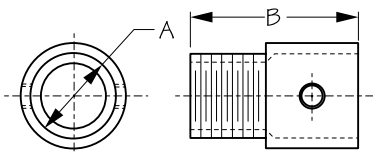

TUBE MOUNT ANTENNA BASE

Investment Cast 316 Stainless Steel



Bulk	Display	A	B	Wt.(lb.)	Std. Pack
329520	329520-1	1"	2"	.28	5 ea

This Tube Mount Antenna Base can be used with any 1" OD stainless tubing, creating custom antenna mounts. When used in conjunction with a stainless steel 90° round base deck fitting, antenna extensions of any length can be made with a full-length passage for coaxial connectors. Accepts any standard antenna with 1"-14 threads. Constructed of corrosion resistant investment cast 316 stainless steel. Attaches to tubing with two 1/4"-28 x 3/16" set screws (included).

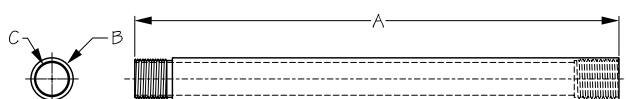

ANTENNA BASE EXTENSION

Machined 304 Stainless Steel Tubing



Bulk	Display	Threads	A	B	C	Wt.(lb.)	Std. Pack
329532	329532-1	1"-14	12"	1-1/16"	13/16"	.97	1 ea
329536	329536-1	1"-14	24"	1-1/16"	13/16"	1.81	1 ea

This Antenna Base Extension features male and female fittings with 1"-14 threads. Constructed of corrosion resistant machined 304 stainless steel tubing. Available in 12" or 24".

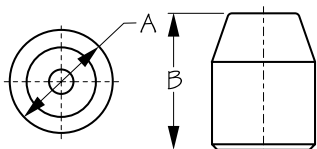

ANTENNA ADAPTER

Injection Molded Delrin



Bulk	Display	A	B	Wt.(lb.)	Std. Pack
n/a	329550-1	1-3/8"	1-13/16"	.08	10 ea

This Antenna Adapter allows the mounting of a 3/8"-24 thread Loran whip onto a standard 1"-14 thread antenna base. Constructed of impact resistant injection molded Delrin for high mechanical strength, rigidity, and electrical insulation.

▲WARNING: Cancer and Reproductive Harm - www.P65Warnings.ca.gov



SWIVEL ANTENNA BASE

Investment Cast 316 Stainless Steel

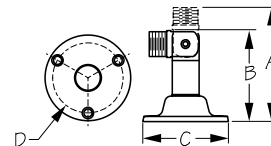

Bulk	Display	A	B	C	D	Fastener	Wt.(lb.)	Std. Pack
329600	329600-1	4-1/2"	3-9/16"	3-3/8"	2-13/16"	#12 FH	1.34	1 ea

This Swivel Antenna Base is designed to be used in conjunction with Antenna Stand Off Bracket (329780). Constructed of corrosion resistant investment cast 316 stainless steel. Installs with three #12 FH fasteners (not included).



ANTENNA CLIP

Injection Molded Rubber

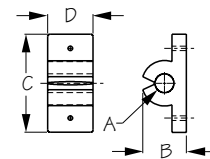

Bulk	Display	A (Antenna Dia.)	B	C	D	Fastener	Wt.(lb.)	Std. Pack
329770	329770-1	5/16" - 3/8"	7/8"	1-7/8"	7/8"	#4 RH	.03 / .06	10 ea / 10 pr
329772	329772-1	5/8" - 3/4"	1-1/8"	2-1/4"	7/8"	#4 RH	.06 / .12	10 ea / 10 pr
329774	329774-1	1" - 1-1/4"	1-1/2"	2-1/2"	7/8"	#4 RH	.08 / .16	10 ea / 10 pr

These Antenna Clips securely hold down antennas when not in use. Can also be used for fishing rods and boat hooks. Constructed of injection molded rubber for high tensile strength and durability. Installs with two #4 RH fasteners (not included).

⚠WARNING: Cancer and Reproductive Harm - www.P65Warnings.ca.gov



ANTENNA STAND OFF BRACKET

Injection Molded Nylon

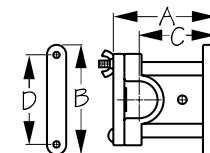

Bulk	Display	A	B	C	D	Wt.(lb.)	Std. Pack
329780	329780-1	4-1/2"	4-13/16"	3-5/16"	3-15/16"	.51	5 ea

This Antenna Stand Off Bracket helps hold and support 1" to 1-1/2" diameter antennas in place while under way. Works great in conjunction with Swivel Tall Antenna Base (329600). Constructed of UV resistant injection molded nylon. Installs with two 1/4" PH fasteners and nuts (included).



LAY DOWN ANTENNA HOOK

Stamped 304 Stainless Steel

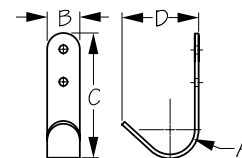

Bulk	Display	A	B	C	D	Fastener	Wt.(lb.)	Std. Pack
329790	329790-1	1-3/4"	1"	3-13/16"	2-3/8"	#12 RH	.19	10 ea

This Lay Down Antenna Hook can also be used for fishing rods, boat hooks, mops, etc. Can function as a coat hook. Constructed of corrosion resistant stamped 304 stainless steel. Installs with two #12 RH fasteners (not included).



COAXIAL CABLE ASSEMBLY

Nickel Plated Brass

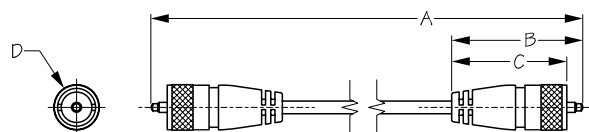

Bulk	Display	A	B	C	D	Wt.(lb.)	Std. Pack
n/a	329800-1	2'	2"	1-3/4"	11/16"	.18	10 ea
n/a	329802-1	5'	2"	1-3/4"	11/16"	.30	10 ea
n/a	329804-1	10'	2"	1-3/4"	11/16"	.50	10 ea
n/a	329806-1	20'	2"	1-3/4"	11/16"	.90	10 ea
n/a	329808-1	50'	2"	1-3/4"	11/16"	2.10	10 ea

Coaxial Cable Assembly features a RG-58U Coax cable pre-assembled with PL-259 fittings on both ends for quick installation of hardware. Constructed of nickel plated brass.

⚠WARNING: Cancer and Reproductive Harm - www.P65Warnings.ca.gov

MALE UHF CONNECTOR & REDUCERS FOR 8U CABLE

Nickel Plated Brass

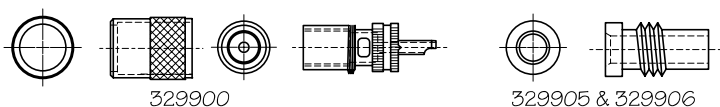

Bulk	Display	Description	Wt.(lb.)	Std. Pack
329900	329900-1	Male UHF Connector; PL-259; For U/C cable, adapter type	.03	10 ea
n/a	329901-1	A Combination of part number 329900 and 329905 for RG-58/U Cable	.04	10 ea
n/a	329902-1	A Combination of part number 329900 and 329906 for RG-59/U Cable	.04	10 ea
329905	329905-1	Reducer -UG175U for RG-58/U Cable; use with 329900	.01	10 ea
329906	329906-1	Reducer -UG176U for RG-59/U Cable; use with 329900	.01	10 ea

Male UHF Connectors & Reducers for use in 8U coaxial cable installation applications. Constructed of nickel plated brass for salt spray resistance and electrical conductivity.

▲WARNING: Cancer and Reproductive Harm - www.P65Warnings.ca.gov

UHF/BNC & UHF/TNC HANDHELD RADIO CABLE ADAPTER

Nickel Plated Brass

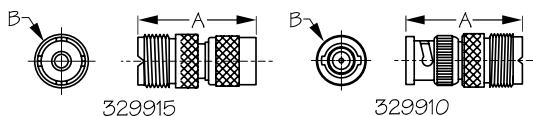

Bulk	Display	Description	A	B	Wt.(lb.)	Std. Pack
329910	329910-1	UHF/BNC	1-5/16"	5/8"	.04	10 ea
329915	329915-1	UHF/TNC (not pictured)	1-3/8"	5/8"	.05	10 ea

These Handheld Radio Cable Adapters enable handheld VHF to use larger VHF antennas. UHF/TNC adapter is used on most Standard Horizon® and ICOM® models. Check radio manual for details. Constructed of nickel plated brass for salt spray resistance and electrical conductivity.

▲WARNING: Cancer and Reproductive Harm - www.P65Warnings.ca.gov

BNC MALE CONNECTOR-RG58/U CABLE

Nickel Plated Brass

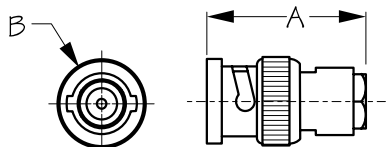

Bulk	Display	A	B	Wt.(lb.)	Std. Pack
329913	329913-1	1"	9/16"	.02	10 ea

This BNC Male Connector is a miniature, quick connect/disconnect, radio frequency connector used for RG58/U coaxial cable. Constructed of nickel plated brass for salt spray resistance and electrical conductivity.

▲WARNING: Cancer and Reproductive Harm - www.P65Warnings.ca.gov

DOUBLE FEMALE UHF CABLE CONNECTOR

Nickel Plated Brass

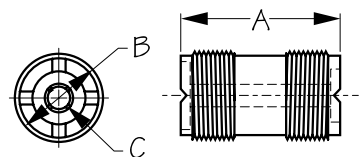

Bulk	Display	A	B	C	Wt.(lb.)	Std. Pack
329950	329950-1	1-1/8"	9/16"	1/8"	.02	10 ea

Double Female UHF Cable Connector for connecting two PL-259 male connectors. Constructed of nickel plated brass for salt spray resistance and electrical conductivity. Not recommended for through bulkhead applications.

▲WARNING: Cancer and Reproductive Harm - www.P65Warnings.ca.gov

DOUBLE FEMALE BULKHEAD CABLE CONNECTOR

Nickel Plated Brass

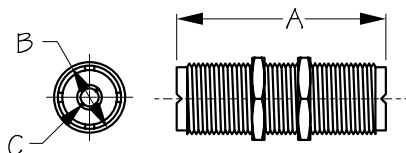

Bulk	Display	A	B	C	Wt.(lb.)	Std. Pack
329951	329951-1	1-13/16"	5/8"	1/8"	.08	10 ea

Double Female Bulkhead UHF Cable Connector for connecting two PL-259 male connectors through a bulkhead. Constructed of nickel plated brass for salt spray resistance and electrical conductivity.

▲WARNING: Cancer and Reproductive Harm - www.P65Warnings.ca.gov



DOUBLE MALE CABLE CONNECTOR

Nickel Plated Brass

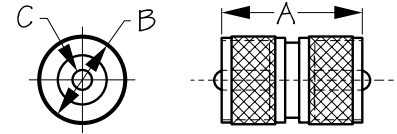

Bulk	Display	A	B	C	Wt.(lb.)	Std. Pack
329953	329953-1	1-1/4"	11/16"	1/8"	.04	10 ea

Double Male Cable Connector for connecting two SO-239 female connectors. Constructed of nickel plated brass for salt spray resistance and electrical conductivity.

⚠WARNING: Cancer and Reproductive Harm - www.P65Warnings.ca.gov



UHF RIGHT ANGLE CABLE CONNECTOR

Nickel Plated Brass

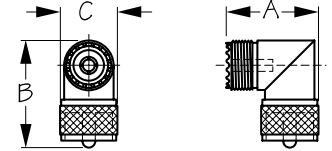

Bulk	Display	A	B	C	Wt.(lb.)	Std. Pack
329955	329955-1	1-1/8"	1-5/16"	11/16"	.06	10 ea

UHF Right Angle Cable Connector features a 90° elbow that turns the connecting wire at the back of a set, allowing radios to sit closer to a back wall or bulkhead. Constructed of nickel plated brass for salt spray resistance and electrical conductivity.

⚠WARNING: Cancer and Reproductive Harm - www.P65Warnings.ca.gov



UHF T-ADAPTER CABLE CONNECTOR

Nickel Plated Brass

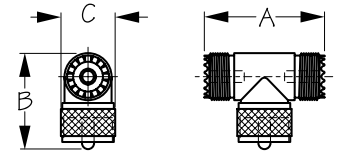

Bulk	Display	A	B	C	Wt.(lb.)	Std. Pack
329957	329957-1	1-9/16"	1-1/4"	11/16"	.07	10 ea

UHF T-Adapter Cable Connector allows for the connection of two male PL-259 and one female SO-239 connectors. Constructed of nickel plated brass for salt spray resistance and electrical conductivity.

⚠WARNING: Cancer and Reproductive Harm - www.P65Warnings.ca.gov



UHF CABLE CAP & CHAIN

Nickel Plated Brass

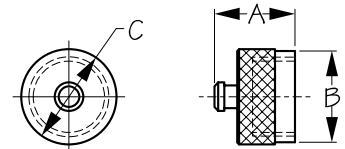

Bulk	Display	A	B	C	Wt.(lb.)	Std. Pack
329970	329970-1	1 1/16"	3/4"	13/16"	.03	10 ea

UHF Cable Cap & Chain protects UHF connectors from the elements when not in use, preventing signal degradation due to corrosion or debris. Constructed of nickel plated brass for salt spray resistance.

⚠WARNING: Cancer and Reproductive Harm - www.P65Warnings.ca.gov



MICROPHONE CLIP

Stamped 304 Stainless Steel

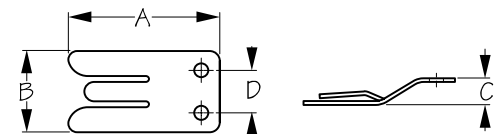

Bulk	Display	A	B	C	D	Wt.(lb.)	Std. Pack
329990	329990-1	1-7/8"	1"	3/8"	1/2"	.02	10 ea

This one-piece Microphone Clip secures your microphone close to your radio. Fits all standard microphones for hailers, VHF, or CB radios. Constructed of corrosion resistant stamped 304 stainless steel. Installs with two RH fasteners (not included).